

# SKYPARK INDUSTRIAL CENTRAL

31947 CORYDON ROAD, UNIT 180, LAKE ELSINORE, CA 92530

+/- 1,604 SF INDUSTRIAL  
SPACE FOR LEASE



**FOR MORE INFORMATION, PLEASE CONTACT:**

**CAREY PASTOR** | Senior Vice President

(951) 297-7434 | [cpastor@cbsocalgroup.com](mailto:cpastor@cbsocalgroup.com)

CalDRE License # 01403298



**COLDWELL BANKER  
COMMERCIAL**  
SC

# SKYPARK INDUSTRIAL CENTRAL

31947 CORYDON ROAD, UNIT 180, LAKE ELSINORE, CA 92530

+/- 1,604 SF INDUSTRIAL  
SPACE FOR LEASE



## PROPERTY HIGHLIGHTS

- 1,604 SF Industrial space available
- Industrial & Auto uses allowed
- 200 Amp, 120/208v, 3 phase power supply per unit
- M-1 Zoning, City of Lake Elsinore
- No NNN or CAM fees
- Landlord pays trash and water

# SKYPARK INDUSTRIAL CENTRAL

31947 CORYDON ROAD, UNIT 180, LAKE ELSINORE, CA 92530

**+/- 1,604 SF INDUSTRIAL SPACE FOR LEASE**

## AVAILABILITY

UNIT	UNIT SIZE	MONTHLY LEASE RATE	DESCRIPTION
130	±1,604 SF	\$2,566.00 Per month	Reception area, 1 private office, restroom and warehouse. 10x10 GL roll up door and man door

Rental Rates are Industrial Gross - No CAM or NNN Fees

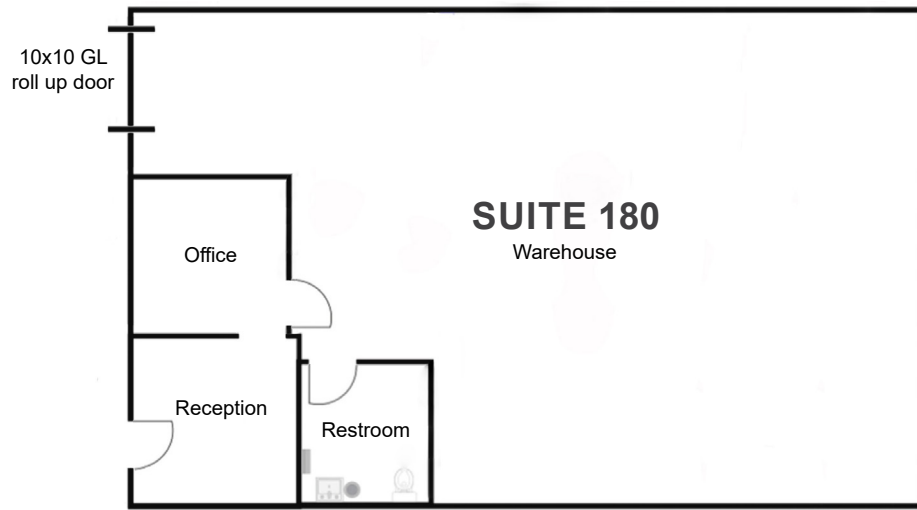

\*Not to scale

## SITE PLAN

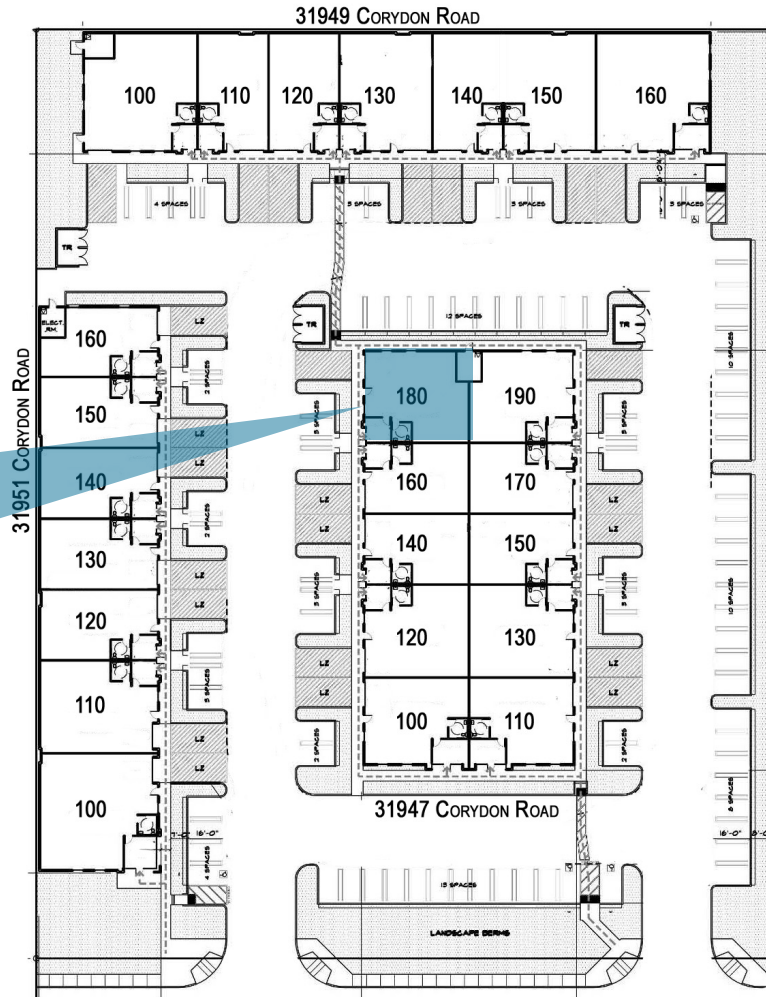

CORYDON ROAD

# SKYPARK INDUSTRIAL CENTRAL

31947 CORYDON ROAD, UNIT 180, LAKE ELSINORE, CA 92530

+/- 1,604 SF INDUSTRIAL SPACE FOR LEASE



# SKYPARK INDUSTRIAL CENTRAL

31947 CORYDON ROAD, UNIT 180, LAKE ELSINORE, CA 92530

+/- 1,604 SF INDUSTRIAL SPACE FOR LEASE



Coldwell Banker Commercial and the Coldwell Banker Commercial Logo are registered service marks licensed to Coldwell Banker Commercial Affiliates. Each Office is Independently Owned and Operated. All information contained herein has been obtained from sources deemed reliable. However, no warranty or guarantee is made as to the accuracy of the information.

CalDRE License # 02089395

# SKYPARK INDUSTRIAL CENTRAL

31947 CORYDON ROAD, UNIT 180, LAKE ELSINORE, CA 92530

+/- 1,604 SF INDUSTRIAL  
SPACE FOR LEASE



**FOR MORE INFORMATION, PLEASE CONTACT:**

**CAREY PASTOR**

Senior Vice President

951.297.7434

[cpastor@cbcsocalgroup.com](mailto:cpastor@cbcsocalgroup.com)

CalDRE # 01403298

27368 Via Industria | Suite 102  
Temecula | California | 92590  
t 951.200.7683 | f 951.239.3147  
[cbcsocalgroup.com](http://cbcsocalgroup.com)



**COLDWELL BANKER  
COMMERCIAL**

SC