

186,519 SF  
CLASS-A  
WAREHOUSE  
AVAILABLE  
NOW



# ORANGE LOGISTICS CENTER

Building 1 | 186,519 SF

759 North Eckhoff Street, Orange, CA 92868

[www.idilogistics.com](http://www.idilogistics.com)

 **IDI Logistics**

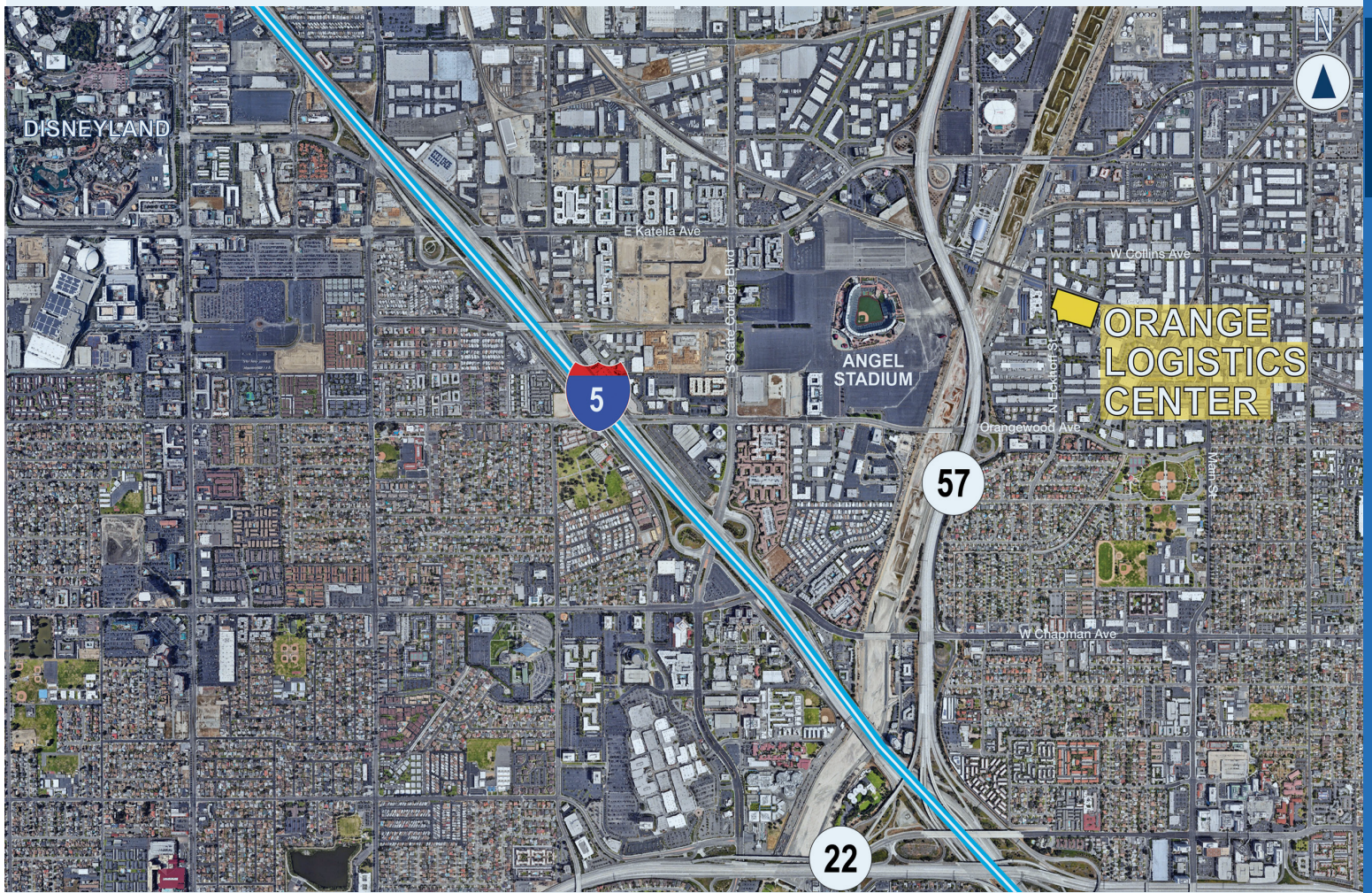

Orange Logistics Center, Building 1 will offer up to 186,519 square feet of state-of-the-art industrial space located near the intersection of N. Eckhoff Street and W. Orangewood Avenue in Orange, CA - approximately 1.5 miles from I-5.



#### PARK FEATURES

- Abundant labor force
- Close amenities
- Controlled LED exterior lighting
- Energy efficient building
- No assessment bond encumbrances
- Affordable housing in region
- Excellent transportation infrastructure

# 186,519 available square feet

SITE AREA: 8.24 acres

SPEC OFFICE: 6,490 SF

CLEAR HEIGHT: 36'

## Ideal for Local and Regional Distribution

DOCKS:	25 (9' x 10')
DRIVE-IN DOORS:	2 (12' x 14')
AUTO PARKING:	138 spaces
TRAILER PARKING:	40 stalls
COLUMN SPACING:	56' x 60'
TRUCK COURT:	130'
FIRE SPRINKLER:	ESFR (k-25)

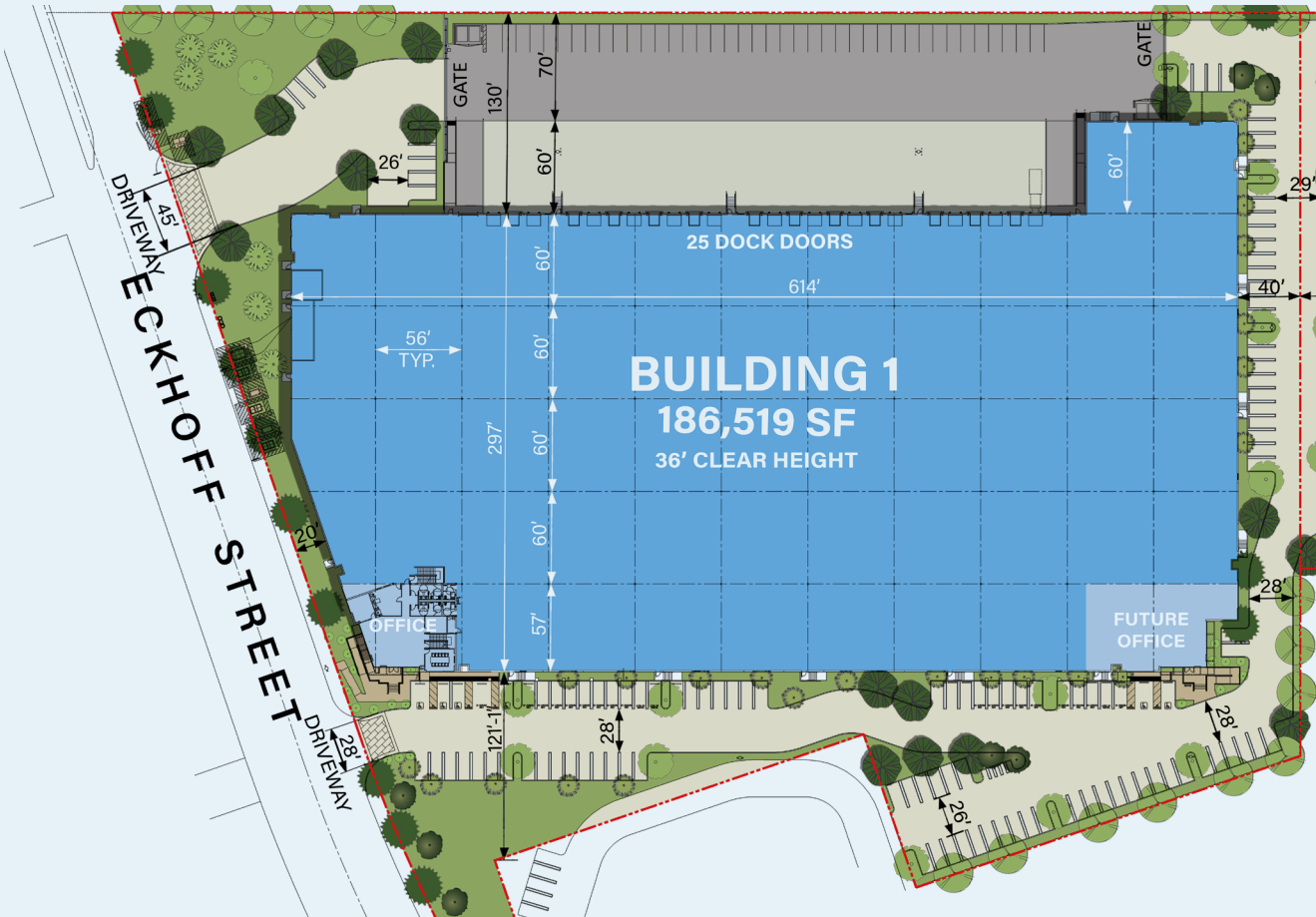

# DRIVING DISTANCES

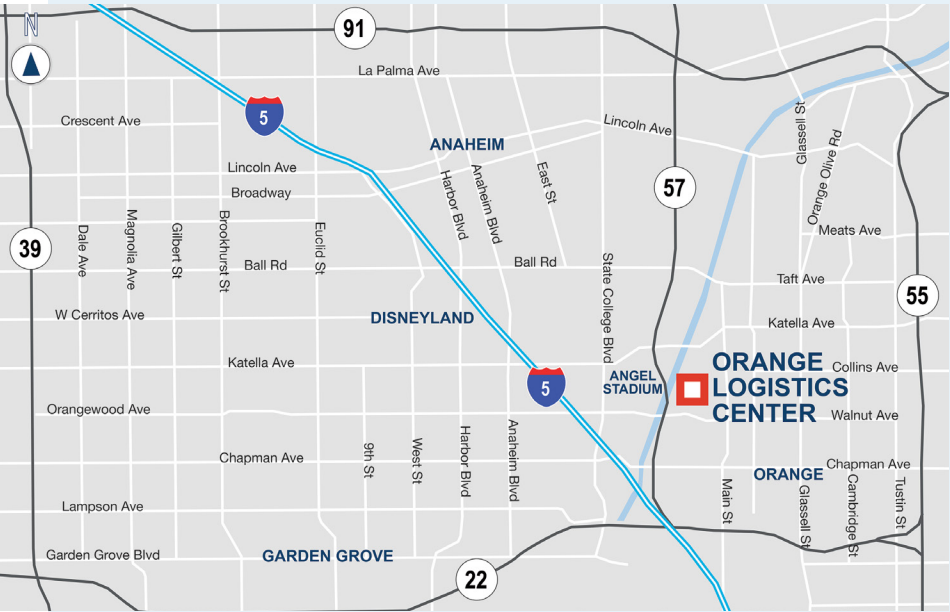

### METRO AREA

Anaheim .....	5.5 miles
Long Beach.....	20 miles
Los Angeles .....	30 miles
San Diego .....	92 miles

### INTERSTATE

Highway 57 .....	0.5 miles
I-5 .....	1.5 miles
Highway 39 .....	8 miles
Highway 90 .....	9 miles
I-605 .....	14 miles
I-10 .....	20 miles
I-405 .....	22 miles

### AIR

John Wayne Airport.....	11 miles
Ontario Int'l Airport.....	35 miles
LAX.....	38 miles



For more information, or to set up a tour, please contact:



**Allen Buchanan, SIOR**  
 +1.714.564.7104  
 abuchanan@lee-associates.com  
 RE Lic. #00870947

**Bill Heim**  
 +1.909.373.2901  
 bheim@lee-assoc.com  
 RE Lic. #00776174

**Charlie McPhee**  
 +1.213.334.4801  
 charlie.mcphee@idilogistics.com

**Brandon Dickens**  
 +1.714.915.7678  
 brandon.dickens@idilogistics.com