



PRESENTED BY

The Lake Plaza

Warren Tsang
Senior Associate
951-283-1888
DRE #01993434
wtsang@mgrrealestate.com

Maximilian Tsang
Associate
909-539-5055
DRE #02244101
maxtsang@mgrrealestate.com

31715 Riverside Dr., Lake Elsinore CA 92530 is a small retail unit:

Asking: \$1.50 + \$0.50 NNN = \$2,110.00/month

- 1,055 Sq. Ft
- 1 restroom
- Central HVAC
- Perfect buildout for Coffee/Ice cream shop
- Existing service counter
- Ample Parking



COMMERCIAL | RESIDENTIAL | PROPERTY MANAGEMENT

ONTARIO COSTA MESA VICTORVILLE RANCHO MIRAGE CARLSBAD IRVINE

(800) 777-7647 mgrrealestate.com DRE #01841921

All items on this page are deemed to be accurate, but should be viewed as reference only. MGR Real Estate, Inc. does not warranty/guaranty the validity of any information on this page.



31715 Riverside Dr., Lake Elsinore, CA, 92530
1,055 RSF
(Not to Scale)

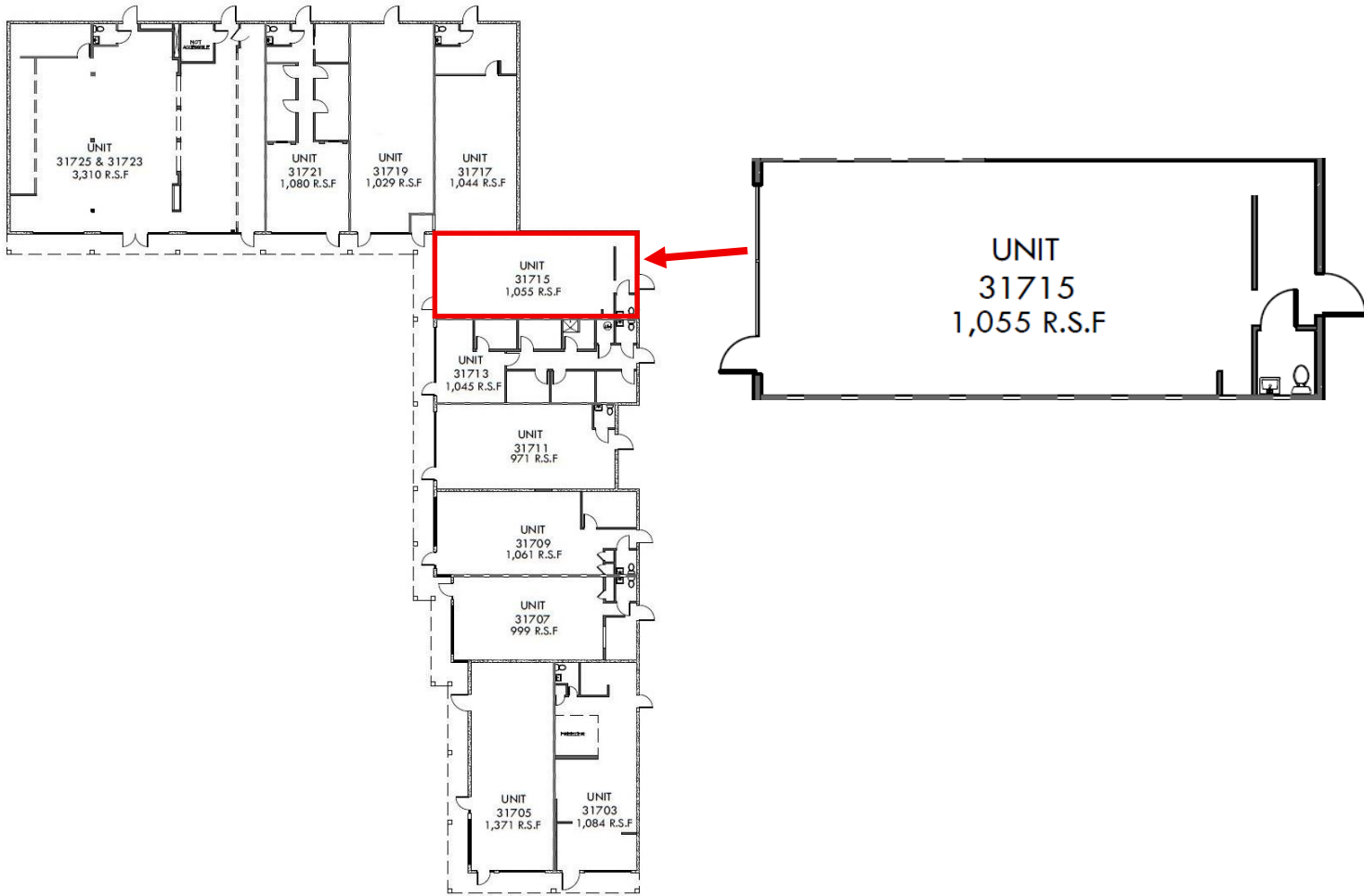

For more information, contact:	
Warren Tsang Senior Associate DRE#01993434 Direct: 951-283-1888	Max Tsang Commercial Associate Lic. #02244101 Direct: 909-539-5055

*All items on this page are deemed to be correct but should be viewed as reference only. MGR Real Estate, Inc. does not warranty/guaranty the validity of any information on this page.

MGR Real Estate Inc. 3800 Concourse Street, Suite 350, California 91764 | Office: 909-981-4466 / Fax: 909-981-6267