

FOR LEASE

540 PATRICE PLACE

GARDENA, CA 90248

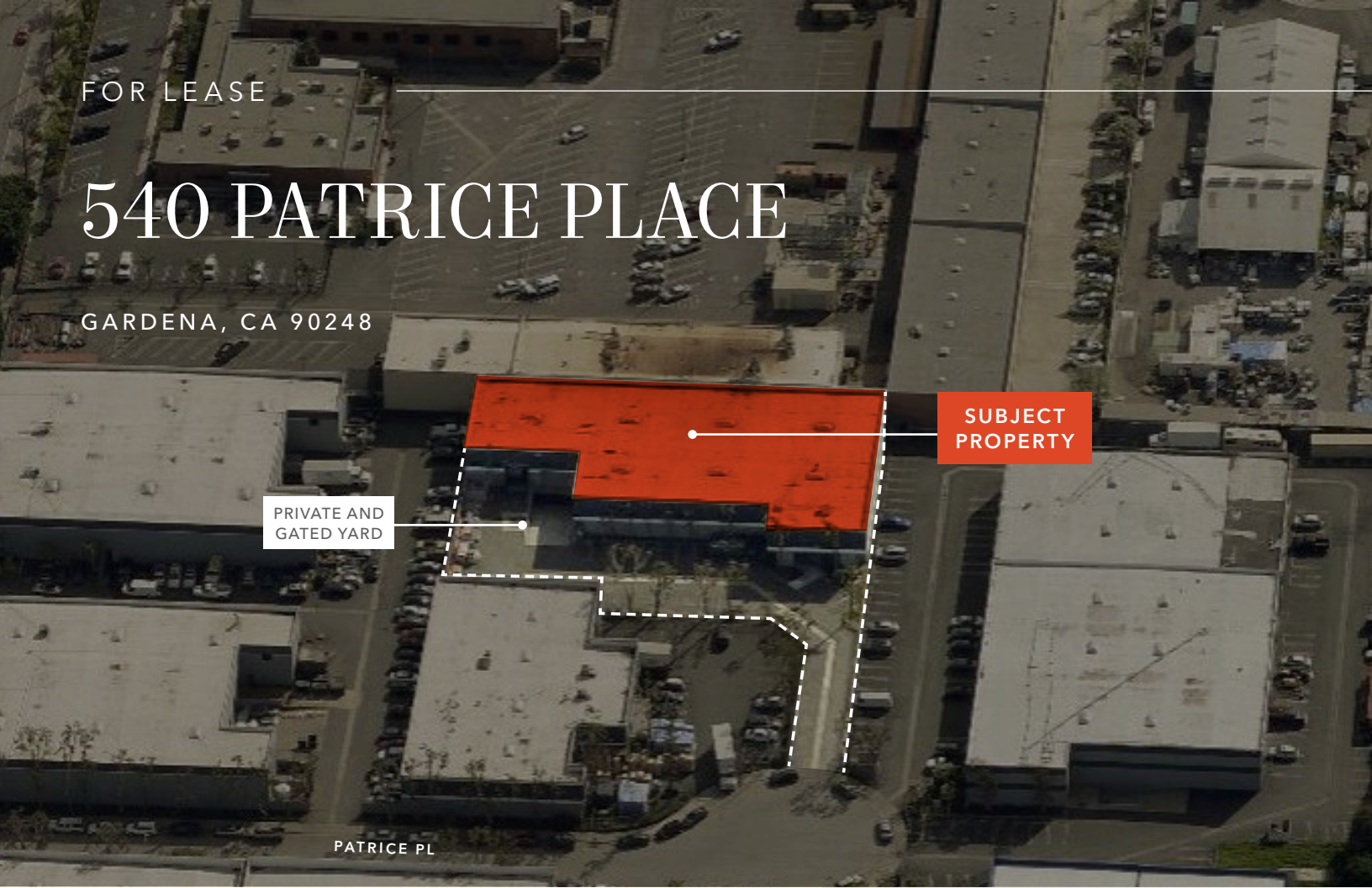

SUBJECT
PROPERTY

PRIVATE AND
GATED YARD

PATRICE PL

A 18,250 SF warehouse with 1,500 SF of office space, on 37,026 SF of land. Available for immediate occupancy.

Built in 1979 | CTU free-standing construction

Private and gated yard

2 dock-high loading positions/1 grade level door

400 amps, 120-208 volts, 3 PH

19' minimum clear height

24 parking spaces

\$1.30

PSF GROSS

\$0.05

PSF CAM

3-5

YEAR TERM

*Tours by appointment
only please contact
to schedule*

IAN STEVENSON

310.906.3277

ian.stevenson@kidder.com

LIC N°02045140

KIDDER.COM

This information supplied herein is from sources we deem reliable. It is provided without any representation, warranty, or guarantee, expressed or implied as to its accuracy. Prospective Buyer or Tenant should conduct an independent investigation and verification of all matters deemed to be material, including, but not limited to, statements of income and expenses. Consult your attorney, accountant, or other professional advisor.

km Kidder
Mathews

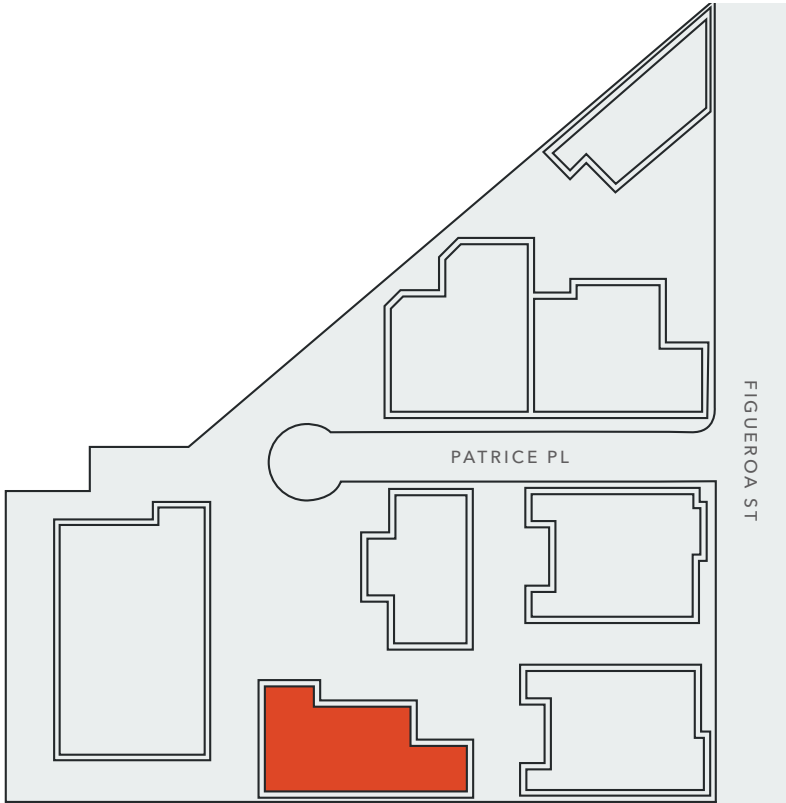

18,250 SF

WAREHOUSE

1,500 SF

OFFICE SPACE

37,026 SF

LAND SF

