

17 KING ST E 2ND & 3RD FLOOR OSHAWA

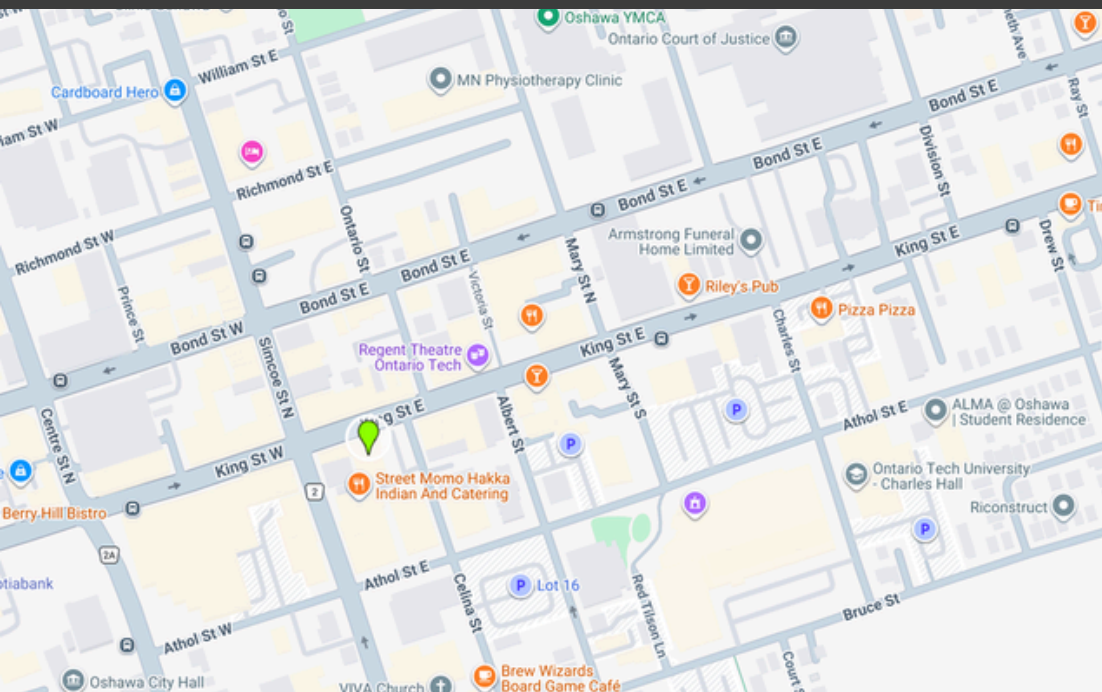

INCREDIBLE DOWNTOWN LOCATION | WALKABLE AMENITIES



Walkable Amenities

- University Campus
- Tribute Centre
- Ontario Court of Justice
- Banks
- Regent Theatre
- Oshawa Convention Centre
- Condo Residences
- Minutes to 401

DOWNTOWN OSHAWA



CONTACT

RYAN BELMONTE, ABR
President & Broker of Record
Belmonte Real Estate Brokerage
905-240-5001
belmonterealestate@gmail.com



17 KING ST E 2ND & 3RD FLOOR OSHAWA

2ND FLOOR PLAN

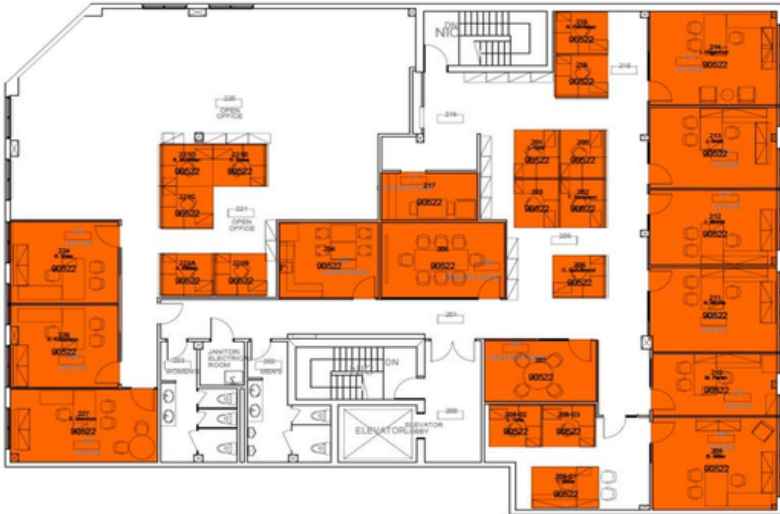

3RD FLOOR PLAN

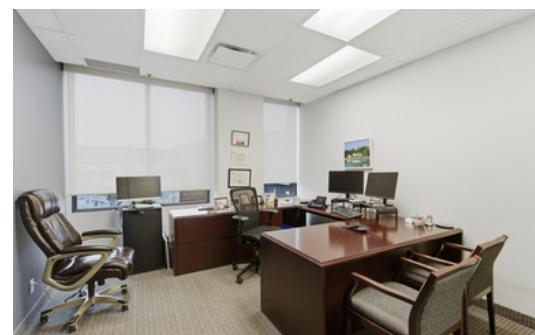
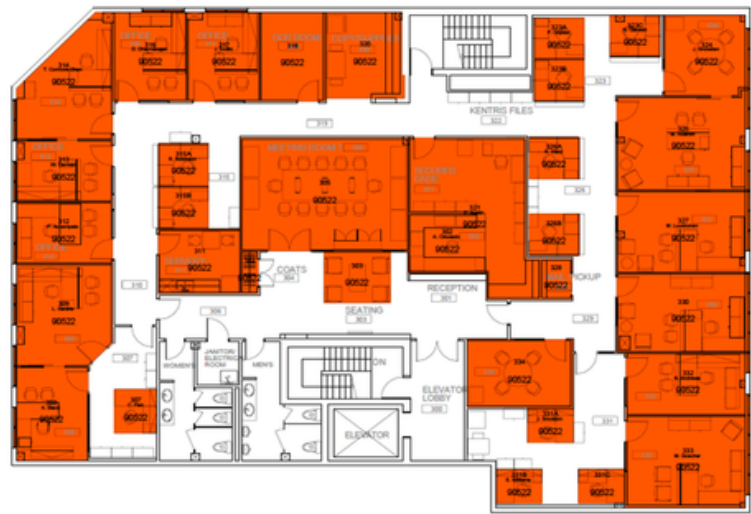

CONTACT

RYAN BELMONTE, ABR
 President & Broker of Record
 Belmonte Real Estate Brokerage
 905-240-5001
 belmonterealestate@gmail.com



For Lease \$16 Sq Ft Net

Move-In Ready - Exclusive Professional Office Suites In A Prominent Downtown Oshawa Location. This Space Is turnkey and Ideal For Professional Office Users looking for a Professionally Finished Office Suite. The suites are approximately 7,000 SF per floor with elevator access featuring lobby, reception, private offices, boardrooms, lunch rooms, His/Hers Bathrooms, Large Parking Lot etc.

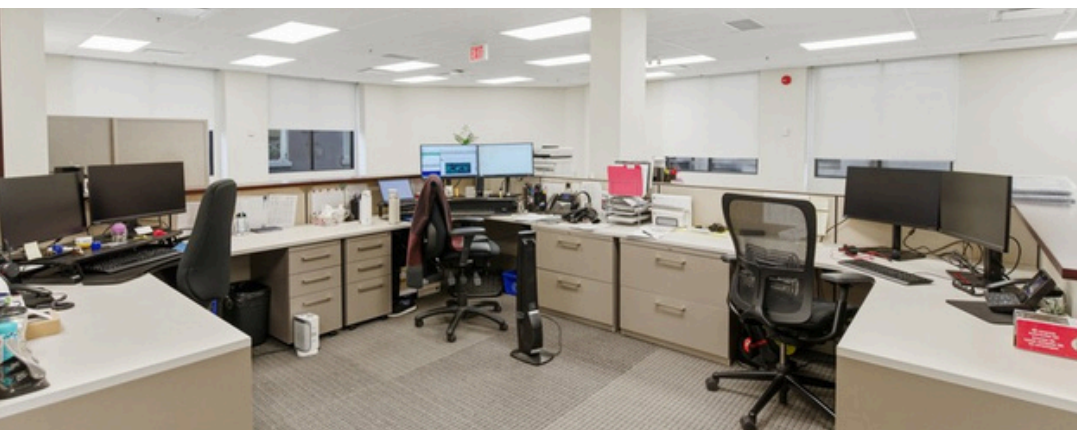

17

KING STREET EAST
2ND & 3RD FLOOR

CONTACT

RYAN BELMONTE, ABR
President & Broker of Record
Belmonte Real Estate Brokerage
905-240-5001
belmonterealestate@gmail.com



▪ Residential ▪ Commercial ▪ Investment

