

FOR SUBLEASE

CBRE



#1501 & 1505-700 W PENDER STREET
Vancouver, BC

JOHN MEGAN

Personal Real Estate Corporation

Senior Vice President

CBRE Limited | Advisory and Transaction Services

604 662 5111

john.megan@cbre.com

FOR SUBLEASE

Unlock a rare furnished partial-floor sublease at 700 West Pender in Vancouver's core. Enjoy flexible layouts, modern amenities, and abundant natural light, all designed to support growth and elevate your business. Steps away from two SkyTrain Stations and plenty of downtown conveniences, this space offers the perfect balance of prestige and functionality.



OFFICE (SUITE 1501)



LOUNGE AREA (SUITE 1501)

PROPERTY DETAILS

| | |
|------------------------|--|
| SUITE | 1501 & 1505 |
| SIZE | #1501: 6,836 sq. ft. #1505: 2,597 sq. ft. Total: 9,433 sq. ft. |
| ASKING RENT | Contact Listing Agent |
| ADDITIONAL RENT | \$26.27 per sq. ft. (2026 est.) |
| AVAILABILITY | September 2026 |
| EXPIRY DATE | April 29, 2029 |
| PARKING | Reserved: @ \$395.00 per month (plus taxes) Unreserved: @ \$285.00 per month (plus taxes) |



BOARDROOM (SUITE 1501)



KITCHEN AREA (SUITE 1505)

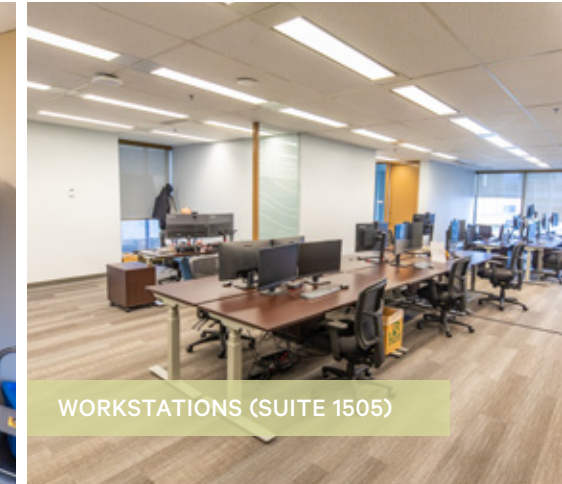

WORKSTATIONS (SUITE 1505)

FLOOR PLAN

Not to scale

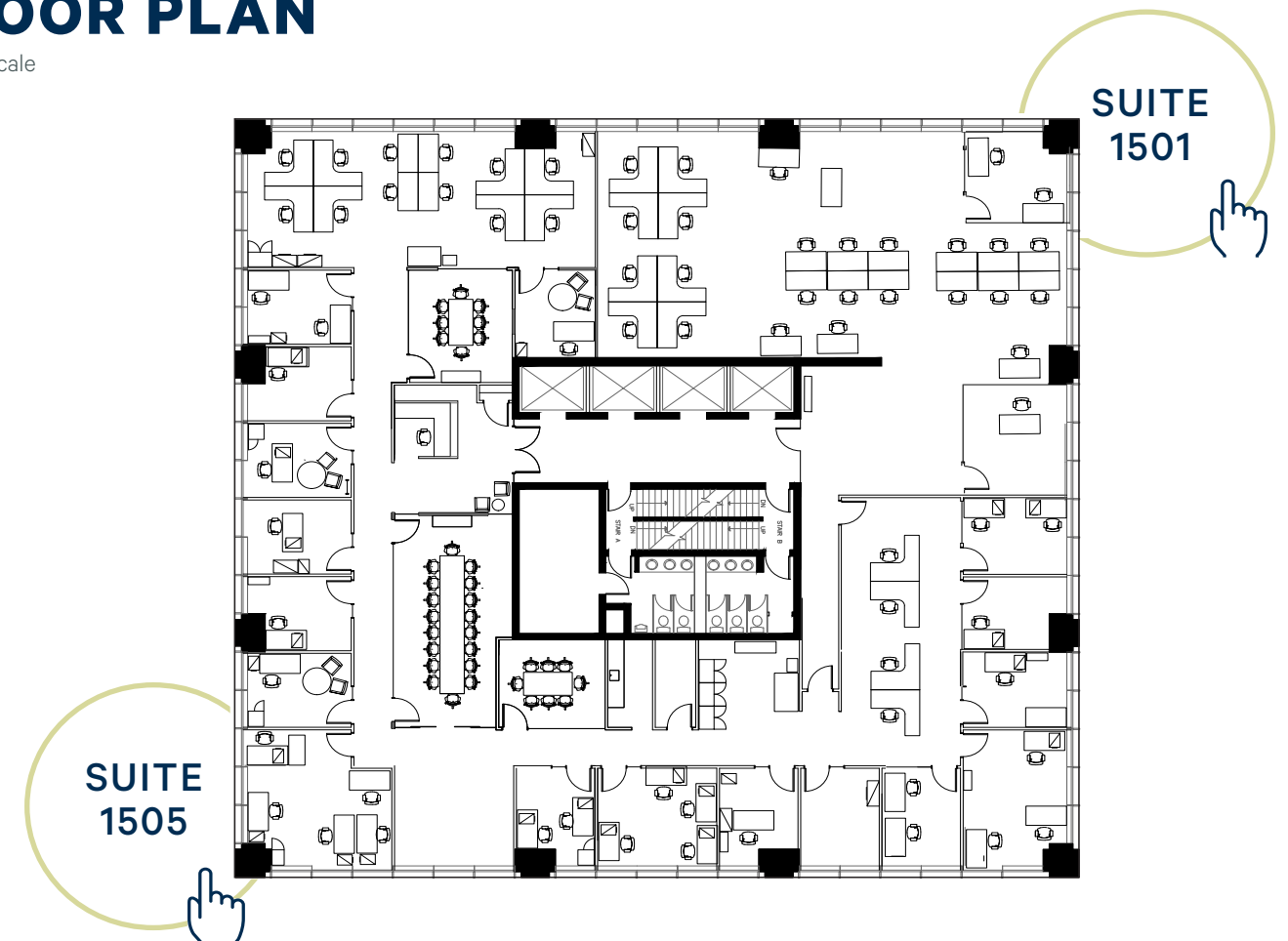

OFFICES
Seventeen (17)



BOARDROOM
Two (2)



LOUNGE AREA



WORKSTATIONS
Forty (40)



KITCHEN AREA
Two (2)

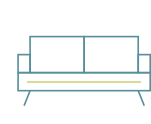

FURNISHED
Inventory Available
[Click here to View](#)



NEIGHBOURHOOD STATS

5KM RADIUS

● Restaurants ● Retail ● Coffee Shops



100
Transit Score



80
Bike Score



98
Walk Score

CONTACT

JOHN MEGAN

Personal Real Estate Corporation

Senior Vice President

CBRE Limited | Advisory and Transaction Services

604 662 5111

john.megan@cbre.com



This disclaimer shall apply to CBRE Limited, Real Estate Brokerage, and to all other divisions of the Corporation; to include all employees and independent contractors ("CBRE"). All references to CBRE Limited herein shall be deemed to include CBRE, Inc. The information set out herein, including, without limitation, any projections, images, opinions, assumptions and estimates obtained from third parties (the "Information") has not been verified by CBRE, and CBRE does not represent, warrant or guarantee the accuracy, correctness and completeness of the Information. CBRE does not accept or assume any responsibility or liability, direct or consequential, for the Information or the recipient's reliance upon the Information. The recipient of the Information should take such steps as the recipient may deem necessary to verify the Information prior to placing any reliance upon the Information. The Information may change and any property described in the Information may be withdrawn from the market at any time without notice or obligation to the recipient from CBRE. CBRE and the CBRE logo are the service marks of CBRE Limited and/or its affiliated or related companies in other countries. All other marks displayed on this document are the property of their respective owners. All Rights Reserved.

Mapping Sources: Canadian Mapping Services canadamapping@cbre.com; DMTI Spatial, Environics Analytics, Microsoft Bing, Google Earth.