

# DOCK MANAGER'S COURTYARD

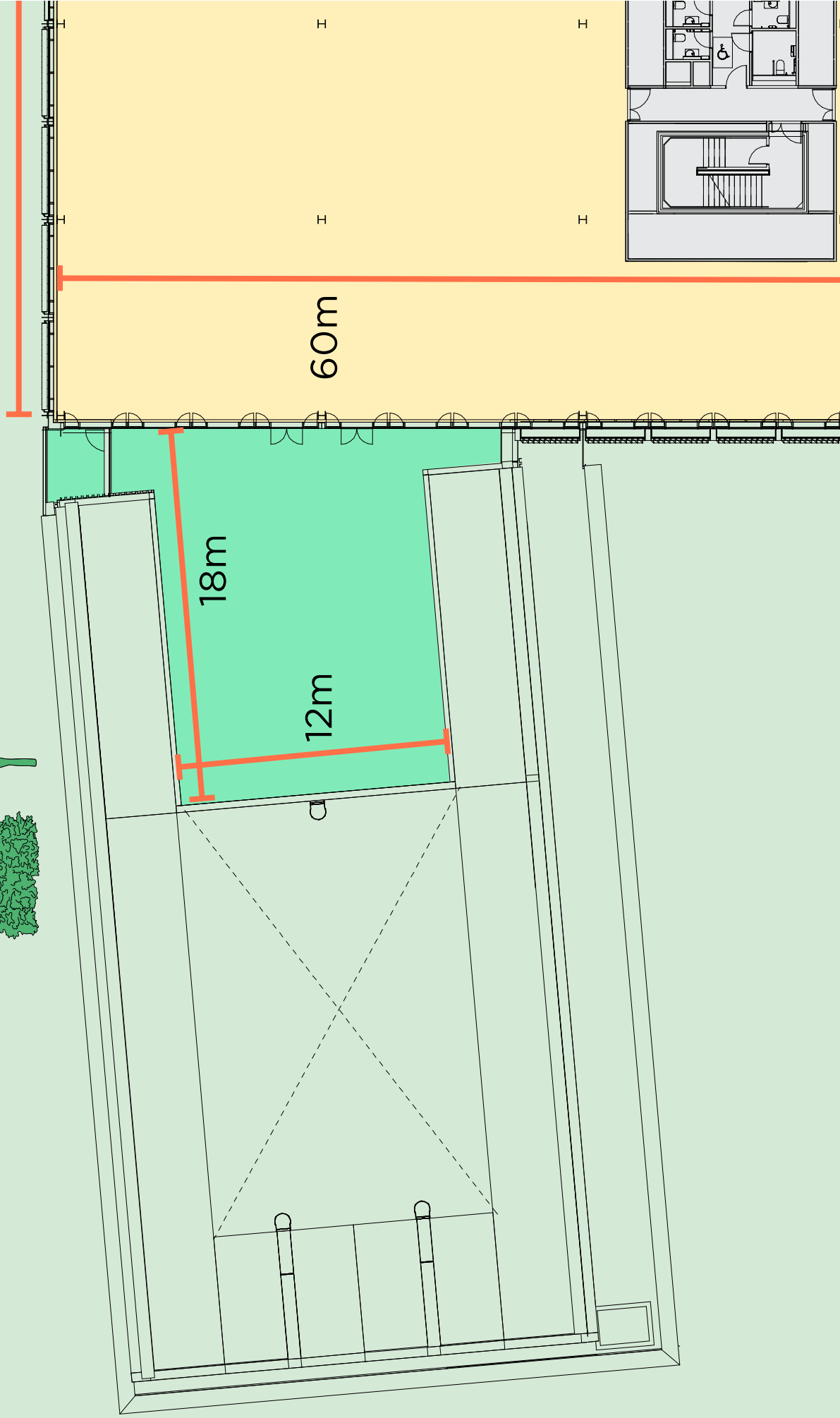

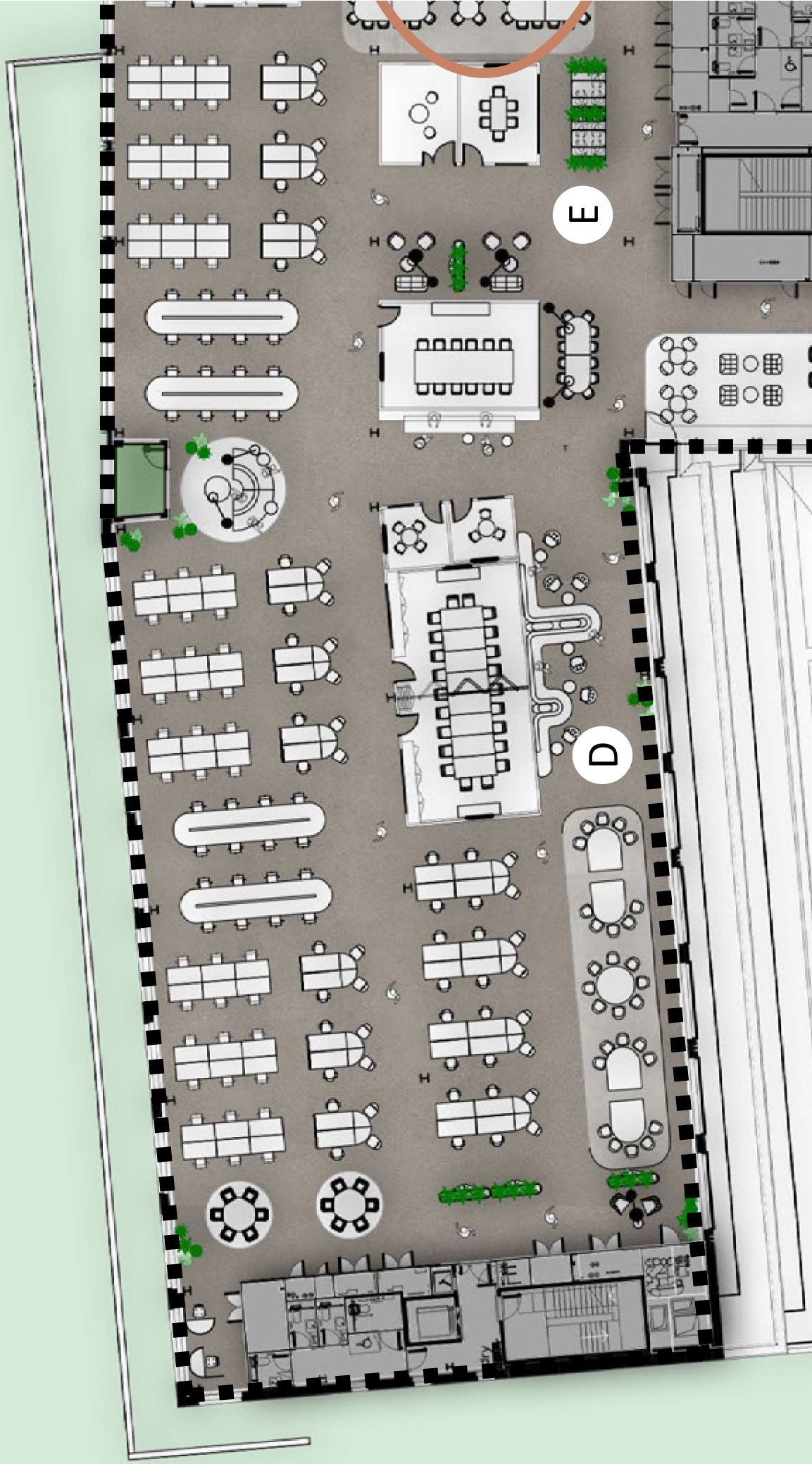







Canada Water

Canada Water

**And this is just the beginning...**

**Over the next 10 years, Canada Water will be transformed into London's next great place with 53 acres of incredible natural landscape, a new high street, and a waterside neighbourhood larger than Covent Garden.**

**53**

of historic

**3,0**

carbon neu

Transforma

**20**

**5**

Canada Water

# Designed for growth



The breadth and scale of Canda Water empowers businesses to plan long

Canada Water



Canada Water

---



# Contract

**Mike Wiseman**  
**Head of Workspace Leasing**  
**& Science and Technology**  
michael.wiseman@britishland.com



**Rory Paton**  
rory.paton@jll.com  
07900 245221



**Ab**  
abb  
0782