

# MSC

9.748 SF FORMER CVS AVAILABLE FOR SUBLEASE

WASHINGTON SQUARE WEST  
PHILADELPHIA, PA



11TH AND  
SOUTH STREETS

# 11<sup>TH</sup> AND SOUTH STREETS



## PROPERTY DETAILS

- ▶ 9,748 SF corner retail at 11th and South Streets
- ▶ Three-level public parking garage above ground floor retail
- ▶ Dense residential community with strong national co-tenancy

## DEMOGRAPHICS

EST. POPULATION  
1 mi 100,754  
3 mi 471,058

EST. AVERAGE HH INCOME  
1 mi \$113,405  
3 mi \$85,498

## JOIN NEIGHBORING TENANTS





# FLOOR PLAN

**SOUTH STREET**

**IITH STREET**

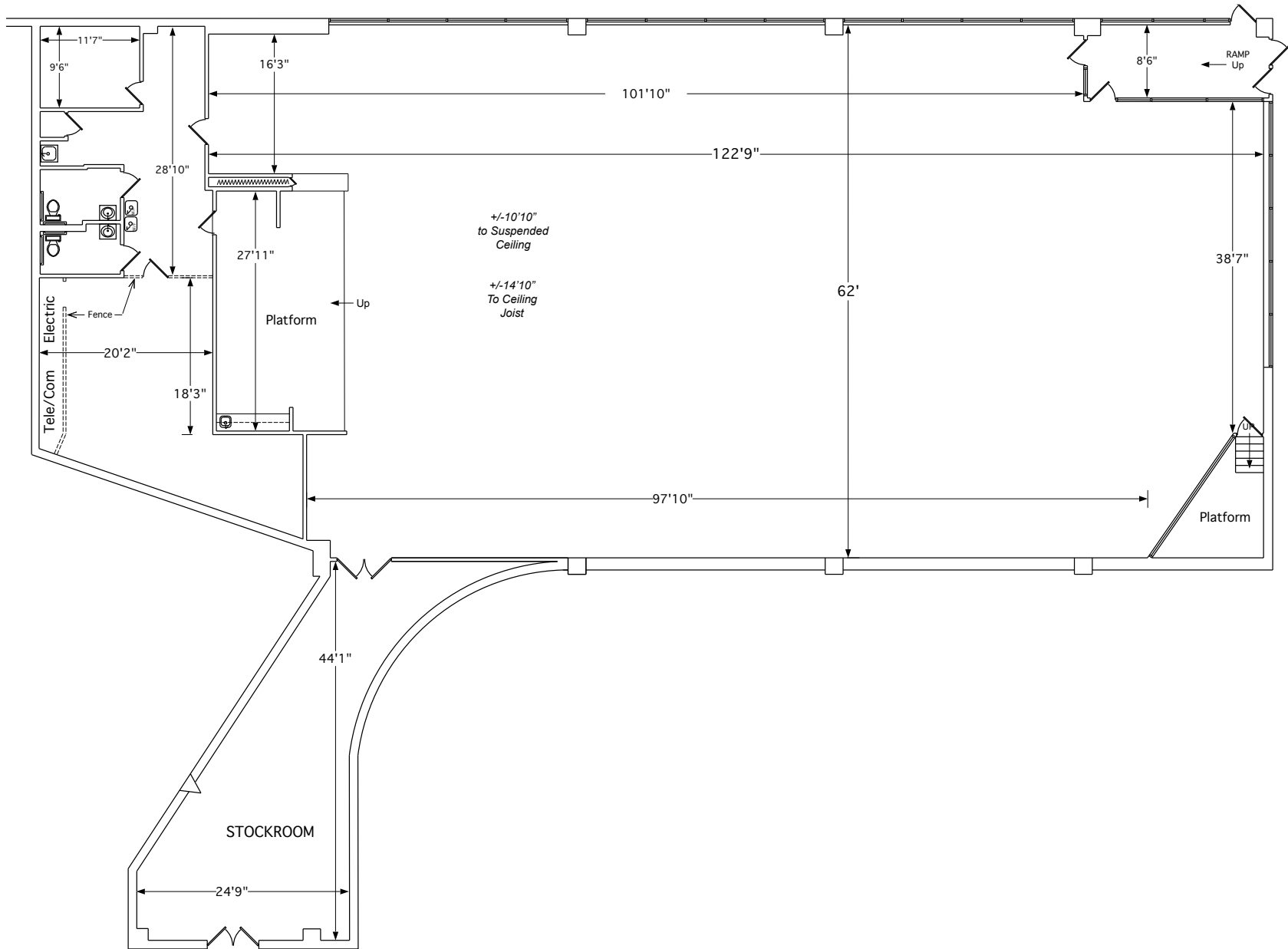

# AERIAL

15TH STREET

BROAD STREET

13TH STREET

12TH STREET

11TH STREET

10TH STREET

9TH STREET

8TH STREET

7TH STREET

6TH STREET

5TH STREET

SOUTH STREET

BAINBRIDGE STREET

FITZWATER STREET

CATHARINE STREET

CHRISTIAN STREET

CARPENTER STREET

WASHINGTON AVENUE

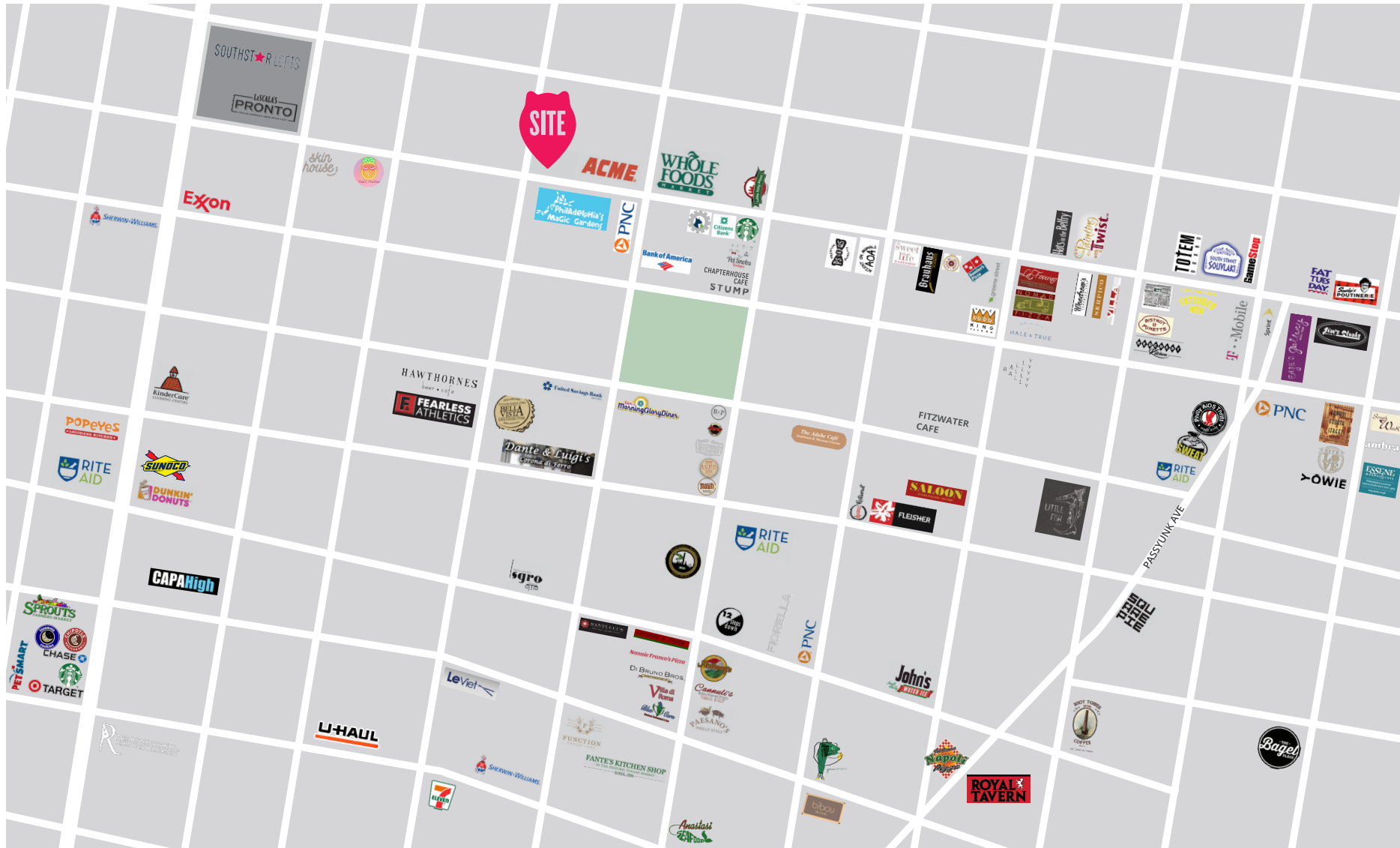



# MSC

**JON KIESERMAN**

[jkieserman@hellomsc.com](mailto:jkieserman@hellomsc.com)

215.883.7377