

FOR LEASE

PACIFIC BEACH RETAIL/OFFICE

4426 - 4440 INGRAHAM STREET, SAN DIEGO, CA 92109



PROJECT HIGHLIGHTS

- 750 SF Available
- Located in Prime Pacific Beach Location!
- Just 8 Blocks to the Beach
- Centrally Located Between Grand and Garnet
- Unmatched Walkability to Amenities
- Excellent Access to I-8 and I-5
- Rare Parking Onsite!



TODD SIMONSEN
Sales Associate
Todd@caacre.com
DRE Lic # 02131564

MIKE CONGER
Principal
Mike@caacre.com
DRE Lic # 01381193

BRIAN JENKINS
Principal
Brian@caacre.com
DRE Lic # 01814828

858.360.3000 | caacre.com

FOR LEASE

PACIFIC BEACH RETAIL/OFFICE

4426 - 4440 INGRAHAM STREET, SAN DIEGO, CA 92109



SUITE 4428

- 750 SF
- 2nd Generation Yoga Studio
- Reception Area
- Private Restroom
- Back Door

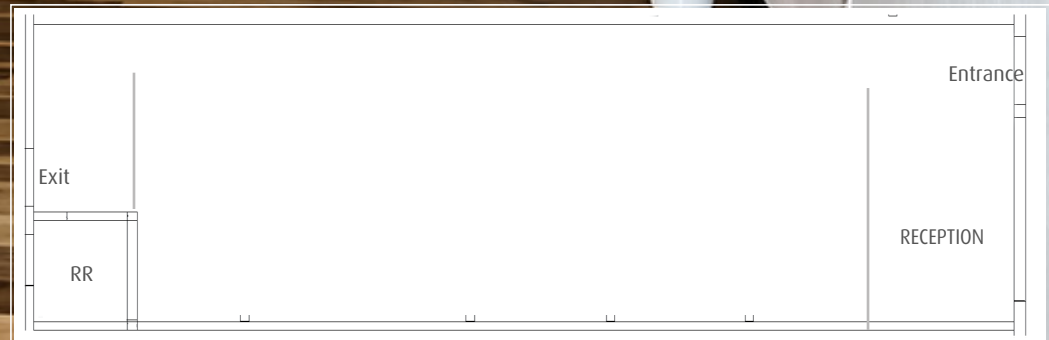

Not to scale, for illustrative purpose only.



858.360.3000 | caacre.com

FOR LEASE

PACIFIC BEACH RETAIL/OFFICE

4426 - 4440 INGRAHAM STREET, SAN DIEGO, CA 92109

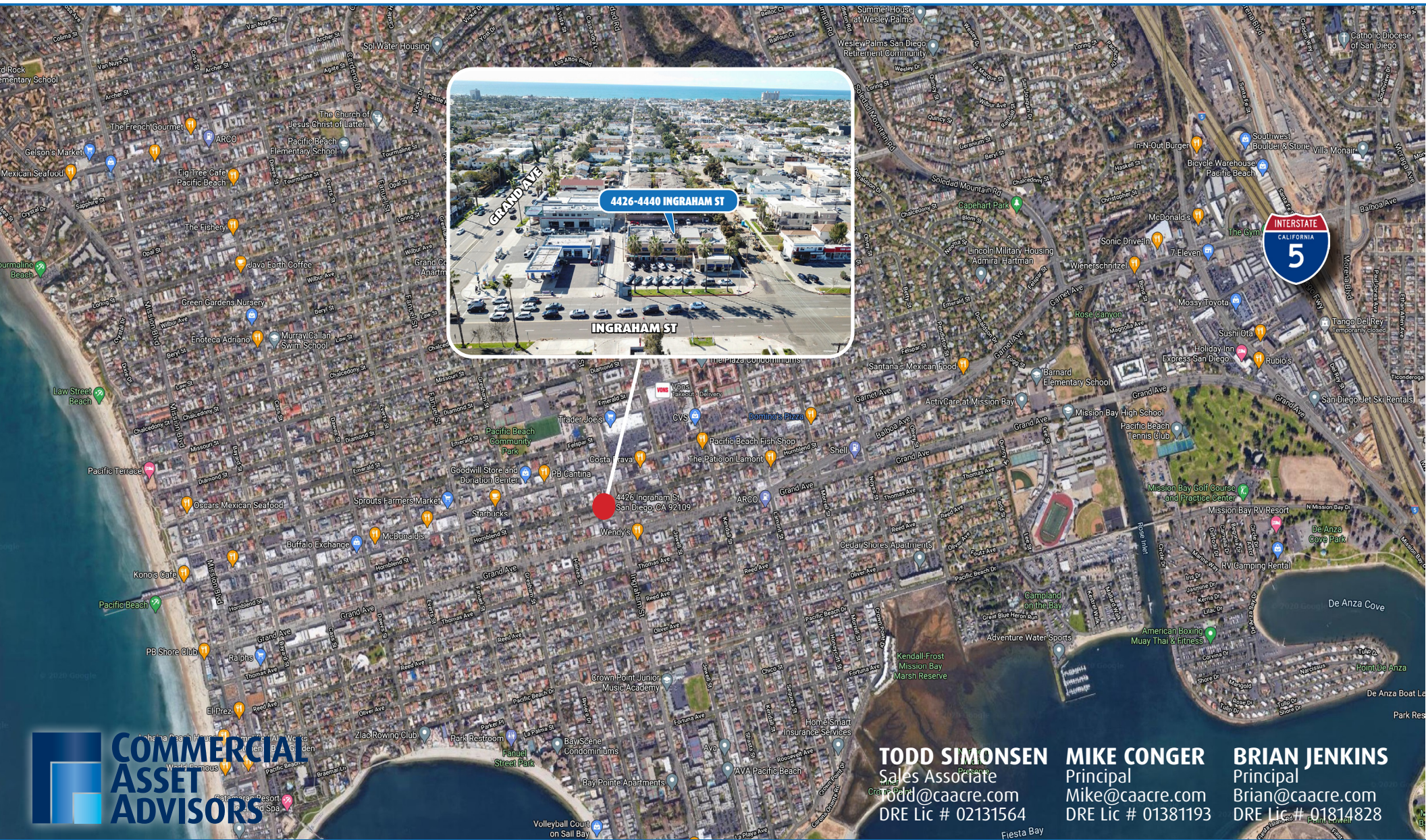

COMMERCIAL ASSET ADVISORS

TODD SIMONSEN
Sales Associate
todd@caacre.com
DRE Lic # 02131564

MIKE CONGER
Principal
Mike@caacre.com
DRE Lic # 01381193

BRIAN JENKINS
Principal
Brian@caacre.com
DRE Lic # 01814828

858.360.3000 | caacre.com

This information above was obtained from sources deemed reliable. No warranties or representations, expressed or implied, are made as to the accuracy of the information contained herein, and same is submitted subject to errors, omissions, change of price, rental or other conditions, withdrawal without notice, and to any special listing conditions imposed by our principals. This information is given with the understanding that all negotiations relating to the purchase, renting or leasing of the property described herein shall be conducted through Commercial Asset Advisors.