

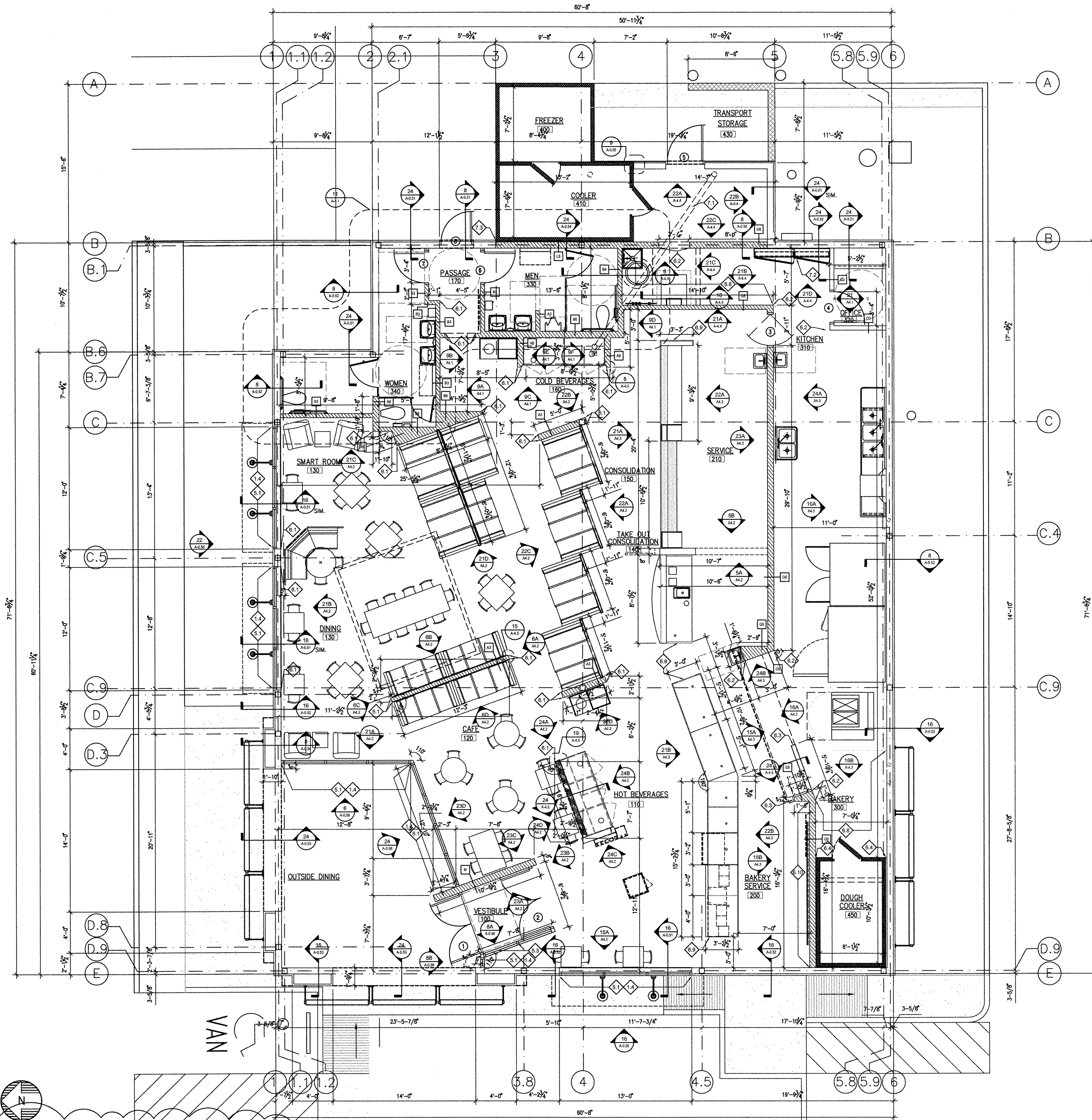

FLOOR PLAN - DIMENSION & KEYNOTE

SCALE: 3/16"=1'-0"



GENERAL NOTES:

- A. PROVIDE 1" AIR SPACE AT SIDE(S) OF OVEN/PROOFER & COOLER/FREEZER (MIN. 3" AT BACK OF OVEN). VERIFY ALL DIMENSIONS & SPECS W/ EQUIPMENT MANUAL. NO FINISH ON WALLS BEHIND OVEN/PROOFER AND COOLER/FREEZER (TAPE & PRIME ONLY).
- B. OFFICE AREA TO INCLUDE THE FOLLOWING (SUPPLIED & INSTALLED BY GC): ROUGH-INS FOR PHONE, ALARM, SOUND, & MICROS SYSTEMS. SEE ELECTRICAL SHEETS; 2'-0" X CUSTOM LENGTH PLASTIC LAMINATE WHITE DESK TOP CLEATED TO WALL, W/ (2) 2" DIA. GROMMETS; (3) 16" DEEP PLASTIC LAMINATE WHITE SHELVES MOUNTED ON HEAVY-DUTY KV STANDARDS WITH ADJUSTABLE BRACKETS.
- C. G.C. TO PROVIDE BLOCKING FOR SUPPORT OF RESTROOM ACCESSORIES AS RECOMMENDED BY MANUFACTURER. SEE INTERIOR ELEVATIONS.
- D. PROVIDE 5/8" CEMENT BACKING BOARD ON ALL KITCHEN & RESTROOM AND OFFICE WALLS FLOOR TO 2'-0" A.F.F.
- E. PROVIDE 5/8" FIRE-TREATED PLYWOOD BACKING BOARD ON ALL KITCHEN & OFFICE WALLS (2'-0" AFF TO CEILING).
- F. OCCUPANCY LOAD SIGN SUPPLIED & INSTALLED BY G.C.
- G. G.C. SHALL SUPPLY & INSTALL RECESSED FIRE EXTINGUISHERS AS REQUIRED BY LOCAL CODES. LOCATION PER LOCAL CODES.
- H. REFERENCE THE FOLLOWING SHEETS: G-SL GENERAL CONDITIONS & PLAN SYMBOLS AND G-ADA ACCESSIBILITY GUIDELINES
- J. ALL DIMENSIONS NOTED ARE FROM FACE OF DRYWALL TO FACE OF DRYWALL.
- K. BOOTH/BANQUETTE SEATING SUPPLIED BY FURNITURE SUPPLIER, INSTALLED BY G.C. BASES TO COVER FLOOR TRANSITIONS. SEE EQUIPMENT PLAN FOR FABRICS AND SIZES. GC TO APPLY VINYL BASE TO ALL TOE KICKS UPON INSTALLATION.
- L. ELECTRICAL EQUIPMENT BY GC. SEE ELECTRICAL DRAWINGS.
- M. PLUMBING EQUIPMENT BY GC. SEE PLUMBING DRAWINGS.
- N. G.C. TO PROVIDE & INSTALL 1/2" CLEAR SAFETY GLASS AT FIREPLACE SCREEN & SNEEZE GUARDS. VERIFY SIZE OF GLASS W/ FIREPLACE POSTS & SNEEZE GUARD POST.
- P. PROVIDE LAP JOINTS WITH FACTORY FINISHED EDGE AT CAFE LIMESTONE WALL.

- 1.1 NOT USED
- 1.2 L.L. SHALL PROVIDE & INSTALL 1" BLACK INSULATED SPANDREL GLASS WITHIN STOREFRONT AS INDICATED.
- 1.3 SOLID SURFACE SILL PROVIDED BY CASEWORK SUPPLIER, INSTALLED BY GC. DIMENSIONS TO BE FIELD VERIFIED.
- 1.4 ROLLER SHADES OR MINI BLINDS TO BE INSTALLED - FULL LENGTH OF WINDOW OPENING. SEE FINISH NOTES FOR SPECIFICATION.
- 1.5 NAPOLEON BGNV40 GAS FIREPLACE. SEE DETAIL SHEET FOR DIMENSIONS AND SPECIFICATION.
- 1.6 G.C. SHALL SUPPLY & INSTALL CLOSET SHELVING AS INDICATED. REFERENCE ELEVATION ON A-4 SERIES SHEET).
- 1.7 RECESSED PHONE BOX PROVIDED BY CASEWORK CO, INSTALLED BY GC. SEE DETAIL SHEET A-4.4.
- STOREFRONT:
- 5.1 GC TO PROVIDE CLEAR ANOD. ALUM. FRAME W/ 1" INSULATED GLASS STOREFRONT (CLEAR GLASS). SEE ELEVATIONS FOR TEMPERED GLASS LOCATIONS (OR AS REQUIRED BY CODE).
- 5.2 LL TO PROVIDE CLEAR ANOD. ALUM. FRAME W/ 1" INSULATED GLASS STOREFRONT (CLEAR GLASS). SEE ELEVATIONS FOR TEMPERED GLASS LOCATIONS (OR AS REQUIRED BY CODE).
- 5.3 GC TO PROVIDE CLEAR ANOD. ALUM. FRAME/SINGLE-PANE GLASS VESTIBULE. SEE INTERIOR ELEVATIONS FOR TEMPERED GLASS LOCATIONS (OR AS REQ'D BY CODE).
- 5.4 LL TO PROVIDE CLEAR ANOD. ALUM. FRAME/SINGLE-PANE GLASS VESTIBULE. SEE INTERIOR ELEVATIONS FOR TEMPERED GLASS LOCATIONS (OR AS REQ'D BY CODE).
- WALLS/EQUIPMENT/PROTECTION:
- 6.1 1" CLEAR ACRYLIC CORNER GUARD FROM BASE TO 8'-0" A.F.F. (SUPPLIED & INSTALLED BY G.C.) PROVIDE ON ALL OUTSIDE CORNERS IN PUBLIC AREAS OF THE CAFE. CORNER GUARDS ARE TO BE MECHANICALLY FASTENED W/ SATIN ALUM BRADS AS REQUIRED.
- 6.2 STAINLESS STEEL CORNER GUARD (16 GA - 1 1/2" RETURNS). INSTALL OVER TILE FROM FLOOR TO 8'-0" A.F.F. B.O.H. 7'-0" F.O.H. OR UNDERSIDE OF BULKHEAD/ ARCH. (SUPPLIED & INSTALLED BY G.C.) STOP QUARRY TILE BASE @ BACK EDGE OF CORNER GUARD W/ BULL NOSE EDGE
- 6.3 STAINLESS STEEL END CAP (16 GA - 1 1/2" RETURNS). INSTALL OVER TILE FROM FLOOR TO 8'-0" A.F.F. B.O.H. 7'-0" F.O.H. OR UNDERSIDE OF BULKHEAD/ ARCH. (SUPPLIED & INSTALLED BY G.C.) STOP QUARRY TILE BASE @ BACK EDGE OF CORNER GUARD W/ BULL NOSE ED STAINLESS STEEL CLOSURE PLATE (16GA) FROM FLOOR TO CEILING OR BOTTOM OF BULKHEAD. (SUPPLIED & INSTALLED BY GC)
- 6.4 STAINLESS STEEL CLOSURE PLATE (16GA) FROM FLOOR TO CEILING OR BOTTOM OF BULKHEAD. (SUPPLIED & INSTALLED BY G.C.)
- 6.5 INSTALL VERTICAL BULLNOSE TILE @ FINISH TRANSITION BETWEEN TILE/PAINT/VWC. SEE SHEET A-2.3 FOR TILE FINISH.
- 6.6 1 1/2" ALUMINUM ANGLE SET AT FLOOR TO PROTECT EQUIPMENT/FIXTURE/ PIPING.
- 6.7 1 1/2" DIA. PIPE RAIL TO PROTECT EQUIPMENT/PLUMBING FIXTURE. TOP AT 2'-0" A.F.F. SECURE BASE PLATE TO FLOOR WITH 3/8" DIA. EXPANSION ANCHORS. SEE DETAIL SHEET (NOT USED).
- 6.8 1" BOSTON-BUMPER GUARDS INSTALLED @ 30" & 60" AT ALL EXPOSED WALLS IN BACK OF HOUSE, SEE INTERIOR ELEV. REFER TO MATERIAL & FINISH LEGEND FOR SPEC.
- 6.9 BLACK BOSTON-BUMPER PROTECTION @ CASEWORK, 12" & 30" AFF
- 6.10 B1 BOSTON BUMPER GUARDS @ 18" AND 36" AFF.
- UTILITIES:
- 7.1 6" PVC SODA CONDUIT LINE BY GC BELOW/ABOVE SLAB, FROM BAG-N-BOX TO SODA MACHINE WITH SWEEPS, SEE EQUIPMENT AND PLUMBING DWGS.
- 7.2 CPI PANEL, HEAD/BASE DETAIL INDICATED ON DETAIL SHEETS.
- 7.3 CONTINUOUS BACKER ROD AND SEALANT AT THIS LOCATION.

KEYED NOTES:

INDICATED BY SYMBOL

BAKERY CAFE:

#1240
SYSTEM: G2 (WARM)
PHOTO/TYPE UPDATE: 2008-08

MEP ENGINEER:
HEIGHTS VENTURE ARCHITECTS, LLP
JAMES F. TURNER ENGINEERS, LLC
ENGINEER:
JIM TURNER
8330 MEADOW ROAD,
SUITE 202
DALLAS, TX 75231
PHONE: 214-750-3800
FAX: 214-750-2902

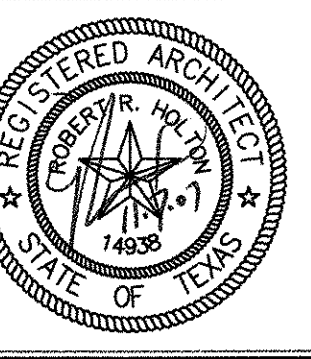

BAKERY CAFE #1240
1409 NORTH COLLINS ST.
ARLINGTON, TX 76001



REVISION	DATE	DESCRIPTION
1	11-07-07	ISSUE FOR CONST. SET

ISSUE DATE: 11-07-07
HVA PROJECT NUMBER: 07029
DRAWN BY: STEPHANIE GROSS
DPM: LUCY SHORE
DM: DAVID MACHINCAO
CM: TONY DISANZA

SHEET NO:

A-2.1

SHELL FLOOR PLAN
DIMENSIONS, KEYNOTES
FILE: 1240-A-2.1.dwg