



±16,731 SF Industrial Space Available

1400 Enterprise Boulevard, West Sacramento, CA

Matt Lofrano

Executive Vice President
+1 916 563 3056
matt.lofrano@colliers.com
CA Lic. 01251712

Mark Demetre, SIOR

Vice Chair
+ 1 916 563 3010
mark.demetre@colliers.com
CA Lic. 00852871

Hannah Crandall

Transaction Manager
+ 1 916 563 3093
hannah.crandall@colliers.com
CA Lic. 02043170

Dalfen
INDUSTRIAL



Property Overview

Property Highlights

- Contiguous for a total of $\pm 16,731$ SF
- $\pm 19'$ - $22'$ clear height
- Concrete tilt-up construction
- Skylights
- Glass storefronts
- Easy access to Interstates 5/80 and Highway 50

Availability

- **Suite 20:**
 - $\pm 8,435$ SF
 - $\pm 2,229$ SF office
 - 1 grade level door
- **Suite 30:**
 - $\pm 8,296$ SF
 - $\pm 1,482$ SF office
 - Large, drop T-bar ceiling, conditioned tech space (can be demolished)
 - 1 grade level door
- *Ability to convert one grade level door to dock high

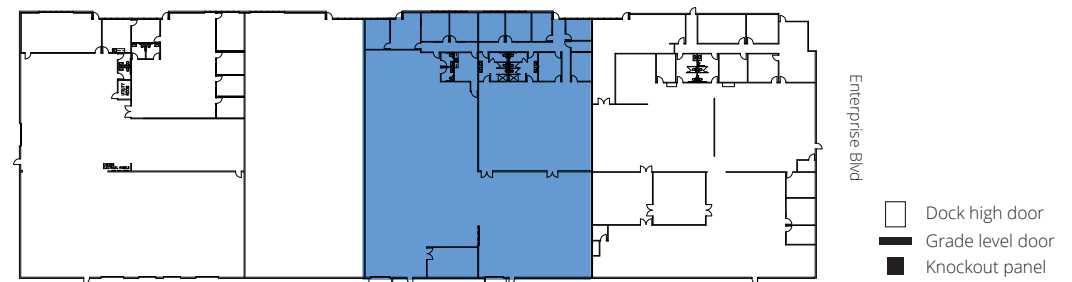
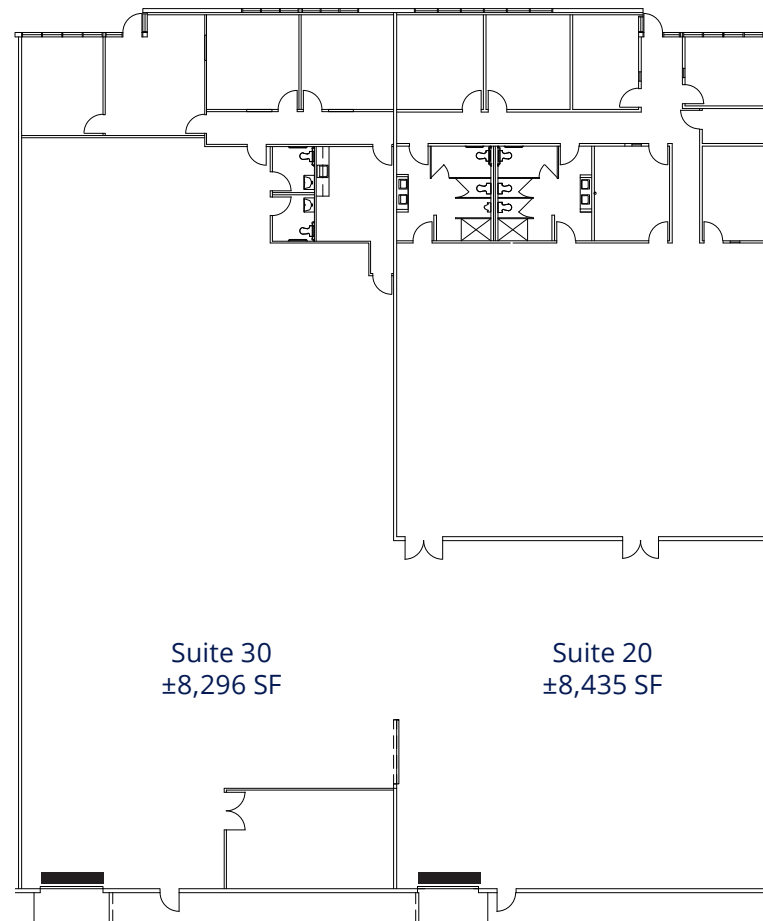

Location Overview



Matt Lofrano

Executive Vice President
 +1 916 563 3056
 matt.lofrano@colliers.com
 CA Lic. 01251712

Mark Demetre, SIOR

Vice Chair
 + 1 916 563 3010
 mark.demetre@colliers.com
 CA Lic. 00852871

Hannah Crandall

Transaction Manager
 + 1 916 563 3093
 hannah.crandall@colliers.com
 CA Lic. 02043170

Dalfen
 INDUSTRIAL

