

LAUDERDALE LAKES INDUSTRIAL PARK

Building #12, 2953 NW 27th Street | Oakland Park, FL 33311

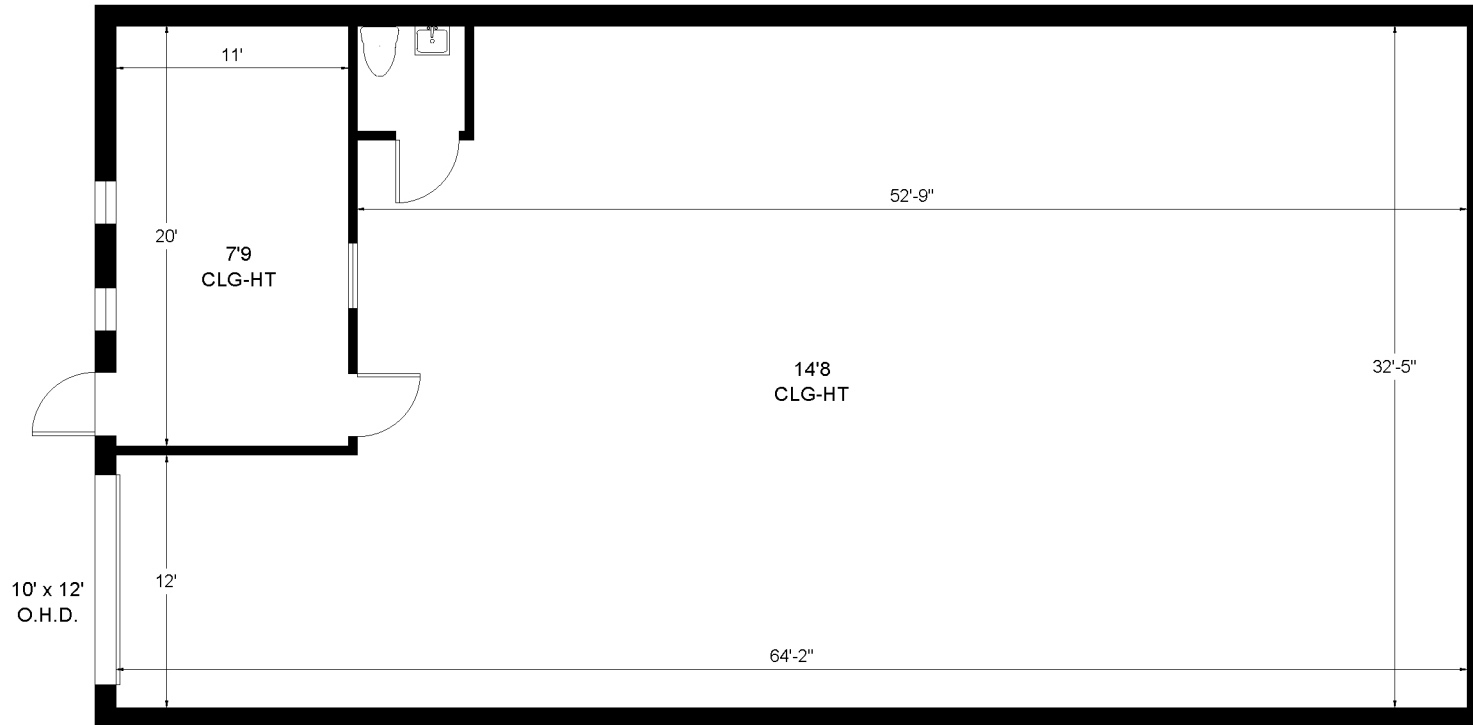

Office - 260 Sq. Ft.
Warehouse - 1,953 Sq. Ft.



Angie Weaver | Broker / Property Manager | 917.645.2339 | Angie@levyrai.com
Haley Presser | Property Manager | 954.254.5396 | Haley@levyrai.com
4901 NW 17th Way, Suite 103 | Ft. Lauderdale, FL 33309

2,213 Rentable Sq. Ft.
www.LevyRealtyAdvisors.com