



# 1000 PARK BOULEVARD | MASSAPEQUA PARK, NEW YORK



© VHT STUDIOS

## PROPERTY OVERVIEW

- Availability:
  - Suite 202A – 912 sf
  - Suite 202B – 501 sf
  - Suite 225 – 741 sf
- Executive Office Availability
- Directly across the street from the LIRR train station
- Exclusive building parking lot, adjacent municipal parking and street parking
- Visible from Sunrise Highway

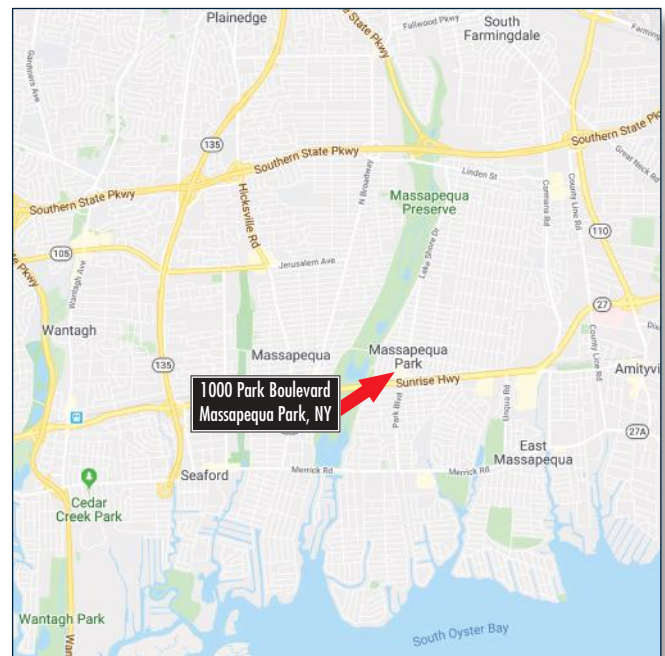

DEMOGRAPHICS	1 MILE	3 MILES	5 MILES
■ Population	17,727	151,101	338,134
■ Average HH Income	\$150,329	\$142,160	\$135,075
■ Total HH	6,012	51,749	116,152
■ Median Age	42.5	41.7	41.2

**CONTACT: Andrew Aberham** | T: 212-951-3833 | F: 212-545-1355 | aaberham@pihc.com  
**Michael Robbins** | T: 212-951-3828 | F: 212-545-1355 | mrobbins@pihc.com





# 1000 PARK BOULEVARD

MASSAPEQUA PARK, NEW YORK

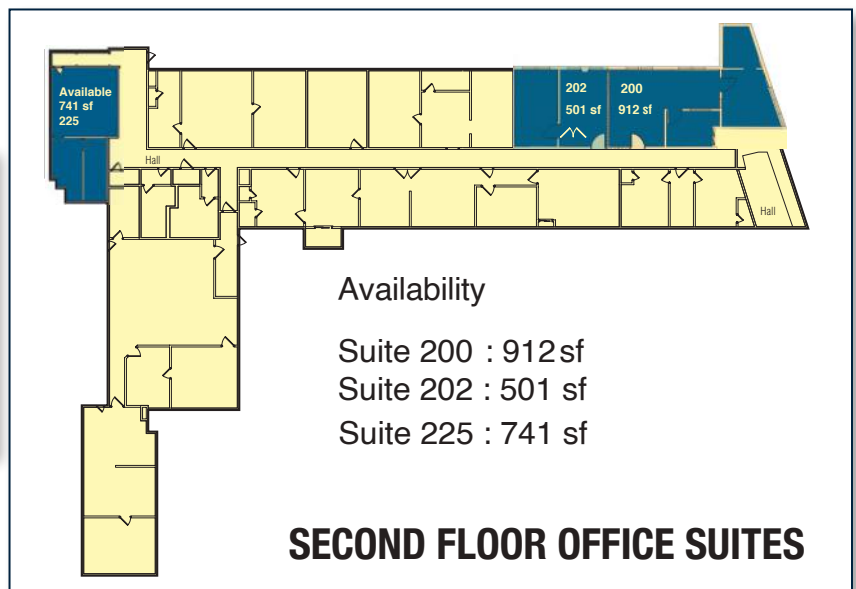
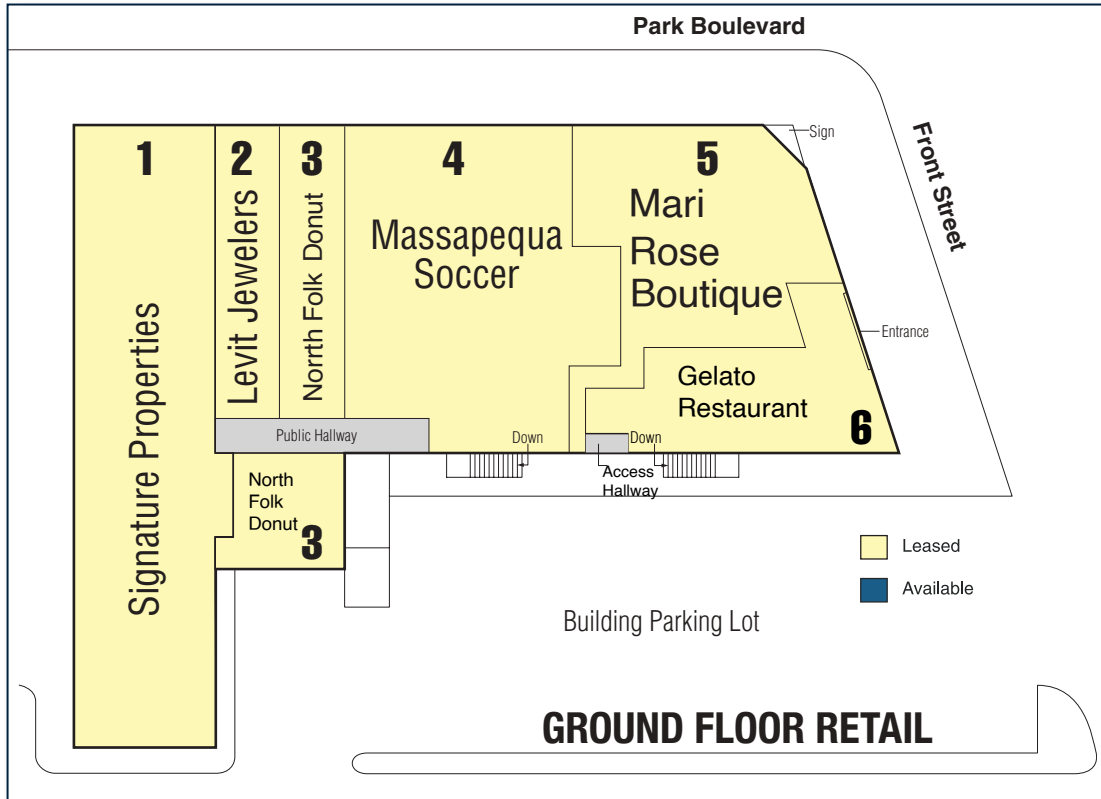

**CONTACT: Andrew Aberham** | T: 212-951-3833 | F: 212-545-1355 | [aaberham@pihc.com](mailto:aaberham@pihc.com)

All areas and dimensions are approximate. This plan is intended for identification purposes only and is not to be deemed a representation by Landlord as to the accuracy or square footage.

