

LEGEND:

-  DENOTES EXISTING DOOR TO REMAIN
-  DENOTES EXISTING DOOR TO BE REMOVED
-  DENOTES EXISTING CONSTRUCTION TO BE REMOVED
-  DENOTES EXISTING CONSTRUCTION TO REMAIN

NOTE: HATCHED AREAS ARE N.I.C.

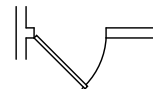
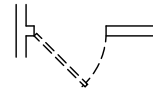
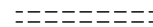
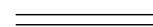
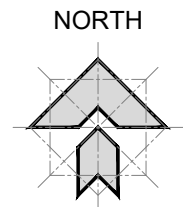

STEVEN E. MYOTT
 ARCHITECT
 639 e. ocean ave. suite 403
 boynton beach, florida
 www.semarchitecture.com
 p: 561.734.7034

SUITE 190
 - INTERIOR IMPROVEMENTS -

WEST BOYNTON MEDICAL PLAZA
 7593 W BOYNTON BEACH BLVD, SUITE 190
 BOYNTON BEACH, FLORIDA 33437

ALL DRAWINGS AND WRITTEN MATERIAL APPEARING HEREIN CONSTITUTE ORIGINAL & UNPUBLISHED WORK OF THE ARCHITECT AND MAY NOT BE USED, DUPLICATED OR DISCLOSED IN ANY FORM WITHOUT THE EXPRESSED WRITTEN CONSENT OF THE ARCHITECT		
PROJECT NO:	24.162	
DRAWN BY:	BH	
CHECKED BY:	SM	
NO:	DATE:	ISSUED FOR:
3	03.06.2025	PRELIMINARY PLAN
4	03.23.2025	PRELIMINARY PLAN
SCALE: 3/32" = 1'-0"		

DEMOLITION PLAN

D-1

C:\Users\Barry\Desktop\Projects\2024\24.162_7593 Suite 190 - Boynton\24.162_7593 Suite 190_PBC_CD.dwg
Barry
3/6/2025 12:19:19 PM

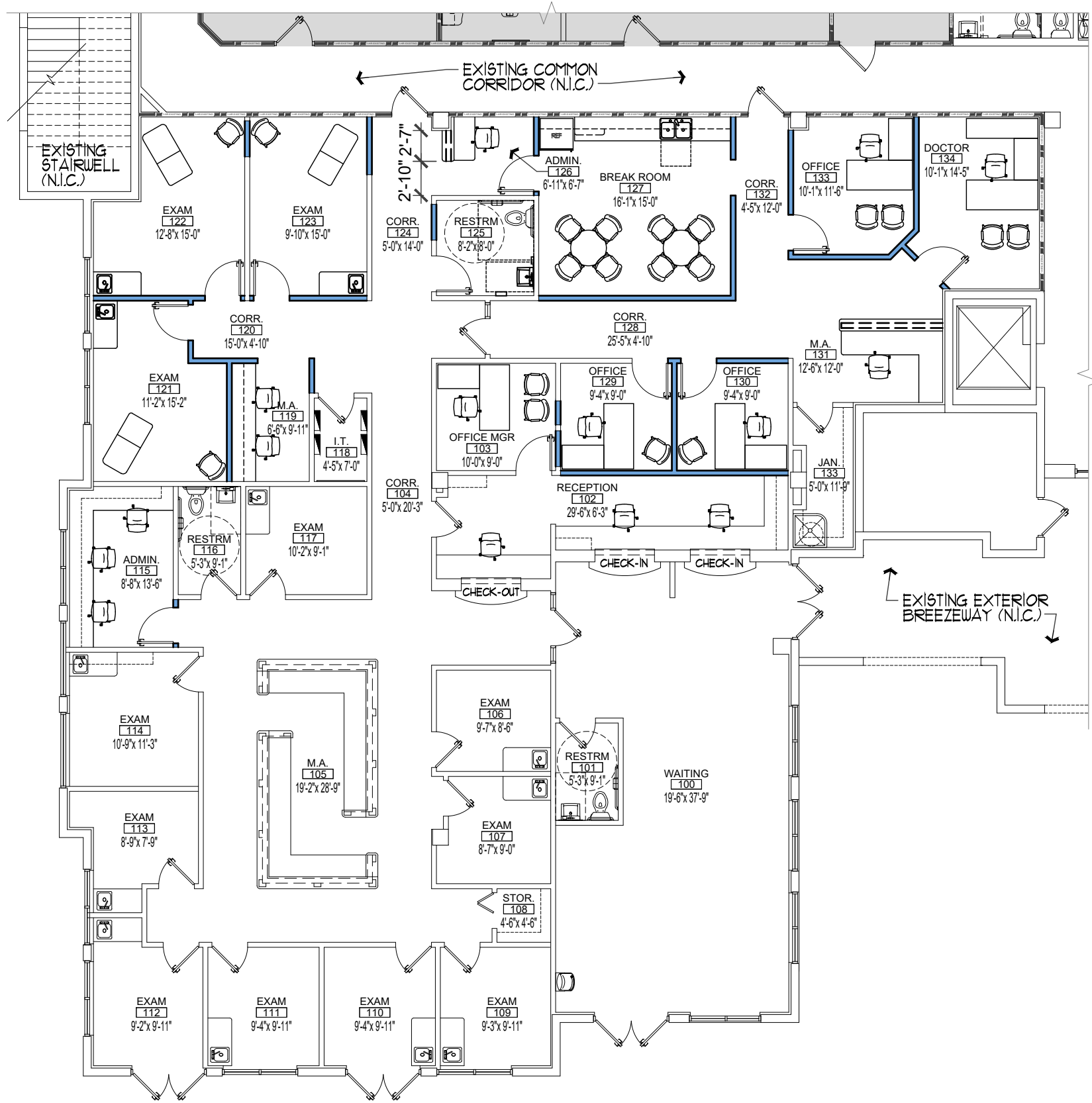

LEGEND:

- DENOTES EXISTING DOOR TO REMAIN
- DENOTES NEW OR RELOCATED DOOR
- DENOTES EXISTING CONSTRUCTION TO REMAIN
- DENOTES PROPOSED PARTITION

NOTE: HATCHED AREAS ARE N.I.C.

ALL AREAS ARE APPROXIMATE

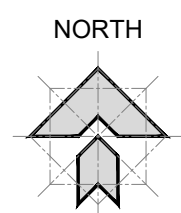

STEVEN E. MYOTT
ARCHITECT

639 e. ocean ave. suite 403
boynton beach, florida
www.semarchitecture.com
p: 561.734.7034

SUITE 190
- INTERIOR IMPROVEMENTS -

WEST BOYNTON MEDICAL PLAZA
7593 W BOYNTON BEACH BLVD, SUITE 190
BOYNTON BEACH, FLORIDA 33437

ALL DRAWINGS AND WRITTEN MATERIAL APPEARING HEREIN CONSTITUTE ORIGINAL & UNPUBLISHED WORK OF THE ARCHITECT AND MAY NOT BE USED, DUPLICATED OR DISCLOSED IN ANY FORM WITHOUT THE EXPRESSED WRITTEN CONSENT OF THE ARCHITECT		
PROJECT NO:	24.162	
DRAWN BY:	BH	
CHECKED BY:	SM	
NO:	DATE:	ISSUED FOR:
3	03.06.2025	PRELIMINARY PLAN
4	03.20.2025	PRELIMINARY PLAN
SCALE: 3/32" = 1'-0"		

SPACE PLAN

A-1