

EDENBRIDGE, KENT 1,452 SQ.FT. (134.9 SQ.M.) APPROX

TO LET

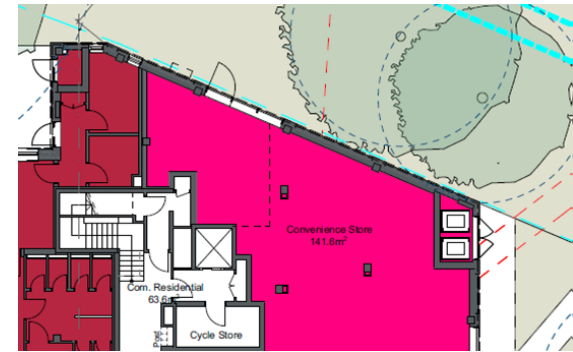

NEW RETAIL UNIT FORMING PART OF WIDER MIXED-USE DEVELOPMENT

LAND OFF FARMSTEAD DRIVE, EDENBRIDGE, KENT, TN8 6DX

**SALISBURY & Co.**

01732 463 205 [www.salisburyand.co](http://www.salisburyand.co)

CHARTERED SURVEYORS & PROPERTY CONSULTANTS

LOCATION

The property is situated on Farmstead Drive, a busy predominantly residential area, and forming part of a new development of twenty three residential properties, 64 parking spaces and a community hall.

DESCRIPTION

Comprises a newly built retail/business unit on the ground floor. The unit will be handed over in shell condition with capped off services, ready for an occupiers fit out.

The property is considered suitable for a number of commercial uses, subject to the necessary consents.

ACCOMMODATION

with approx. floor areas:

	Sq.Ft.	Sq.M.
Ground Floor:	1,452	134.9

TERMS

A new occupational lease is available for a term to be agreed, at a guide rent of £25,000 per annum.

LEGAL COSTS

Each party to pay their own costs.

RATING

To be assessed.

VAT

To be confirmed.

ENERGY PERFORMANCE CERTIFICATE (EPC)

To follow.

ANTI MONEY LAUNDERING

Anti money laundering checks will be undertaken on the successful tenant.

FEATURES

- New Unit
- Shell Condition
- 1,452 sq.ft. Approx.
- Completion Due May 2026
- Part of a Mixed-Use Development

VIEWING

By prior appointment with the sole agents:

Salisbury & Co. 01732 463 205

Neil Salisbury:

[neil@salisburyand.co](mailto:neil@salisburyand.co)

**SALISBURY & Co.**  
01732 463 205 [www.salisburyand.co](http://www.salisburyand.co)

CHARTERED SURVEYORS & PROPERTY CONSULTANTS

Lime Tree Workshop, 11 Lime Tree Walk,  
Sevenoaks, Kent, TN13 1YH



the mark of  
property  
professionalism  
worldwide

IMPORTANT NOTICE The accuracy of any description, dimensions, references to condition, necessary permissions for use and occupation and other details contained herein is not guaranteed and is for general guidance only and prospective purchasers or tenants must not rely on them as statements of fact or representations and must satisfy themselves as to their accuracy. Neither Salisbury & Co. Ltd nor any of their employees or representatives has any authority to make or give any representation or warranty or enter into any contract whatever in relation to the property. Prices quoted in these particulars may be subject to VAT in addition. The reference to any mechanical or electrical equipment or other facilities at the property shall not constitute a representation (unless otherwise stated) as to its state or condition or that it is capable of fulfilling its intended function. Prospective tenants/purchasers should satisfy themselves as to the fitness of such equipment for their requirements. Salisbury & Co. is the trading name of Salisbury & Co. Ltd. Registered in England Company No. 05291959. Registered Office: 2 Lakeview Stables, Lower St Clere, Kemsing, Sevenoaks, Kent, TN15 6NL.

