

1 PARTIAL FIRST FLOOR PLAN
 1/8" = 1'-0"

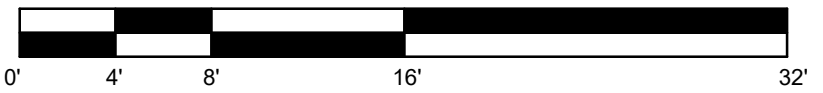

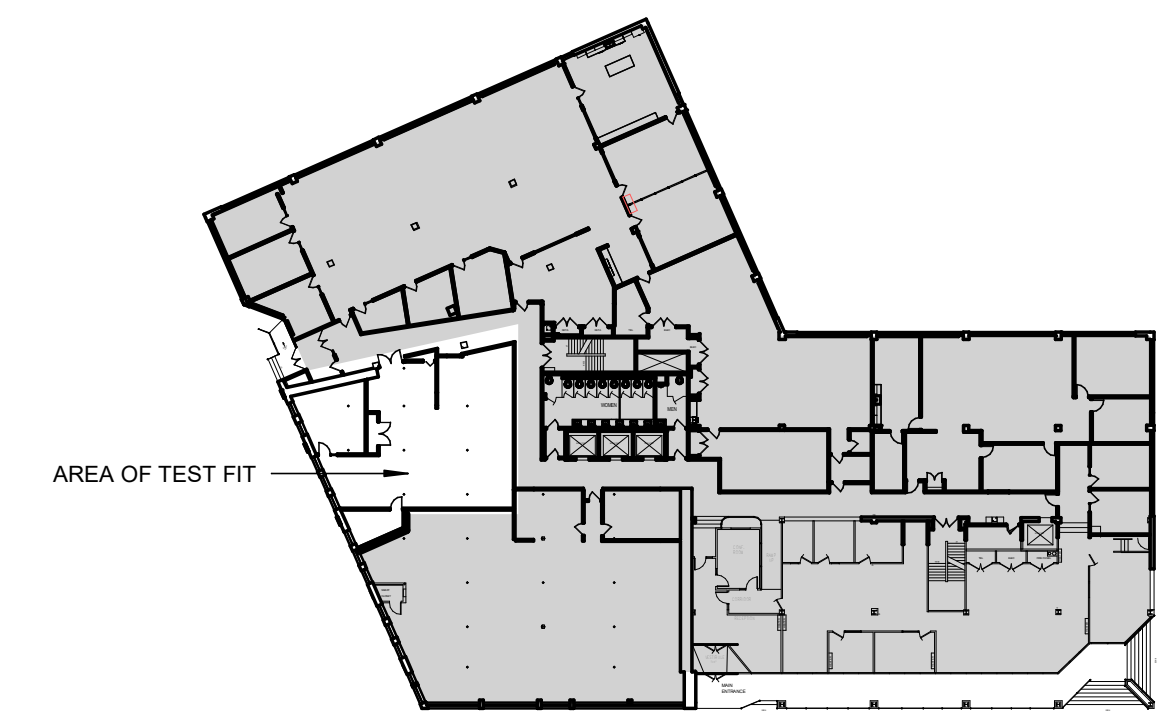



2 FIRST FLOOR KEY PLAN
 N.T.S.

TEST FIT NOTE

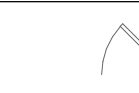
THIS IS A PRELIMINARY STUDY AND IS SUBJECT TO REVIEW AND APPROVAL OF THE LOCAL AUTHORITIES HAVING JURISDICTION.

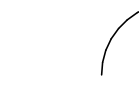
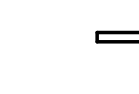
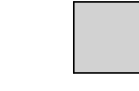
FLOOR PLAN SYMBOLS

-  EXISTING DOOR, FRAME & HARDWARE TO REMAIN, UNLESS NOTED OTHERWISE
-  EXISTING WALL TO REMAIN
-  NEW DOOR, FRAME AND HARDWARE
-  NEW WALL CONSTRUCTION
-  AREA SHADED NOT IN SCOPE

STAMP:

TEST FIT AT:
 99 SOUTH MAIN STREET
 FIRST FLOOR
 FALL RIVER, MA

PROJECT STATUS:
PRELIMINARY - NOT FOR CONSTRUCTION

DATE: 03/23/2022 (REV 2)

PROJECT NO: 11110a

DRAWN BY: LJZ

CHECKED BY: -

© 2022 VISION 3 ARCHITECTS
 THESE DOCUMENTS HAVE BEEN PREPARED SPECIFICALLY FOR THE PROJECT LISTED ABOVE. THEY ARE NOT SUITABLE FOR USE ON OTHER PROJECTS OR IN OTHER LOCATIONS WITHOUT APPROVAL AND PARTICIPATION OF VISION 3 ARCHITECTS. REPRODUCTION IS PROHIBITED.

REVISIONS:

NO.	DESCRIPTION

DRAWING TITLE:

TEST FIT PLAN

DRAWING NO.:

TF1.0