



16,291 SF

\$12.50 PSF GROSS



CUSHMAN &
WAKEFIELD

AVAILABLE FOR SUBLEASE
594 Territorial Dr, Bolingbrook
Suite G

PROPERTY FEATURES

96,978 SF

TOTAL BUILDING SIZE

2 EXTERIOR DOCKS; 1 DID

LOADING

1,543 SF

OFFICE

16,291 SF

AVAILABLE FOR SUBLEASE

24'

CLEAR HEIGHT

9/2029

SUBLEASE EXPIRATION

DESIRABLE NORTHWEST ENDCAP UNIT • HEAVY POWER • FULLY AIR-CONDITIONED



SUITE G AERIAL



FLOOR PLAN & PHOTOS

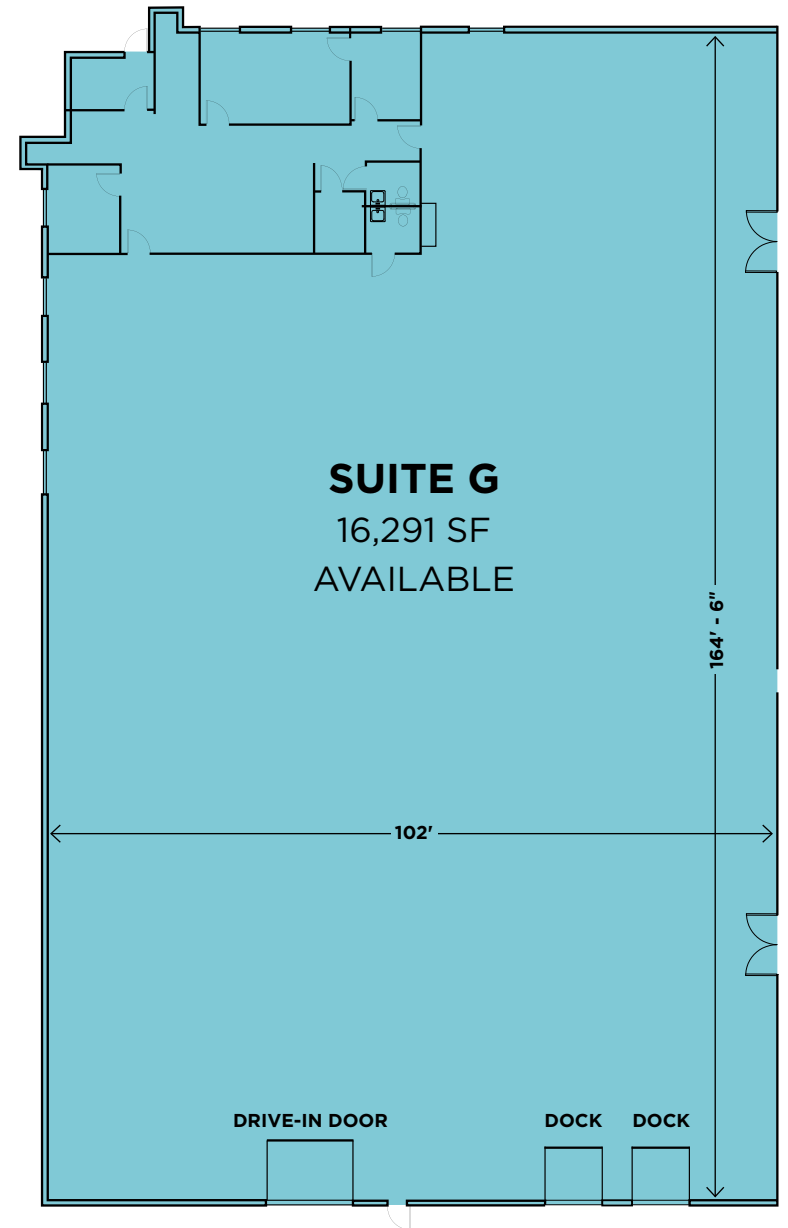



**CONTACT THE
SUBLEASING TEAM:**

Connor Niego
Senior Associate
+1 708 870 1531
connor.niego@cushwake.com

Al Caruana
Executive Managing Director
+1 847 720 1326
al.caruana@cushwake.com