

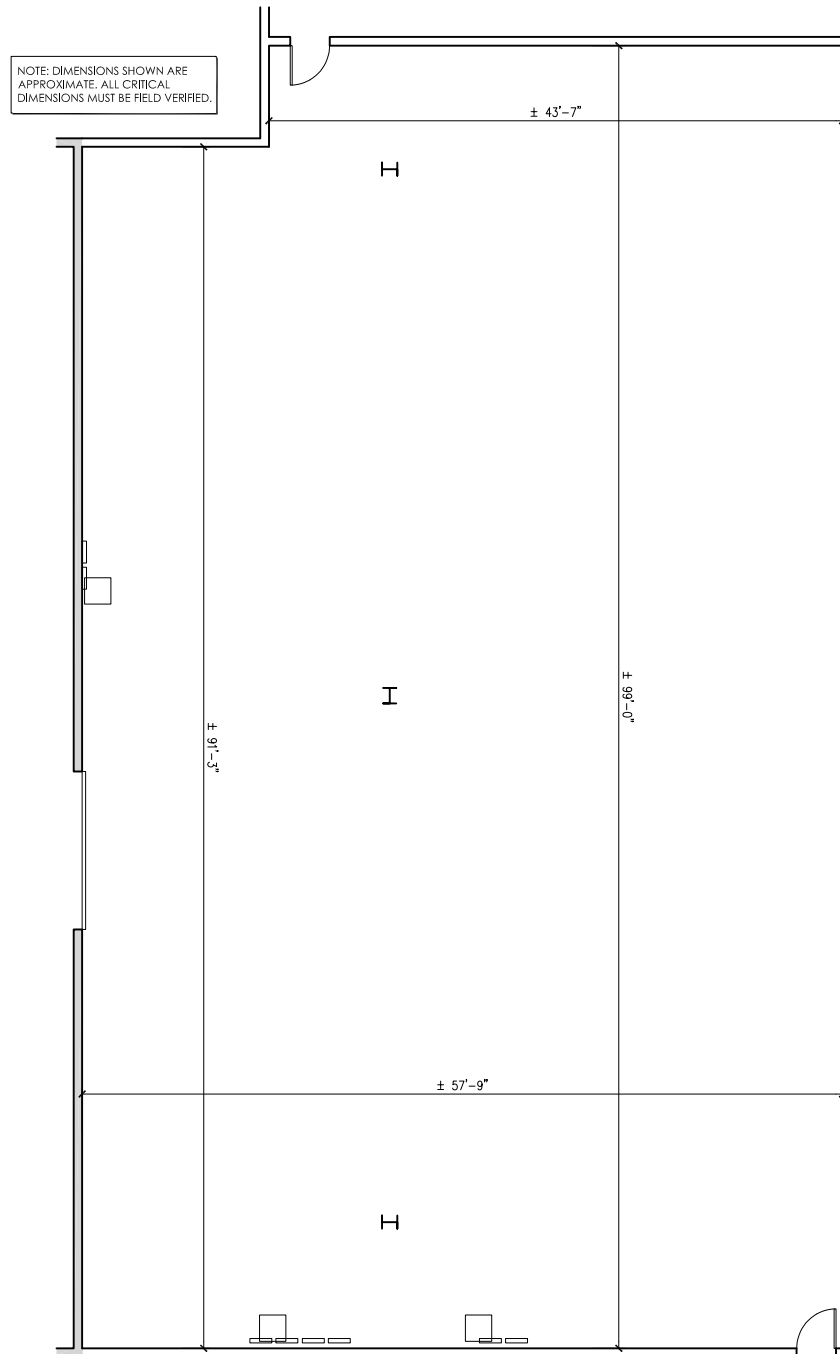

Suite: 302  
SF: 7,000

## Space Features:

- Open Industrial Space
- High Ceilings
- Natural Light
- 14'h x 12' Drive in Roll Up
- No HVAC
- Science-Focused Campus Ideal For Climate Tech, Life Sciences, EV, Ag-Tech, Lab, Biotech, AI, Health Tech, Robotics, Cleantech, Chemistry, Medical Device, Food Science, Drone Tech, VR.
- Robust HVAC System Heavy Power
- Flexible Opportunity
- Landlord Will Build To Tenants Spec Requirements





1933 Davis St.

**Gallery**

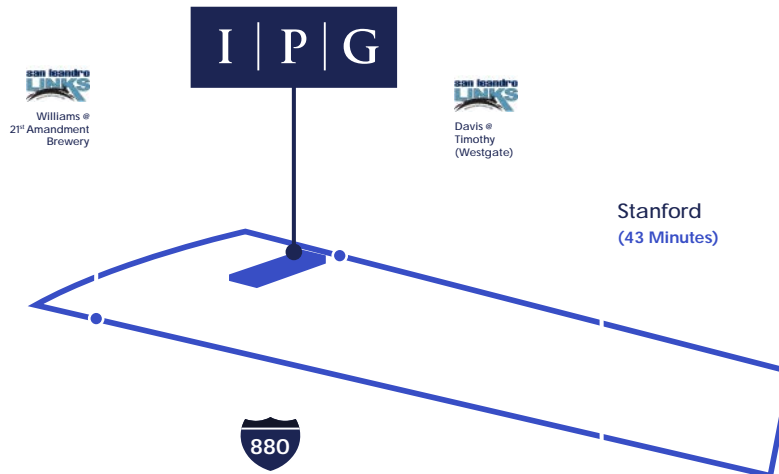

— Free BART Shuttle

● Shuttle Stop



1933 **Davis St.**  
San Leandro CA

## For leasing information

### Innovation Properties Group

181 2nd Street, San Francisco, CA  
www.ipgsf.com | CL 02031924

ipgsf.com

### Rocky Kile | Director

(401) 263-4218 | rocky@ipgsf.com  
DRE: 02233435

### Taylor Stein | Senior Vice President

(415) 518-8550 | taylor@ipgsf.com  
DRE: 02059122

### Ivan Smiljanic | Partner

(510) 717-5008 | ivan@ipgsf.com  
DRE: 01995999

### Denis Dineen | Senior Associate

(650) 580-4383 | denis@ipgsf.com  
DRE: 02142178

This document has been prepared by IPG for advertising and general information only. IPG makes no guarantees, representations or warranties of any kind, expressed or implied, regarding the information including, but not limited to, warranties of content, accuracy and reliability. Any interested party should undertake their own inquiries as to the accuracy of the information. IPG excludes unequivocally all inferred or implied terms, condition and warranties arising out of this document and excludes all liability for loss and damages arising there from. This publication is the copyrighted property of IPG and/or its licensor(s). ©2025. All rights reserved.