



WELLINGTON CENTER

GAINESVILLE, VIRGINIA

13525

WELLINGTON CENTER CIRCLE

13555

WELLINGTON CENTER CIRCLE

13575

WELLINGTON CENTER CIRCLE



JLL METRO DC INDUSTRIAL

JOHN DETTLEFF

703.517.3074

john.dettleff@jll.com

DAN COATS

703.891.8410

dan.coats@jll.com

SAM HAAS

443.878.3499

sam.haas@jll.com



PORTFOLIO OVERVIEW - 3 Buildings | 133,064 SF | Light Industrial | Built in 2008 | M-1 & M-2 Zoning



SITE PLAN

WELLINGTON CENTER

GAINESVILLE, VIRGINIA

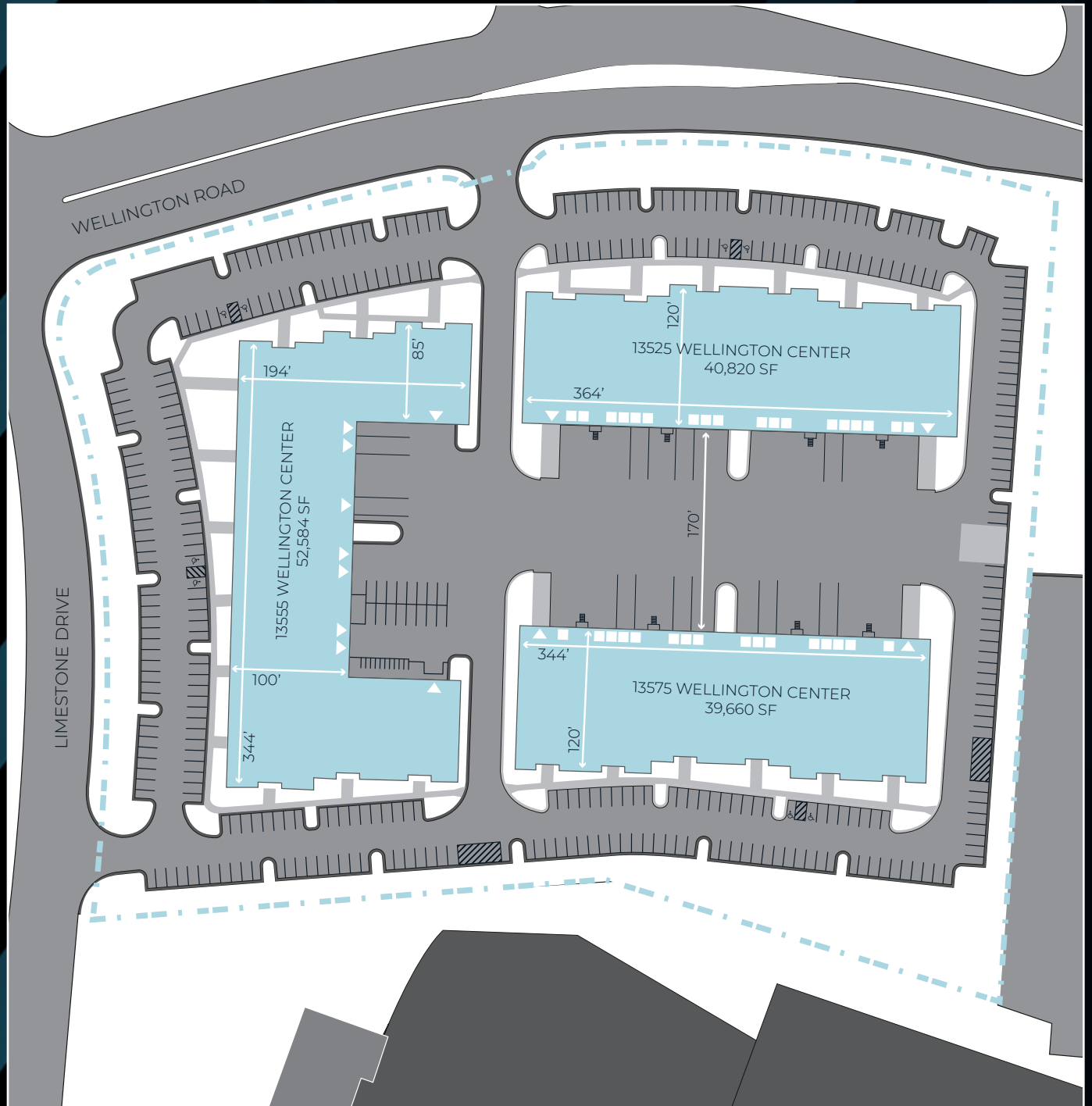

SPACE PLAN- 13555 WELLINGTON CENTER CIRCLE, SUITE C

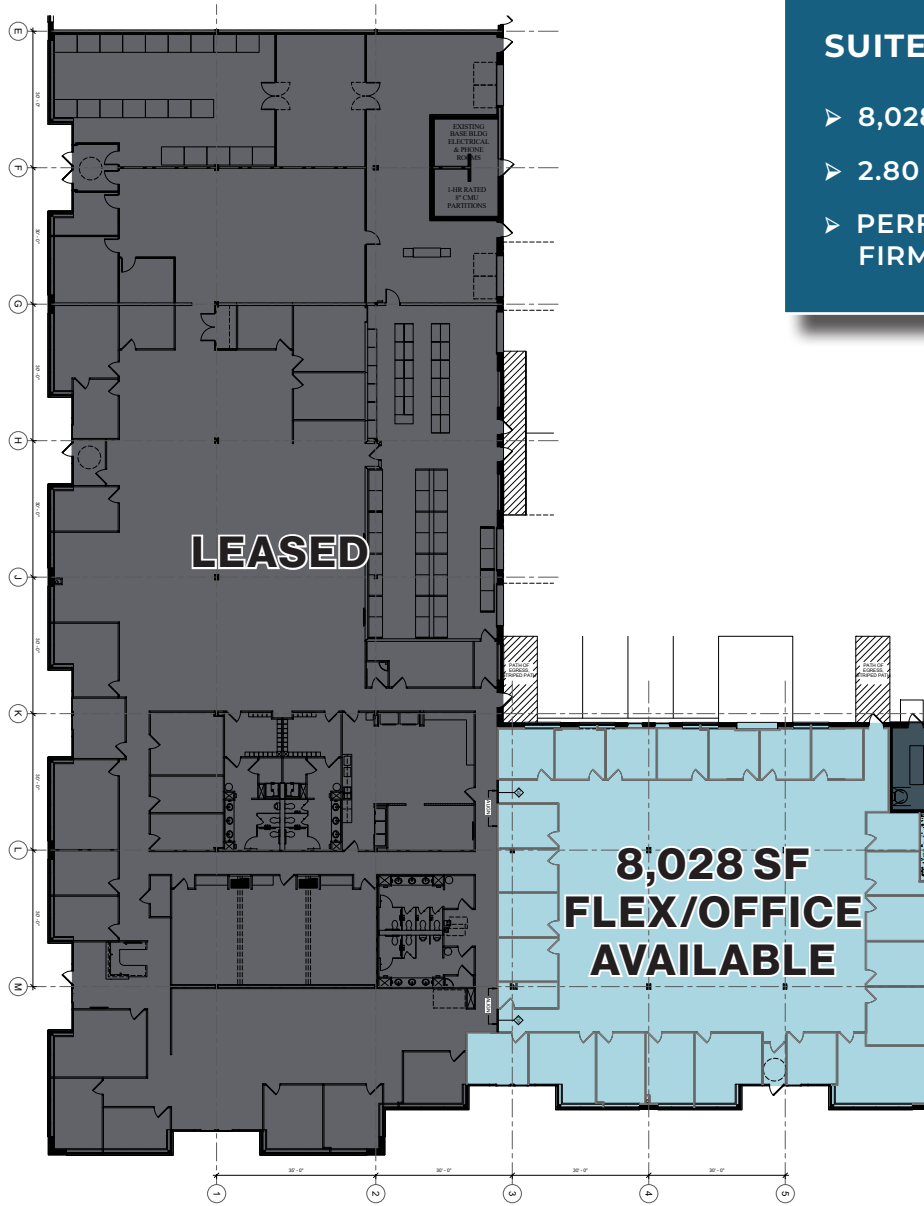

SUITE C 125-129

- 8,028 SF FLEX / OFFICE SPACE AVAILABLE
- 2.80 / 1,000 SF PARKING RATIO
- PERFECT FOR DATA CENTER CONTRACTORS, ENGINEERING FIRMS, GOVERNMENT CONTRACTORS, ETC.



LOCATION/ACCESS

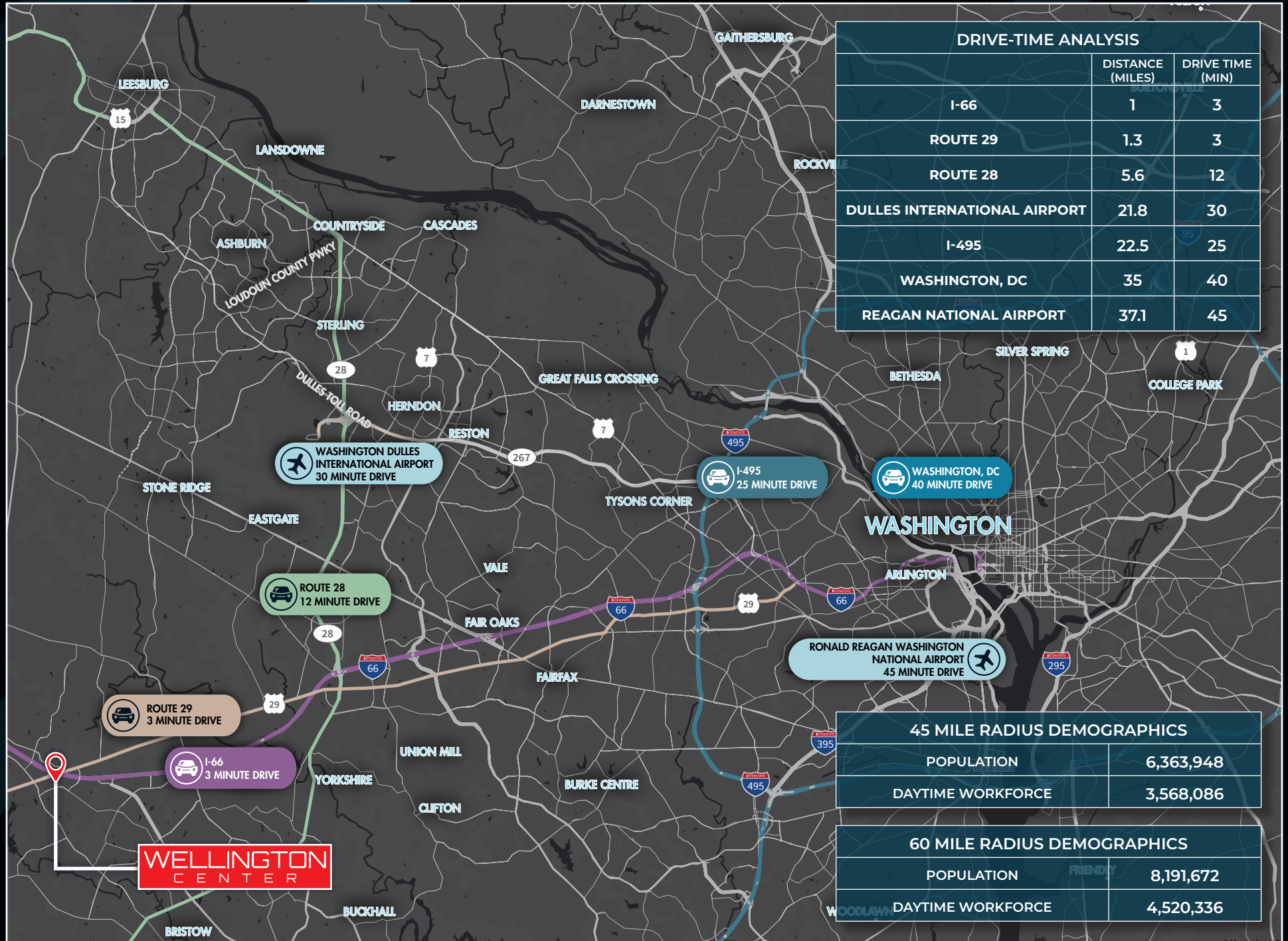

PROXIMITY TO DATA CENTERS





DRIVING DISTANCE TO MAJOR CITIES

35
MILES TO
WASHINGTON, DC

72
MILES TO
BALTIMORE, MD

102
MILES TO
RICHMOND, VA

175
MILES TO
PHILADELPHIA, PA

185
MILES TO
HAMPTON ROADS, VA

260
MILES TO
NEW YORK, NY

350
MILES TO
CHARLOTTE, NC

385
MILES TO
COLUMBUS, OH

470
MILES TO
BOSTON, MA

590
MILES TO
ATLANTA, GA

Although information has been obtained from sources deemed reliable, neither Owner nor JLL makes any guarantees, warranties or representations, express or implied, as to the completeness or accuracy as to the information contained herein. Any projections, opinions, assumptions or estimates used are for example only. There may be differences between projected and actual results, and those differences may be material. The Property may be withdrawn without notice. Neither Owner nor JLL accepts any liability for any loss or damage suffered by any party resulting from reliance on this information. If the recipient of this information has signed a confidentiality agreement regarding this matter, this information is subject to the terms of that agreement. ©2025. Jones Lang LaSalle IP, Inc. All rights reserved.



For more information, please contact:

JOHN DETTLEFF
703.517.3074
john.dettleff@jll.com

DAN COATS
703.891.8410
dan.coats@jll.com

SAM HAAS
443.878.3499
sam.haas@jll.com