



AVAILABILITY

Unit B: 6,222 SF

PROPERTY HIGHLIGHTS

- Located right off I-95 / ICC on Route 1
- Immediate access to I-95, I-495 and ICC (Route 200)
- Close proximity to Muirkirk Commuter Rail (Camden Line)
- Abundant shopping/dining options within 3 miles

KENNETH FELLOWS

kfellows@klnb.com | 301-222-0210

ROBERT PUGH

rpugh@klnb.com | 301-222-0211

KEIRY MARTINEZ

kmartinez@klnb.com | 703-334-5629

FLOOR PLAN

12200 BALTIMORE AVE

12200 BALTIMORE AVE BELTSVILLE MD 20705

Unit B
6,222 SF

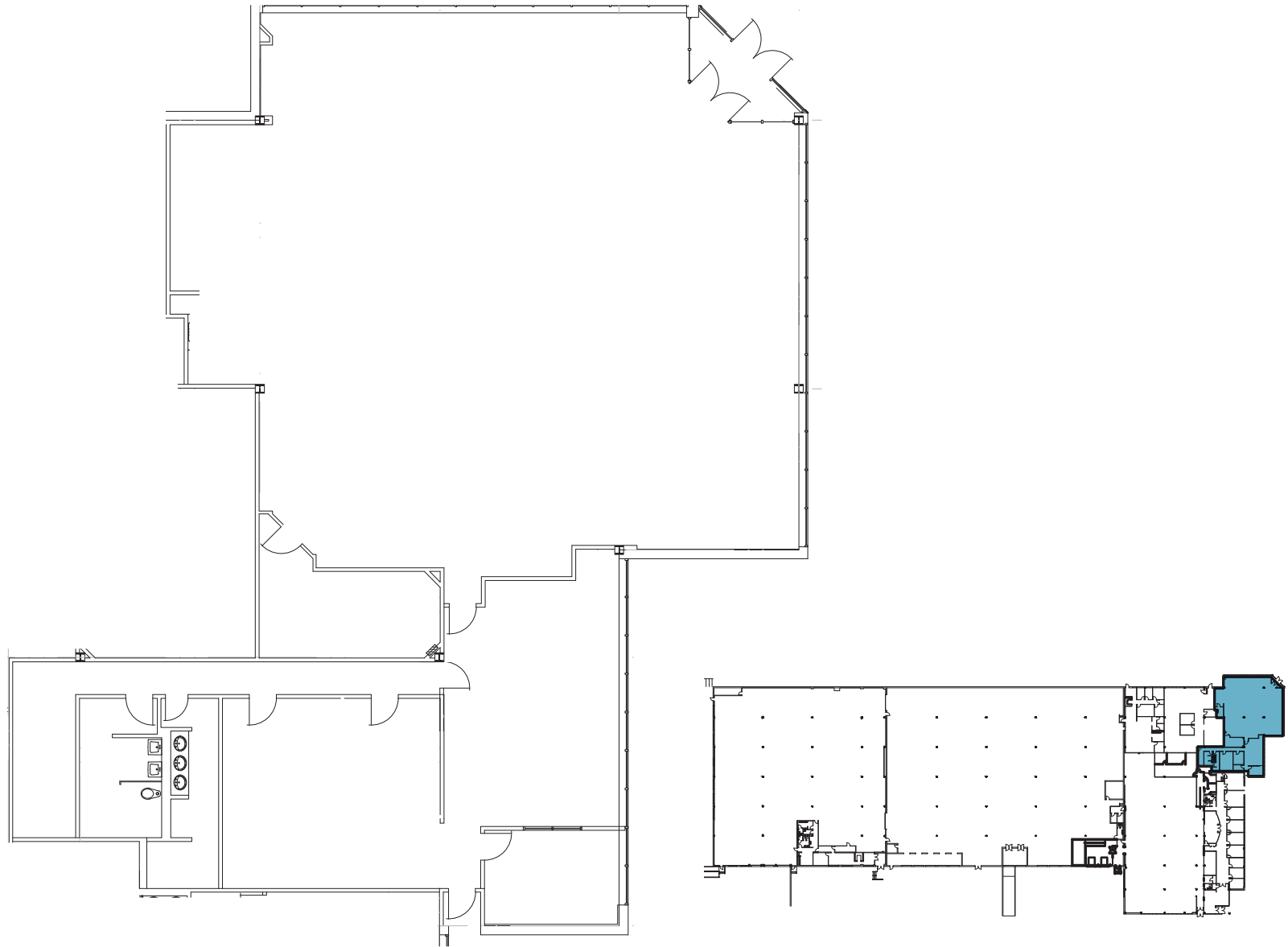

KENNETH FELLOWS

kfellows@klnb.com | 301-222-0210

ROBERT PUGH

rpugh@klnb.com | 301-222-0211

KEIRY MARTINEZ

kmartinez@klnb.com | 703-334-5629

klnb

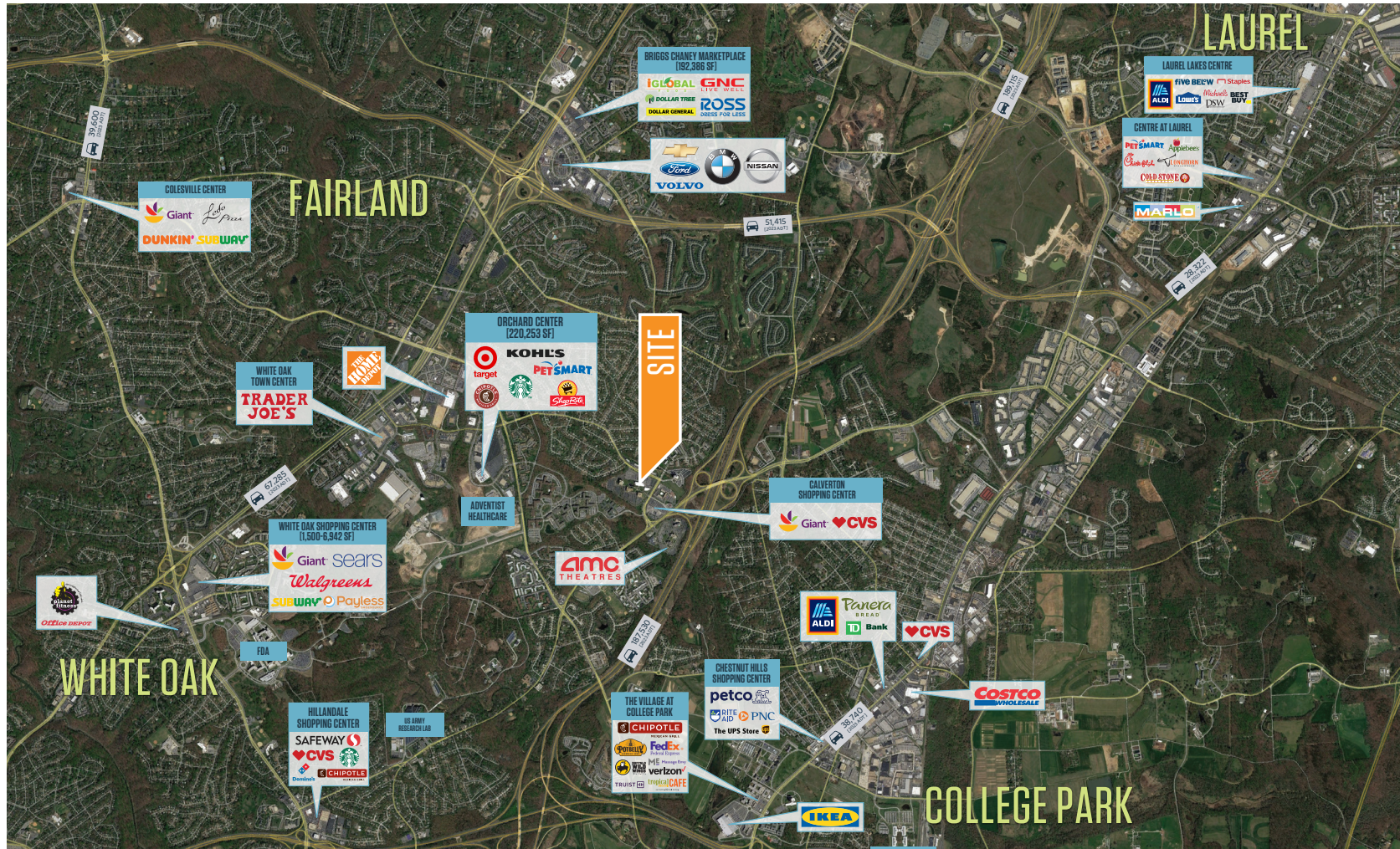

Transportation

Thoroughfare	
MARC Station	0.5 miles
Route 200	0.8 miles

Airport	
Baltimore/Washington International	22.6 miles
Ronald Reagan Washington	21.9 miles



12200 BALTIMORE AVE

12200 BALTIMORE AVE BELTSVILLE, MD 20705

FOR MORE INFORMATION, PLEASE CONTACT:

KENNETH FELLOWS

kfellows@klnb.com
301-222-0210

ROBERT PUGH

rpugh@klnb.com
301-222-0211

KEIRY MARTINEZ

kmartinez@klnb.com
703-334-5629

12435 Park Potomac Ave, Suite 250, Rockville, MD, 20854

.....

klnb.com



instagram.com/klnbcre



linkedin.com/company/klnb



facebook.com/KLNBCRE

CLICK TO VIEW PROPERTY WEBSITE

While we have no reason to doubt the accuracy of any of the information supplied, we cannot, and do not, guarantee its accuracy. All information should be independently verified prior to a purchase or lease of the property. We are not responsible for errors, omissions, misuse, or misinterpretation of information contained herein and make no warranty of any kind, express or implied, with respect to the property or any other matters.