



# 5922 W Bowcroft Street

## Los Angeles, CA 90016

± 25,450 SF Industrial Building for Lease

Ron Rader, SIOR  
310.245.2200  
rrader@leewestla.com

Gage Danley  
310.899.2749  
gdanley@leewestla.com

### Premises

± 24,450 SF  
*Can be fully air conditioned*

### Rent

\$2.65, SF/Net  
Opex: \$0.34

### Occupancy

June 1, 2026

### Term

5+ Years

### Parking

50 Car Parking

### Features

- ± 1,500 SF - 5,000 SF of Office Space
- Two (2) Ground Level Loading Doors
- Bow Truss Ceiling
- 14 - 25 Foot Clear Height
- Five (5) Offices and One (1) Conference Room
- Ample Power
- One (1) Shared Dock High Loading Position
- Culver City Adjacent

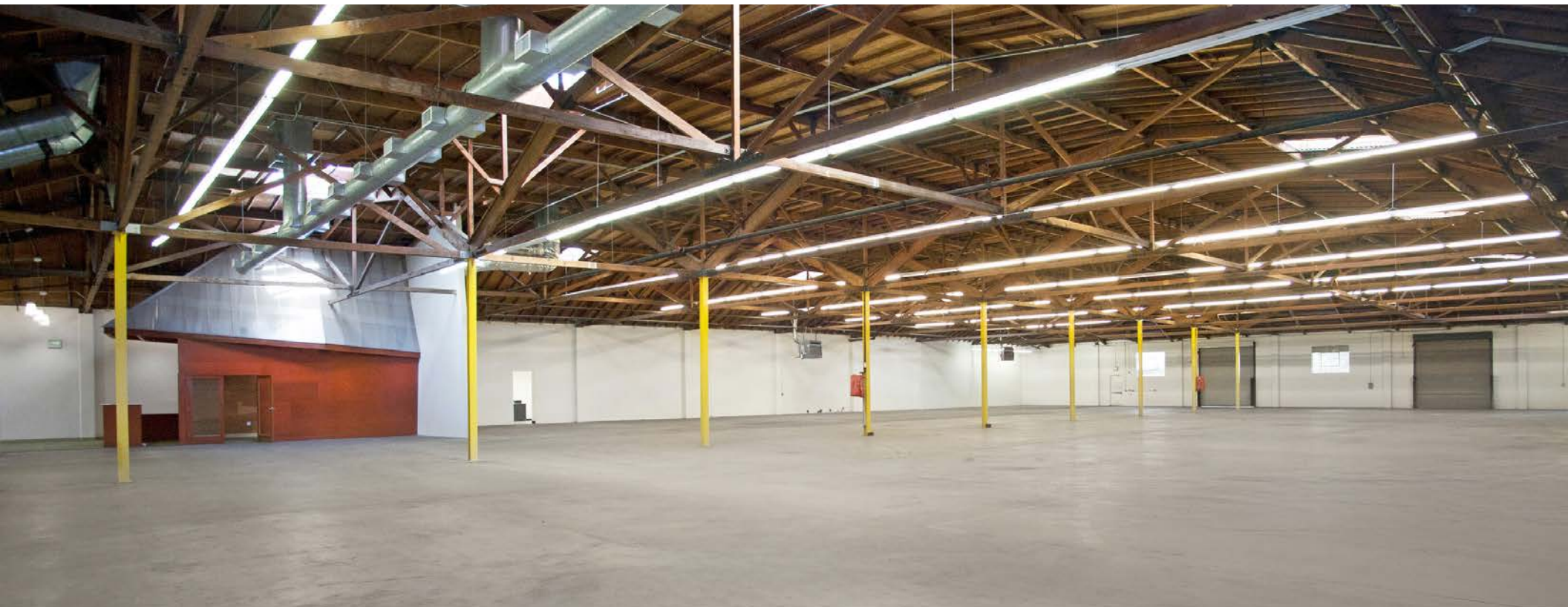

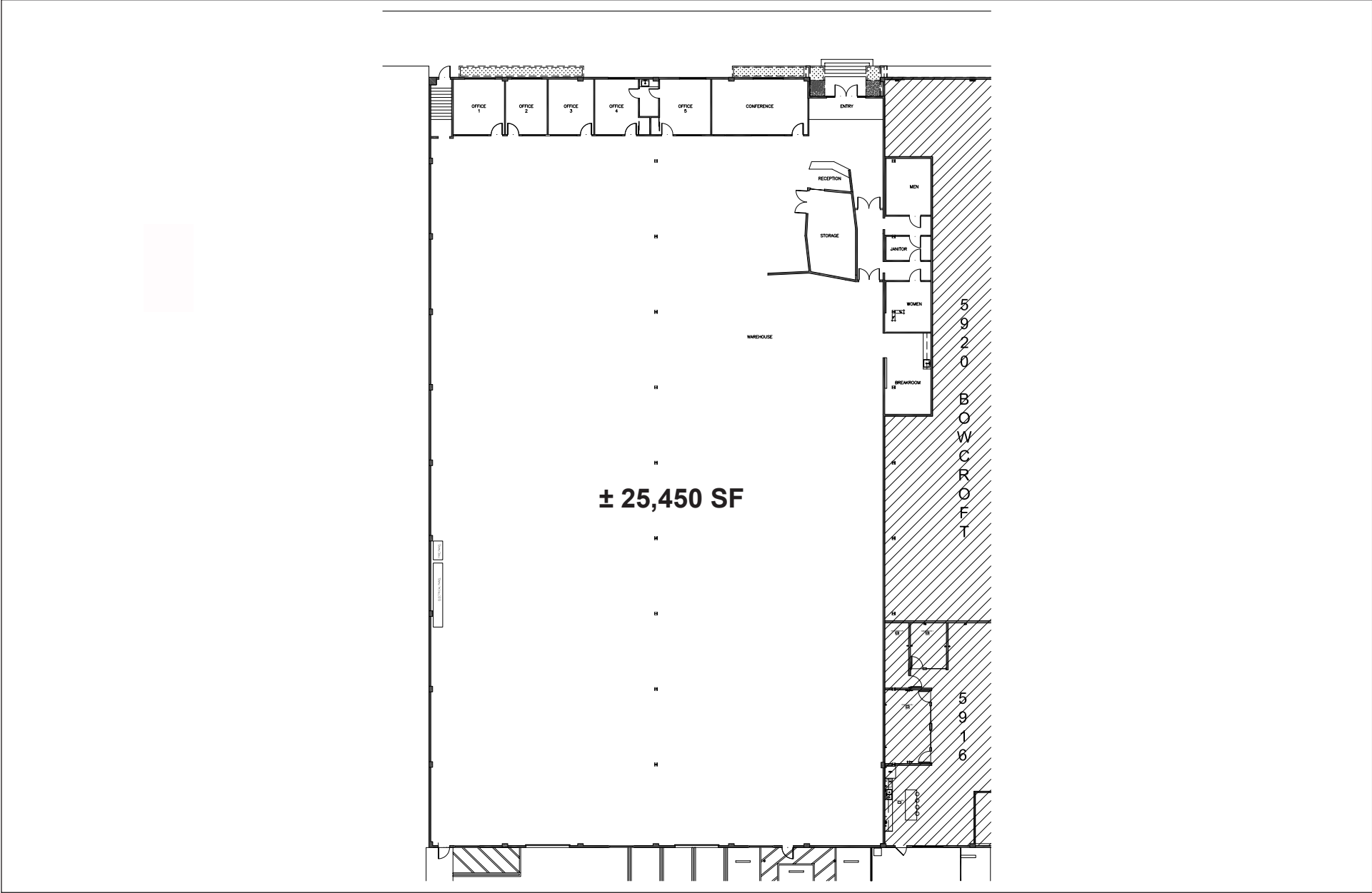



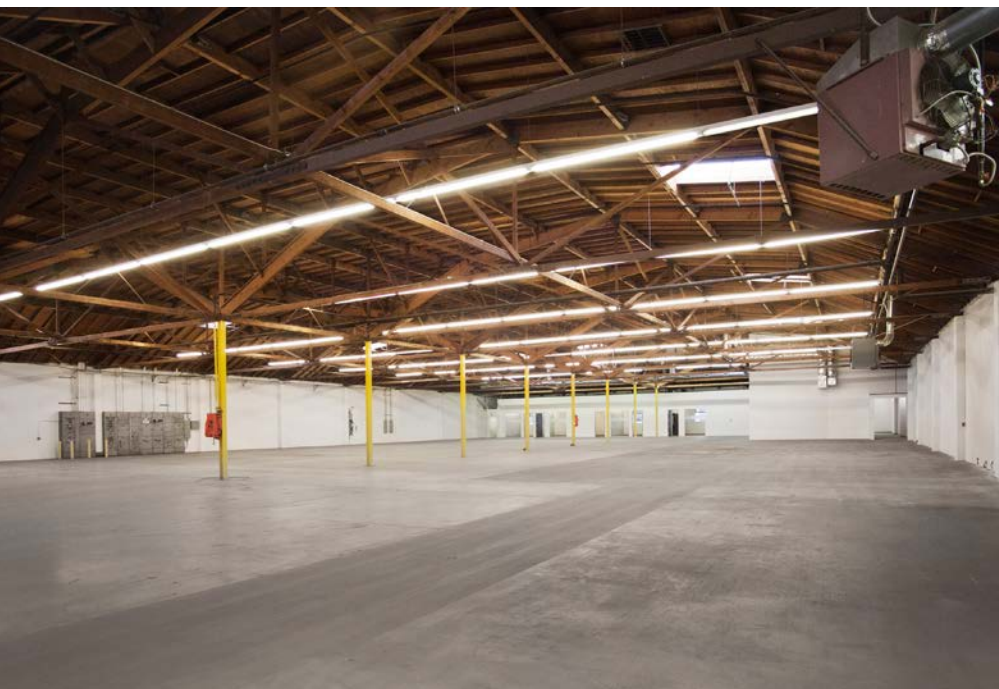
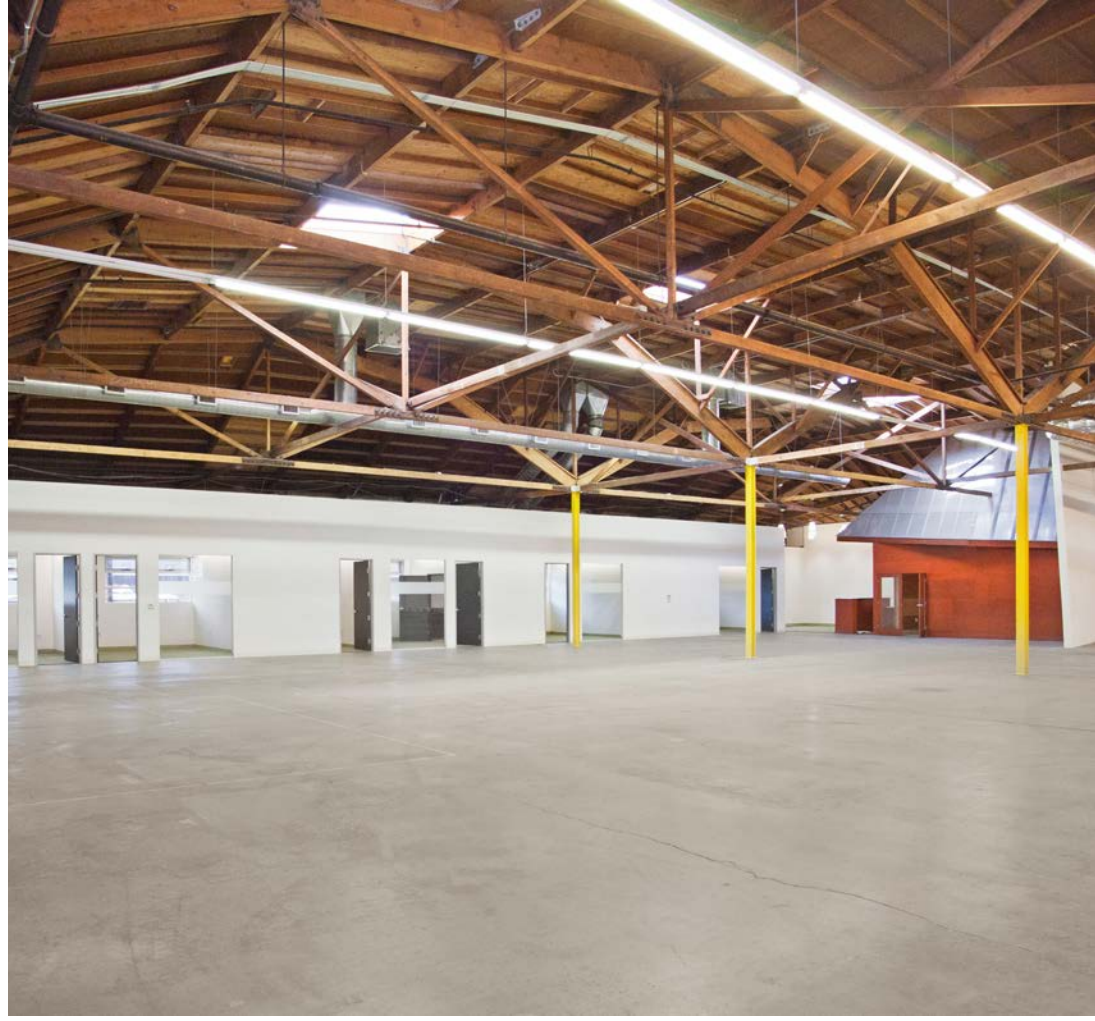



# 5922 Bowcroft St

## Nearby Restaurants & Amenities

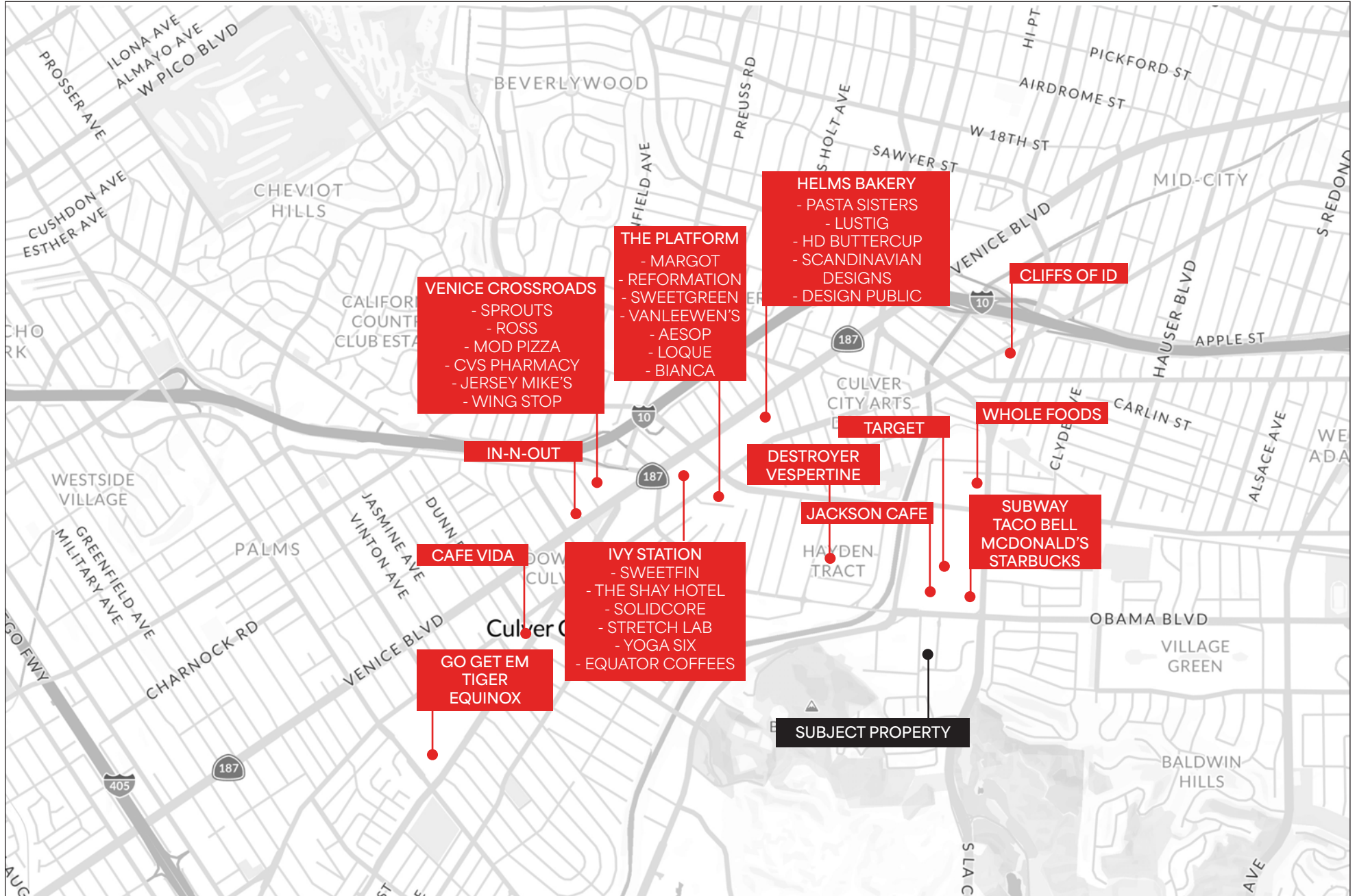

# 5922 Bowcroft St

# Nearby Tenants

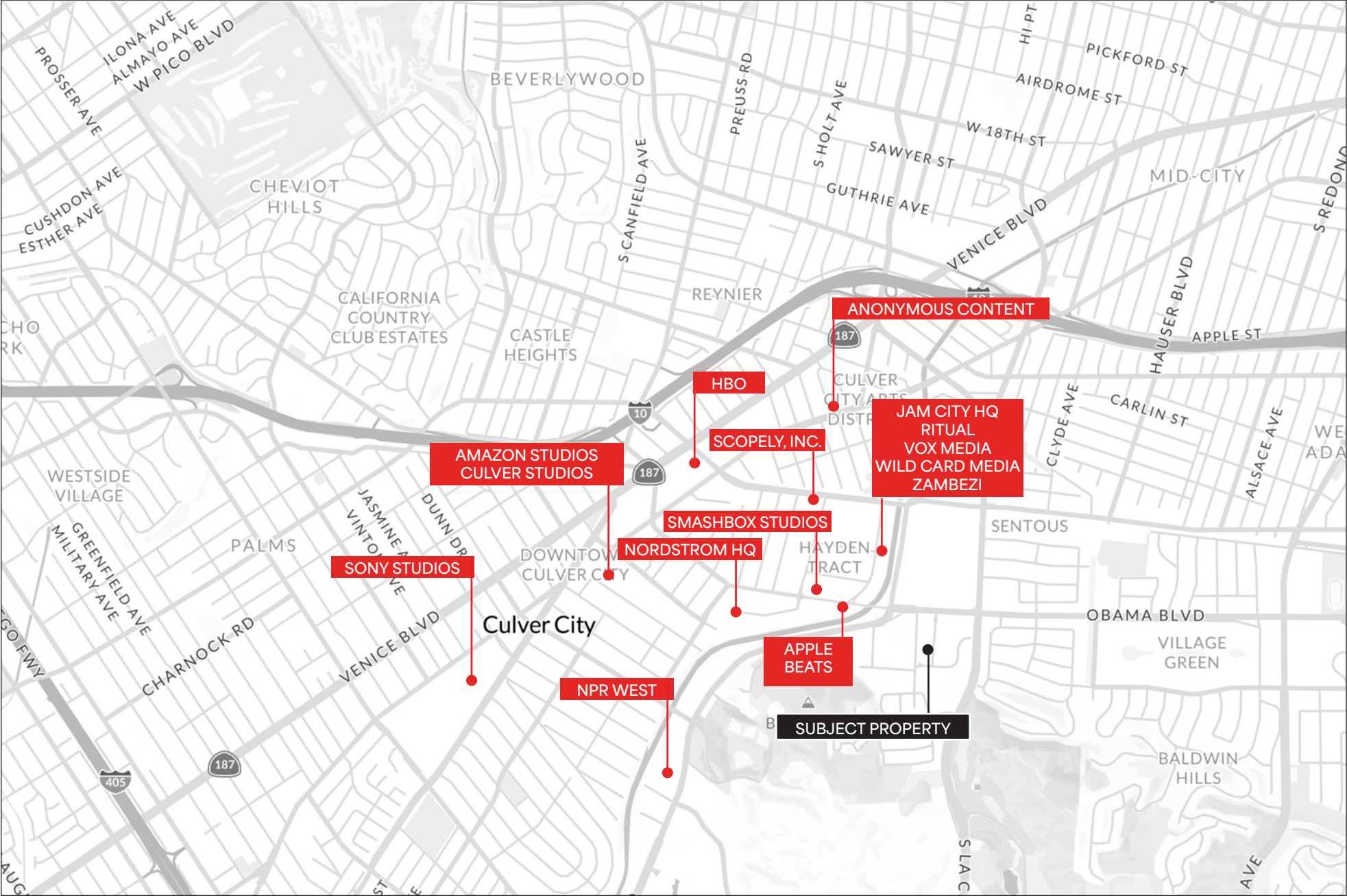

# 5922 W Bowcroft Street

## Los Angeles, CA

**Ron Rader, SIOR**

310.245.2200

[rrader@leewestla.com](mailto:rrader@leewestla.com)

BKR DRE 00452728

**Gage Danley**

310.899.2749

[gdanley@leewestla.com](mailto:gdanley@leewestla.com)

AGT DRE 02075191



A DIVISION OF



No warranty or representation is made to the accuracy of the foregoing information.  
Terms of sale or lease are subject to change or withdrawal without notice.