



CENTERPARK LABS

centerparklabs.com

Colliers

STEVE BRUCE

Vice Chairman | Co-Lead
t 858-922-3056
steve.bruce@colliers.com
CA RE Lic. #01455744

CHRIS HIGH, SIOR

Vice Chairman | Co-Lead
t 619-772-2936
chris.high@colliers.com
CA RE Lic. #01734544

CONOR EVANS

Vice President
t 858-291-1415
conor.evans@colliers.com
CA RE Lic. #01963596

6815 Flanders Dr

SECOND FLOOR



Suite 200
28,311 SF

[CLICK FOR VIRTUAL TOUR](#)

Furniture included is for conceptual purposes

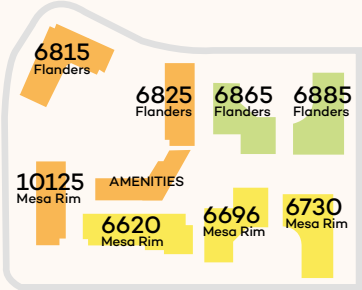

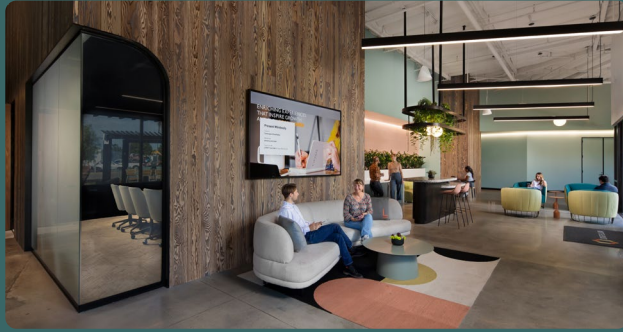

Room for life- at work

- Onsite Restaurant
- Beer On Tap
- Food Trucks
- Mindfulness Spaces
- Outdoor Seating
- Collaboration Areas
- Resort Style Fitness Center