

FOR LEASE

8275 BEVERLY BLVD

LOS ANGELES, CA 90048

JACK RAVAN

tel - 323-782-1270 | jackravan@southparkgroup.com
DRE LICENSE #00890189

SASHA SOOFER

tel - 424-888-3695 | sasha@southparkgroup.com
DRE LICENSE #02221169

Property Overview

FOR LEASE

**8275 BEVERLY BLVD.
LOS ANGELES, CA 90048**

- Extra High Dome Ceilings on the corner of Beverly Blvd and Sweetzer
- Patio, with roll up garage-style doors
- Kitchen, with opportunity to convert to an in-store cafe. Such as Madhappy and James Perse nearby
- Private Garage
- Multiple bathrooms

USE

FLAGSHIP RETAIL WITH CAFE,
CREATIVE SHOWROOM

SIZE

± 3,900 SQFT

RENT

AVAILABLE UPON REQUEST



An architectural masterpiece designed with tall arched ceilings and superior finishes including natural woods and stones throughout the space. Abundant natural light and private outdoor patio. Ideal for flagship retail boutique with an in-house coffee or cafe experience.

AVAILABILITY

IMMEDIATELY

PARKING

PRIVATE GARAGE
50 PARKING SPOTS BEHIND THE BUILDING



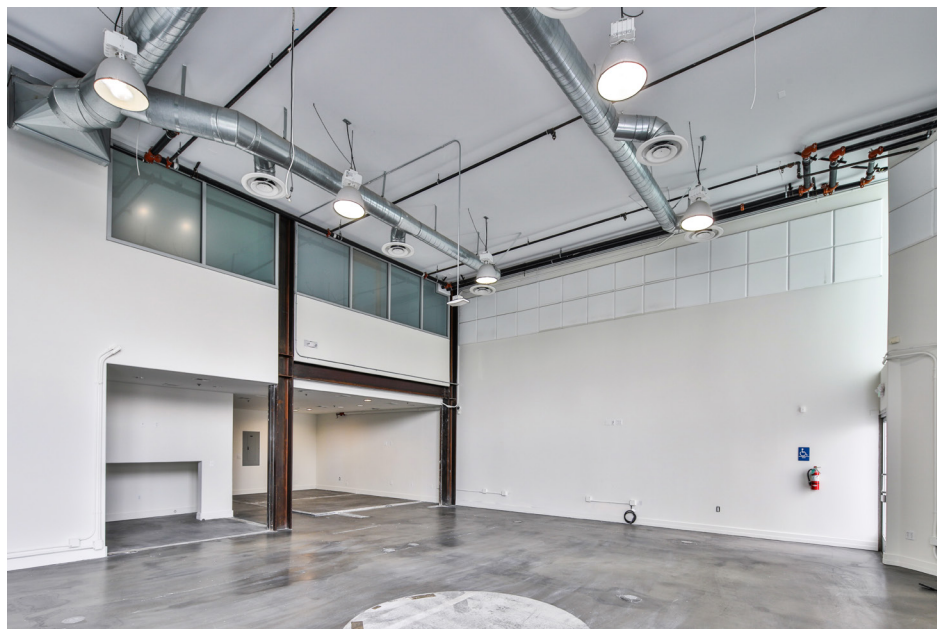



Floor Plan

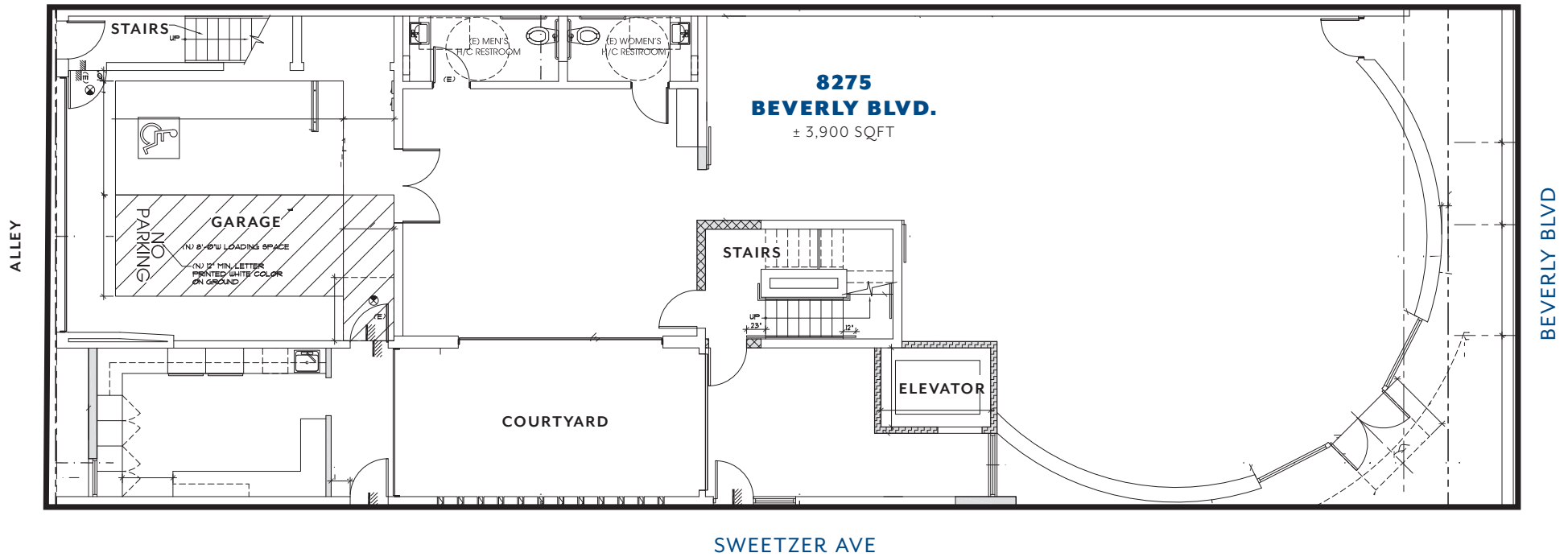

Map Overview



Neighboring Tenants



115 FT BLUE BOTTLE COFFEE

A specialty coffee company that honors your refined taste. Whether you gravitate toward bold blends, balanced profiles, or bright single origins, we're here to guide you toward your perfect cup—no matter your coffee mood. And if you're still discovering what you love, we'll help you find it, one delicious sip at a time.

-Blue Bottle Coffee



115 FT BACKYARD BOWLS

Backyard Bowls is a revolutionary eatery specializing in acai bowls, hot porridges, smoothies, and more. We provide a healthy, delicious, high-quality and fast meal option while striving to be conscientious of our local community and minimize our earthly impact. -Backyard Bowls

Contact



JACK RAVAN

Tel - 323-782-1270

jackravan@southparkgroup.com

DRE LICENSE #00890189

SASHA SOOFER

Tel - 424-888-3695

sasha@southparkgroup.com

DRE License #02221169