



CUSHMAN &
WAKEFIELD

G | I | D
INDUSTRIAL

FOR LEASE

2005 GANDY BLVD. N SUITE D

St. Petersburg, FL 33702

46,008 SF AVAILABLE



CONTACT US:

JOHN JACKSON, CCIM, SIOR

Executive Director
+1 727 643 7316
john.jackson@cushwake.com

JT FAIRCLOTH, SIOR

Senior Director
+1 813 833 3242
jt.faircloth@cushwake.com

CASEY PERRY

Director
+1 813 233 6564
casey.g.perry@cushwake.com



2005 GANDY BLVD. N



PROPERTY HIGHLIGHTS

SF Total	46,008 SF
Warehouse:	33,834 SF
Office/Breakroom:	12,174 SF
Loading:	- Three (3) Dock High Doors w/ Pit Levelers - One (1) Ramp
Air-Conditioning:	100%
Power:	1280a, 277/480v, 3 phase
Column Spacing:	40' x 44'
Construction Type:	Tilt-Wall
Clear Height:	28.1'
Sprinkler System:	ESFR
Unreserved Parking Ratio:	1.98/1000 SF
Available:	Now



FLOOR PLAN

2005 Gandy Blvd. N

46,008 SF

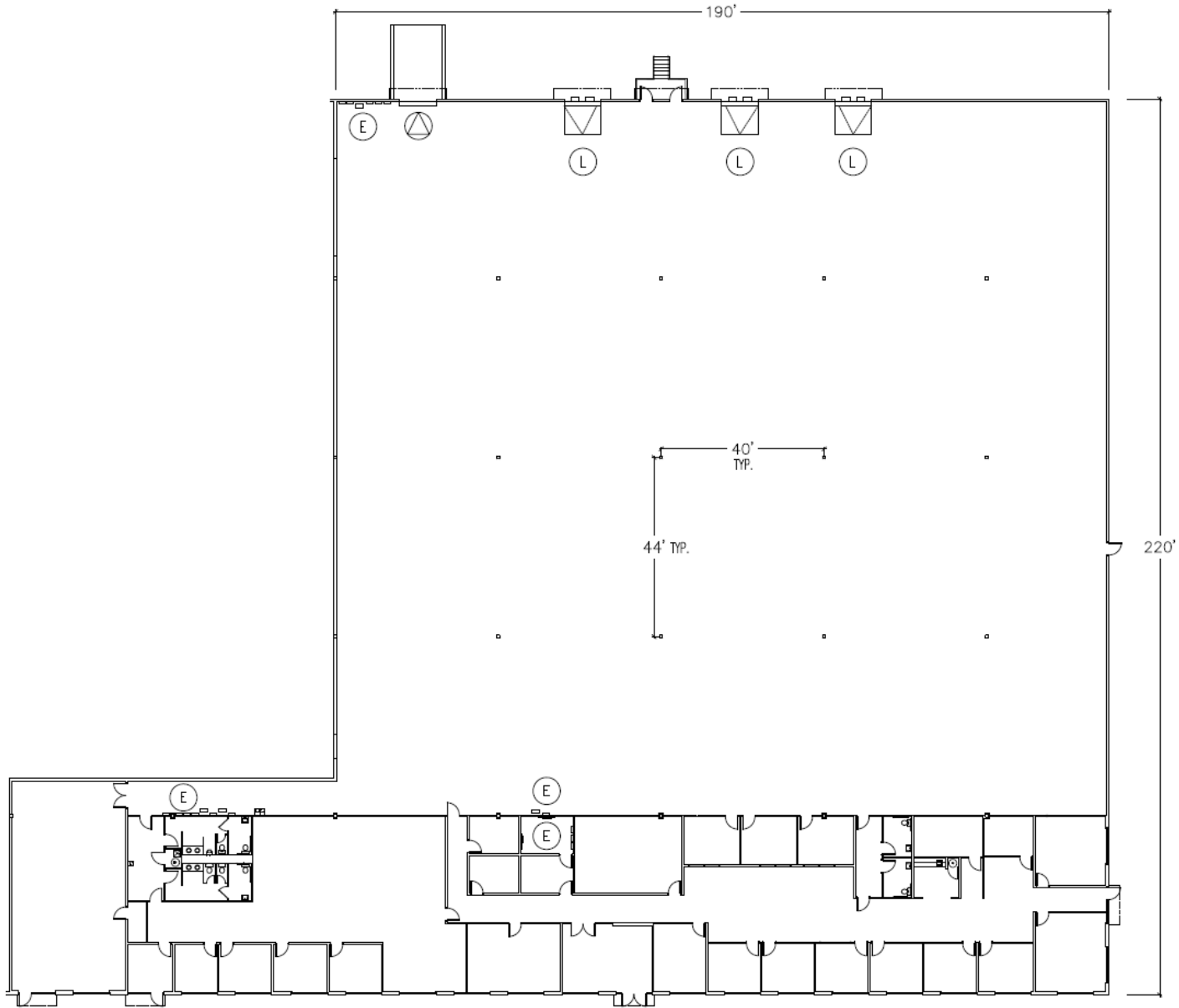

LOCATION





**DOWNTOWN
ST. PETERSBURG**

Contact Information

JOHN JACKSON, CCIM, SIOR
Executive Director
+1 727 643 7316
john.jackson@cushwake.com

JT FAIRCLOTH, SIOR
Senior Director
+1 813 833 3242
jt.faircloth@cushwake.com

CASEY PERRY
Director
+1 813 233 6564
casey.g.perry@cushwake.com

©2026 Cushman & Wakefield. All rights reserved. The information contained in this communication is strictly confidential. This information has been obtained from sources believed to be reliable but has not been verified. NO WARRANTY OR REPRESENTATION, EXPRESS OR IMPLIED, IS MADE AS TO THE CONDITION OF THE PROPERTY (OR PROPERTIES) REFERENCED HEREIN OR AS TO THE ACCURACY OR COMPLETENESS OF THE INFORMATION CONTAINED HEREIN, AND SAME IS SUBMITTED SUBJECT TO ERRORS, OMISSIONS, CHANGE OF PRICE, RENTAL OR OTHER CONDITIONS, WITHDRAWAL WITHOUT NOTICE, AND TO ANY SPECIAL LISTING CONDITIONS IMPOSED BY THE PROPERTY OWNER(S). ANY PROJECTIONS, OPINIONS OR ESTIMATES ARE SUBJECT TO UNCERTAINTY AND DO NOT SIGNIFY CURRENT OR FUTURE PROPERTY PERFORMANCE.

