

Crane Building, London, SE1 0NZ

The Crane Building is conceptually and stylistically designed, with well-proportioned exterior and interior details. With its extraordinarily high ceilings and openness, the reception area commands attention on the street. The finishes are simple and durable, with an attractive palette chosen to complement the building's overall contemporary style. The fourth level has an abundance of natural light and services that allow for efficient and economical use of the area.

 EPC Rating: A



24hr access



Air-con



Lounge area



Disabled access



Event space



Furnished



Kitchen



Lifts



Meeting rooms



Plants



Wi-fi



Image gallery

[More Images](#)

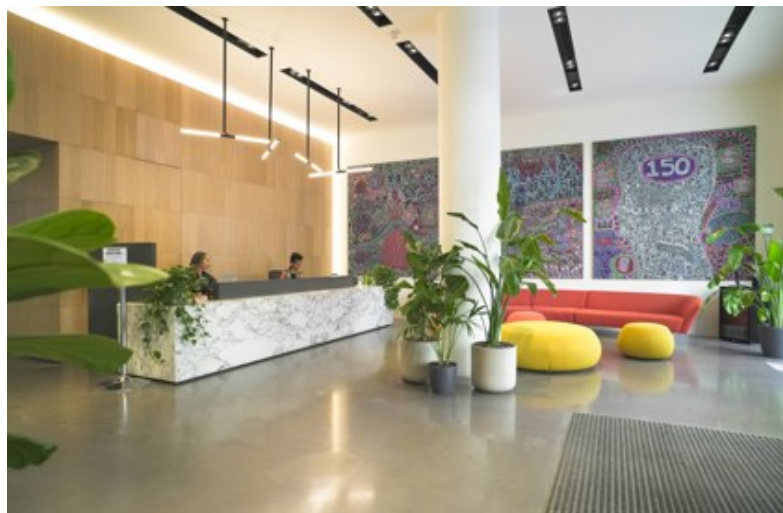

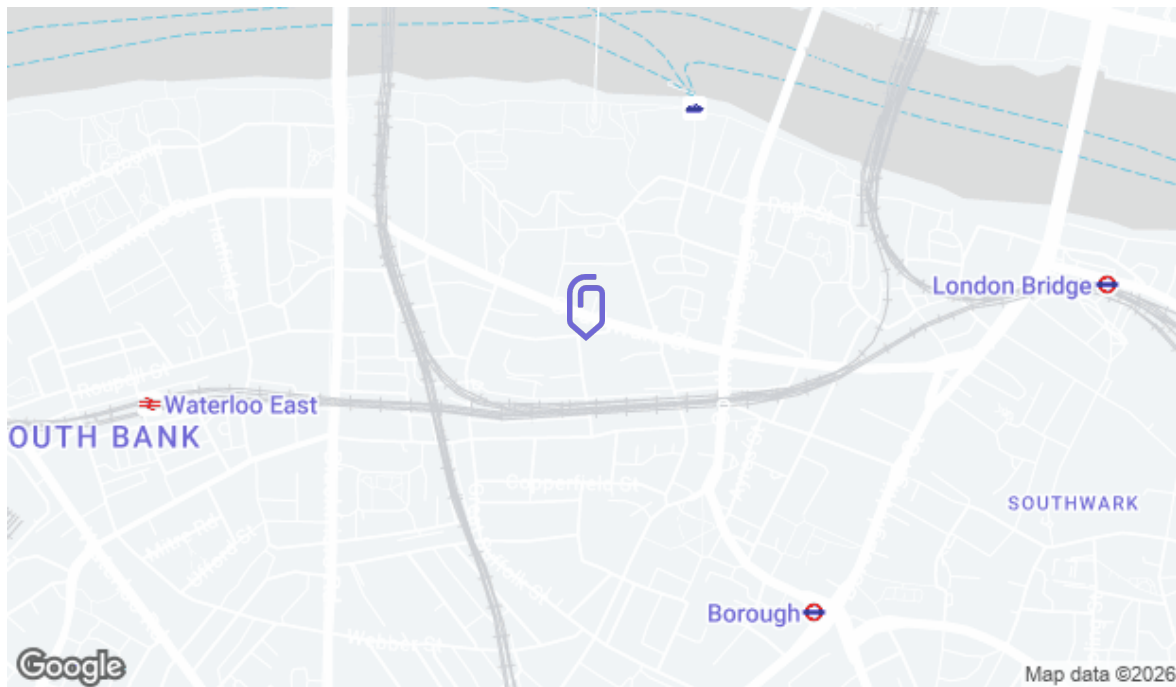

Nearest transport

subway_station

Southwark
9 minute walk

train_station

Waterloo East
14 minute walk

Why we love...

Dorrington strives to make their buildings special and focus on creating a fantastic working environment for occupiers with the addition of best-in-class facilities!



Mailat

Landlord Advisory, Workthere



Dan Brown

Co-Head of Workthere UK

✉ dan.brown@workthere.com

☎ 07710 249297



Holly Pollock

Senior Landlord Advisory

✉ holly.pollock@workthere.com

☎ 07946 609706



Mia Boughen

Landlord Advisory

✉ mia.boughen@workthere.com

☎ 07974 497467

Floor Information

[Download floorplan](#)

	Monthly price	Max Desks	Size (sqft)	Price per sqft	Availability	Term
4th Floor (unit B)	£22,910	35	1,571	£175	14-16 weeks	24+ months