

111 GREAT NECK ROAD

GREAT NECK, NEW YORK



Office Space Available for Lease

Introducing "**The Towers**": Premier Class A Office Building.

Nestled in a prime location, "**The Towers**" presents an exemplary embodiment of sophisticated office environments. These distinguished offices, renowned for its architectural elegance, offers unparalleled amenities and strategic advantages for discerning professionals.

Elegant Modernity: Step into the realm of contemporary sophistication with "The Towers." A grandiose modern lobby greets visitors, setting the tone for an unparalleled professional experience. The meticulously designed interiors exude refinement and class, elevating the workplace ambiance to new heights of prestige.

Convenient Accessibility: Convenience is paramount at "The Towers." Situated in close proximity to the Long Island Rail Road (LIRR) station, a mere 20-minute commute to Manhattan, accessibility is unrivaled. With ample parking available on both ground and subterranean levels, commuting is streamlined for tenants and visitors alike. The building also offers a cafe on the first floor.



ROZITA SOOMEKH

Licensed Real Estate Broker

Rozita.Soomekh@elliman.com

516.344.7185



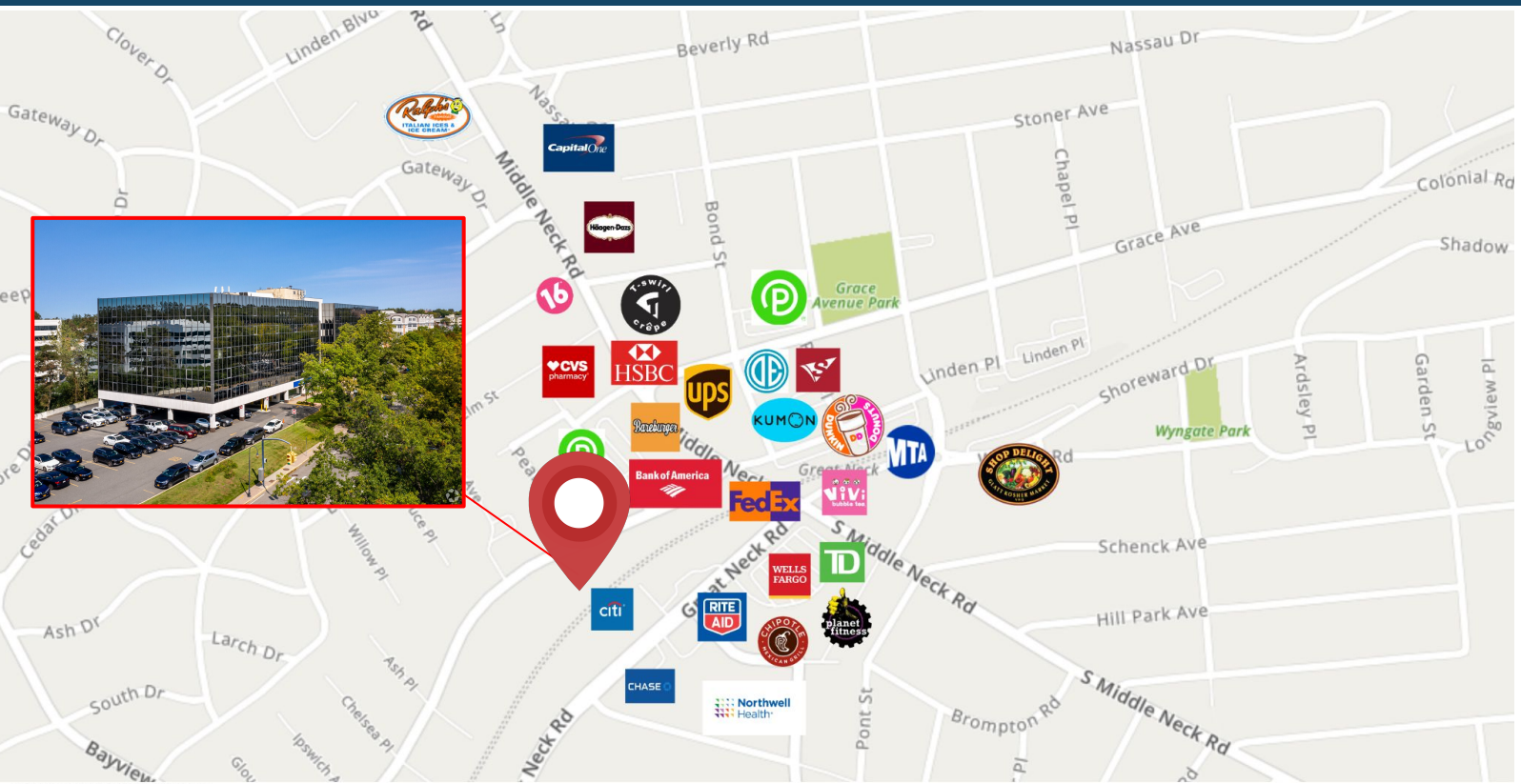

OTHER NOTABLE BUSINESSES IN THE AREA



Available Units - All Utilities, Wifi & Parking
Included (Per Month)

201-B \$ 950

201-C \$ 850 (Sublease 8/31/27)

THE ROZITA SOOMEKH TEAM
at Douglas Elliman
Real Estate

ROZITA SOOMEKH
Licensed Real Estate Broker
Rozita.Soomekh@elliman.com
516.344.7185



NEW Carpet, Lighting, Paint, and Furniture.

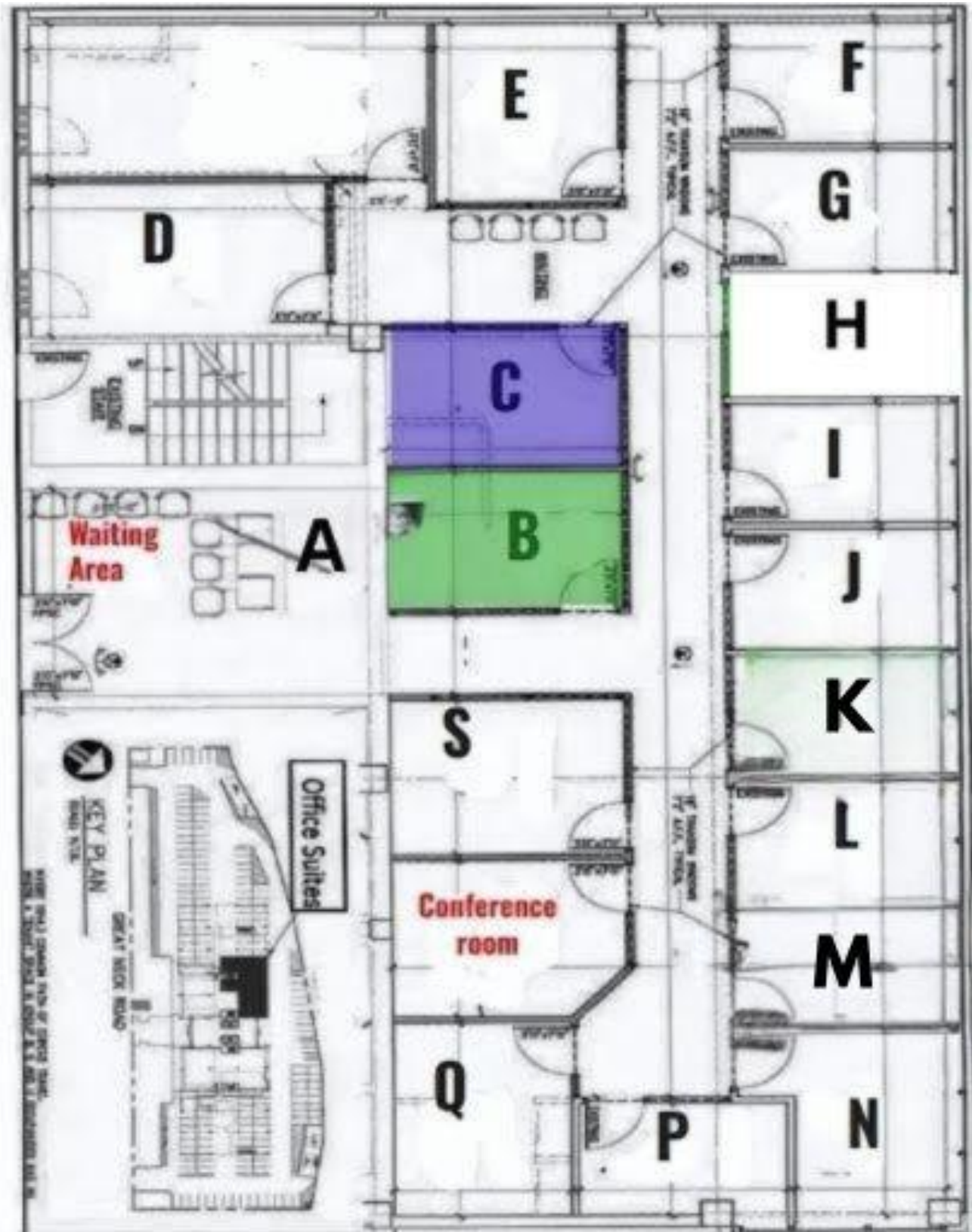

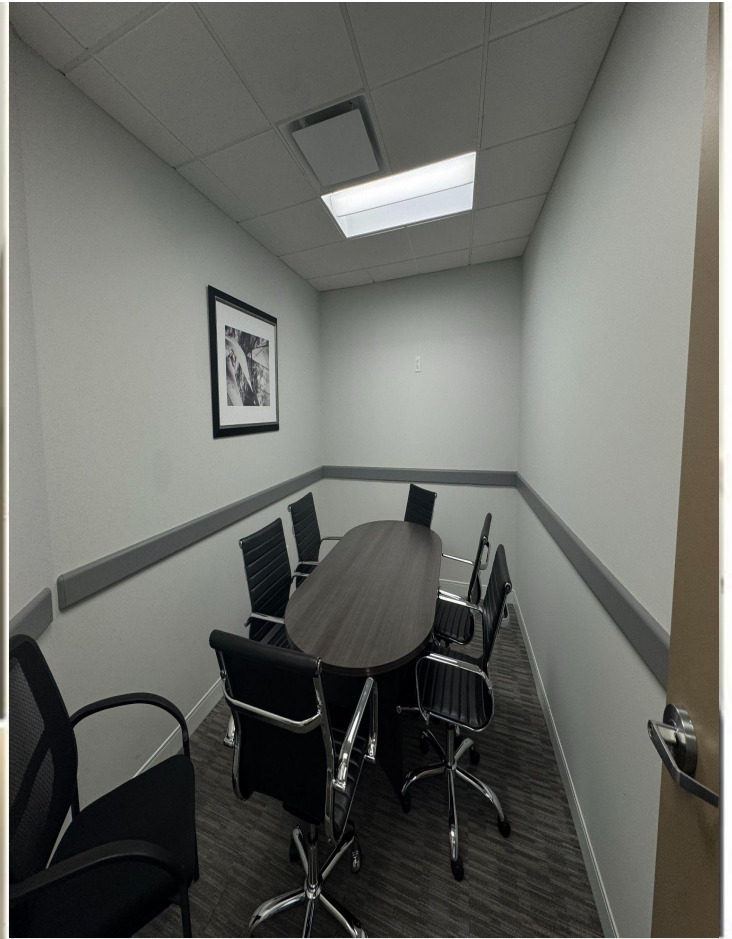

 **THE
ROZITA
SOOMEKH
TEAM** at Douglas Elliman
Real Estate

ROZITA SOOMEKH
Licensed Real Estate Broker
Rozita.Soomekh@elliman.com
516.344.7185



GREAT NECK

NEW YORK



Great Neck is a region on Long Island, New York, that covers a peninsula on the North Shore and includes 9 villages, such as the villages of Great Neck, Great Neck Estates, Great Neck Plaza, Kings Point, and Russell Gardens, and a number of unincorporated areas, as well as an area south of the peninsula near Lake Success and the border territory of Queens.

Age Demographic

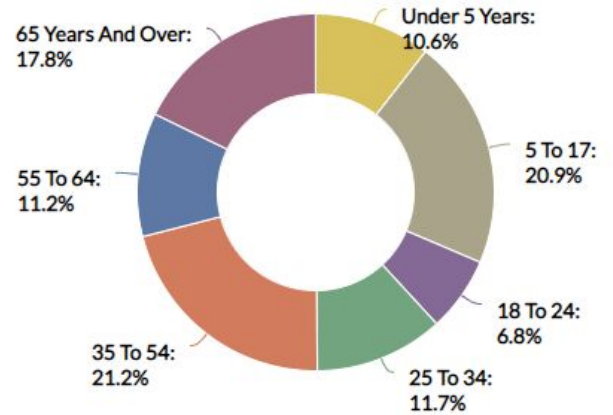

TOTAL POPULATION

±11,000

MEDIAN HOUSEHOLD INCOME



SCAN TO VIEW
ALL OUR LISTINGS

