

FOR LEASE

FIRST CLASS INDUSTRIAL/OFFICE BAYS

NAICommercial



280 TAIGANOVA CRESCENT | FORT MCMURRAY, AB

PROPERTY DESCRIPTION

- A unique opportunity to lease well improved north Fort McMurray office/warehouse bay
- 3,225 sq.ft. to 6,384 sq.ft.
- 12'x16' grade overhead doors with 22' ceilings
- Convenient proximity to Highway 63 and populated residential neighbourhoods
- Immediate availabilities



FLEXIBLE SPACE
CONFIGURATIONS



PAVED PARKING



WELL POSITIONED
TAIGANOVA LOCATION



GRADE LOADING
DOORS

CONOR CLARKE

Associate
587 635 2480
cclarke@naiedmonton.com

RYAN BROWN

Partner
587 635 2486
rbrown@naiedmonton.com

CHAD GRIFFITHS

Partner
780 436 7414
cgriffiths@naiedmonton.com

DREW JOSLIN

Associate
780 540 9100
djoslin@naiedmonton.com



NAI COMMERCIAL REAL ESTATE INC.
4601 99 STREET NW, EDMONTON AB, T6E 4Y1



780 436 7410



NAIEDMONTON.COM

PROPERTY INFORMATION

LEGAL ADDRESS	Plan 1021463, Block 1, Lot 9A
SITE SIZE	3.77 Acres±
AVAILABLE AREA	Building 1: Bay 9 - 3,225 SF± Building 2: Bay 41 - 6,384 sqft Building 3: 3,225 SF± - 6,450 SF± LEASED
ZONING	BI - Business Industrial
LOADING	12'x16' Grade Doors
CEILING HEIGHT	22'
PROPERTY IMPROVEMENTS	<ul style="list-style-type: none"> - Abundant natural light - Paved parking - Flexible demising options - Fully improved office space - Telus Fibre Optics onsite - Professional building management
AVAILABILITY	60 days notice
LEASE RATE	Market
OPERATING COSTS	\$7.00/sq.ft./annum (2026) Includes property taxes, building insurance, common area maintenance and management fees



BAY 9



BAY 9



BAY 41



BAY 41



BAY 41



BAY 41



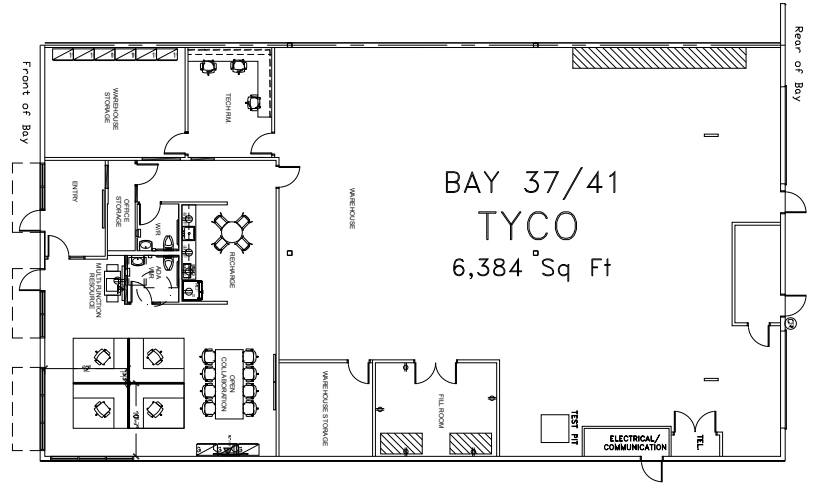
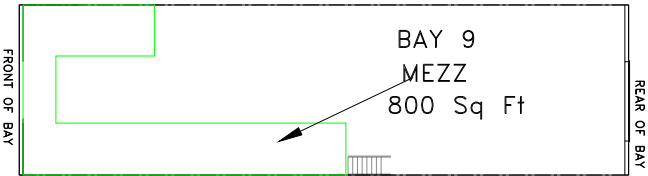
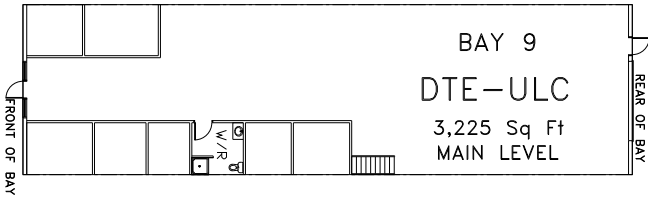

TAIGANOVA CRESCENT

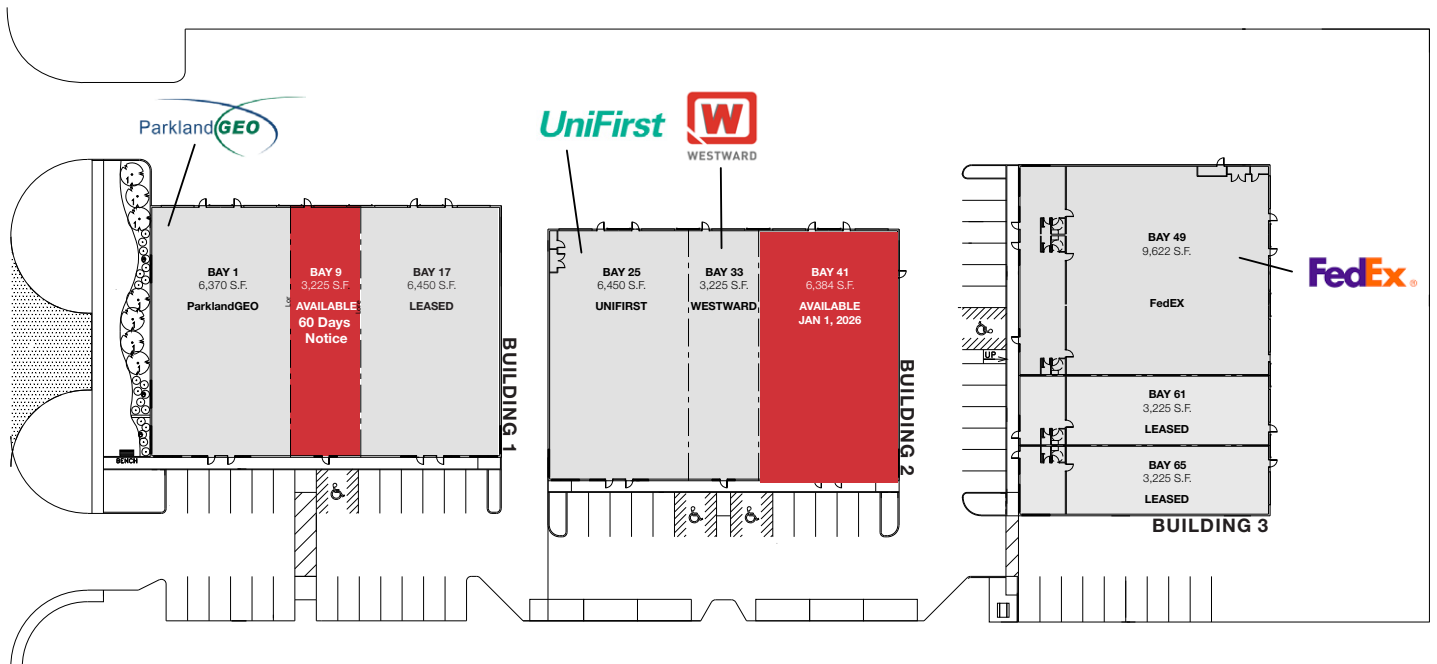

CONOR CLARKE

Associate
587 635 2480
cclarke@naiedmonton.com

RYAN BROWN

Partner
587 635 2486
rbrown@naiedmonton.com

CHAD GRIFFITHS

Partner
780 436 7414
cgriffiths@naiedmonton.com

DREW JOSLIN

Associate
780 540 9100
djoslin@naiedmonton.com



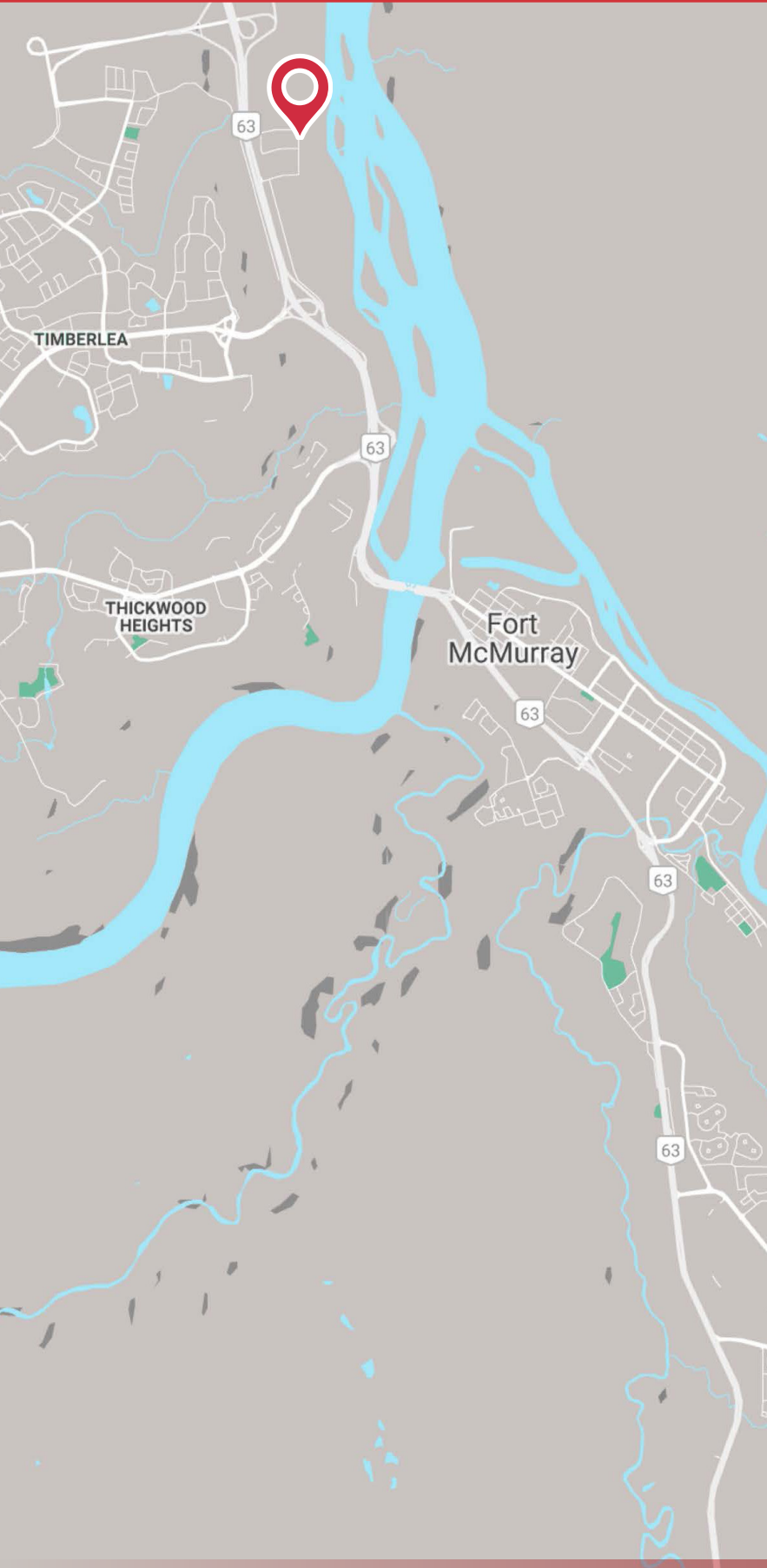

WELL LOCATED WAREHOUSE WITH IMPROVED OFFICE BAYS

Located in the coveted TaigaNova Eco-Industrial Park in north Fort McMurray, 280 TaigaNova Crescent is a multi-tenant complex on a 3.77 acre site improved with three office/warehouse buildings. The property has convenient proximity to Highway 63 as well as the neighborhoods containing the majority of Fort McMurray's population.

Building features include grade doors, paved parking, improved office space, high ceilings, and abundant natural light.

OFFERING HIGHLIGHTS INCLUDE

- Contiguous bay space from 3,225 sq.ft. to 6,384 sq.ft.
- One grade door per 3,225 SF± bay
- Immediate availabilities

DEMOGRAPHICS

(5km radius, 2023 Costar)

POPULATION: 39,040

Age	Income		
0-19	11,451	Average household income	\$250,169
20-34	7,912	# of households that earn more than \$100,000	10,861
35-54	14,389		
55+	5,288	# of households that earn between \$60,000 to \$100,000	992
MEDIAN	35.2		



FOR LEASE

FIRST CLASS INDUSTRIAL/OFFICE BAYS

280 TAIGANOVA CRES | FORT MCMURRAY, AB



CONOR CLARKE

Associate
587 635 2480
cclarke@naiedmonton.com

RYAN BROWN

Partner
587 635 2486
rbrown@naiedmonton.com

CHAD GRIFFITHS

Partner
780 436 7414
cgriffiths@naiedmonton.com

DREW JOSLIN

Associate
780 540 9100
djoslin@naiedmonton.com



BAY 9



NAI COMMERCIAL REAL ESTATE INC.
4601 99 STREET NW, EDMONTON AB, T6E 4Y1



780 436 7410



NAIEDMONTON.COM

7238-A RB24