

# FOR LEASE | ±7,497 SF

815 HINDRY AVE & 1001 ARBOR VITAE ST | INGLEWOOD | CA



## PROPERTY FEATURES

- Small Industrial Campus
- Three (3) Freestanding Buildings
- Minimal Amount of Office Space
- ±12'–14' Warehouse Clearance
- Two (2) Ground-Level Doors (Potential to Add More)
- 400 Amps of Power (Verify)
- Gated and Secure, Fenced Yard
- Rate: \$1.65N + \$0.13 Nets
- Excellent Corner Location
- Zoned M1 (Light Manufacturing) with C2A, C-3, and C-S Overlay Zoning
- Directly Across from LAX People Mover



**PAUL CAPUTO, MBA**  
Senior Vice President  
714.935.2332  
Lic. #01196935  
PCaputo@voitco.com



**TRAVIS FORSTER**  
Senior Vice President  
949.263.5332  
Lic. #01935471  
TForster@voitco.com

**Voit**  
REAL ESTATE SERVICE



Current Listings

SITE PLAN

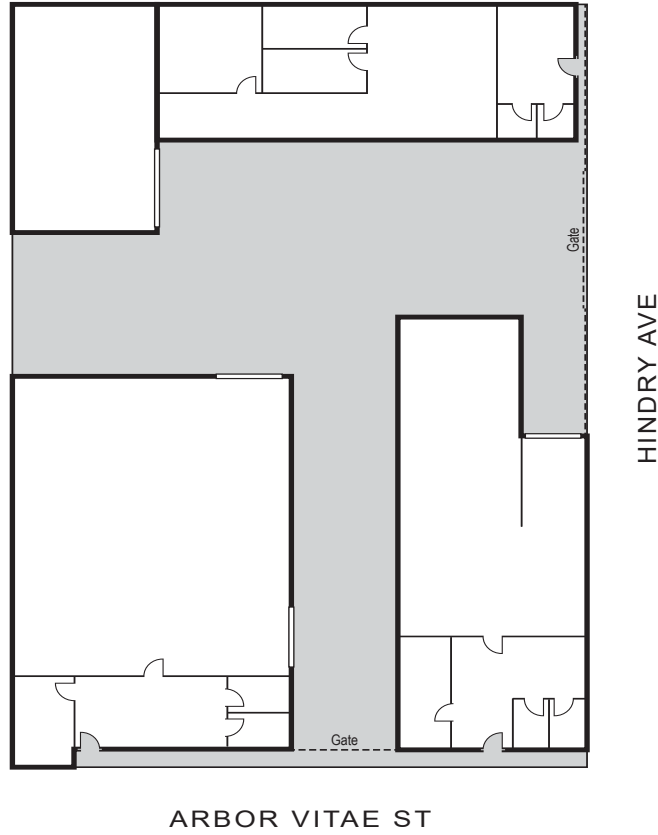

EXCLUSIVELY OFFERED BY:

**Voit**

REAL ESTATE SERVICES



**PAUL CAPUTO, MBA**

Senior Vice President

714.935.2332

Lic. #01196935

PCaputo@voitco.com



**TRAVIS FORSTER**

Senior Vice President

949.263.5332

Lic. #01935471

TForster@voitco.com