



**ARES  
INDUSTRIAL  
MANAGEMENT**

# RIALTO COMMERCE CENTER II

436 W. RIALTO AVENUE, RIALTO, CA 92376

FOR LEASE | ±294,304 SQ FT | Class A Warehouse Facility



[ARESRIALTOII.COM](http://ARESRIALTOII.COM)

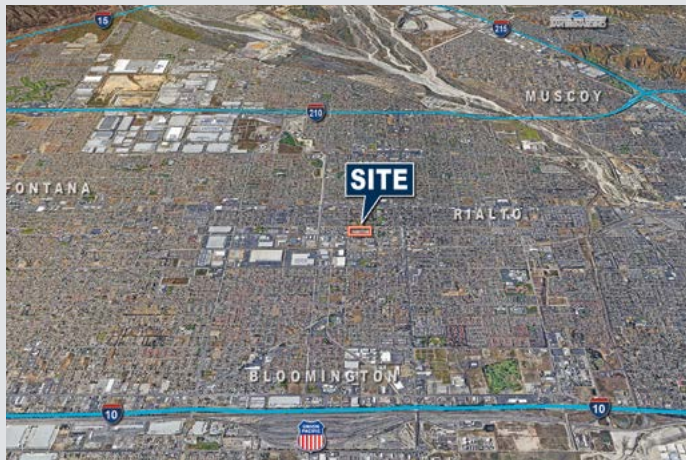

## BUILDING HIGHLIGHTS

- ±294,304 SF Building
- ±5,364 SF Office
- 40' Ceiling Height
- ESFR Sprinkler System with K-25 Heads at 50 PSI
- 38 (9' x 10') Dock High Doors
  - Ten (10) Doors with 35,000 lbs Pit Levelers
- 2 (12' x 14') Grade Level Doors
- 2,000 amp service with 4,000 amp UGPS (verify)
- ±185' Truck Court
- 199 Auto Parking Stalls
- 59 Additional Trailer Parking Stalls
- Secured Private Yard
- Spec LED Warehouse Lighting

**JUAN GUTIERREZ, SIOR**  
Executive Vice President/Partner  
jgutierrez@voitco.com  
909-545-8008  
Lic.#01777990

**RYAN LAL, SIOR**  
Senior Vice President/Partner  
rlal@voitco.com  
909-545-8020  
Lic.#01854104

**Voit**  
REAL ESTATE SERVICES



ARES  
INDUSTRIAL  
MANAGEMENT

# RIALTO COMMERCE CENTER II

436 W. RIALTO AVENUE, RIALTO, CA 92376

FOR LEASE | ±294,304 SQ FT | Class A Warehouse Facility

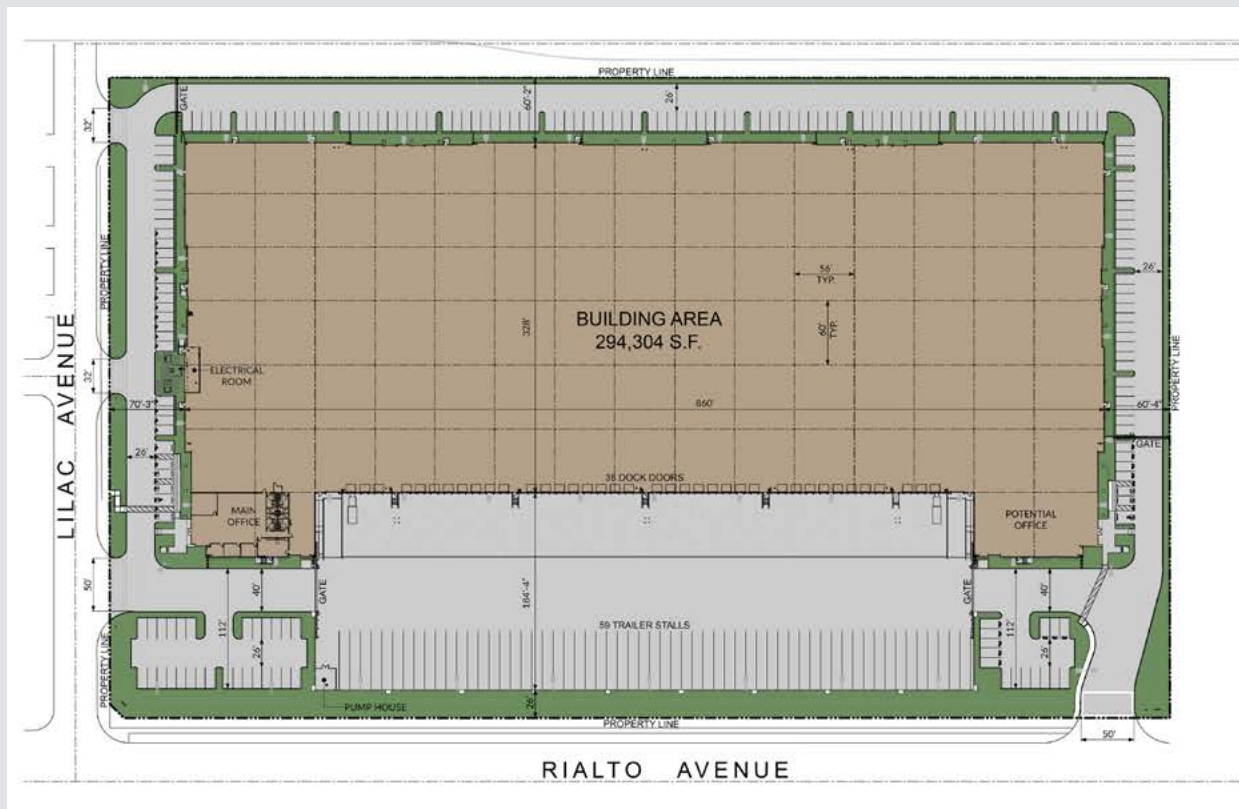

**JUAN GUTIERREZ, SIOR**  
Executive Vice President/Partner  
jgutierrez@voitco.com  
909-545-8008  
Lic.#01777990

**RYAN LAL, SIOR**  
Senior Vice President/Partner  
rlal@voitco.com  
909-545-8020  
Lic.#01854104

**Voit**  
REAL ESTATE SERVICES



ARES  
INDUSTRIAL  
MANAGEMENT

# RIALTO COMMERCE CENTER II

436 W. RIALTO AVENUE, RIALTO, CA 92376

FOR LEASE | ±294,304 SQ FT | Class A Warehouse Facility



**JUAN GUTIERREZ, SIOR**  
Executive Vice President/Partner  
jgutierrez@voitco.com  
909-545-8008  
Lic.#01777990

**RYAN LAL, SIOR**  
Senior Vice President/Partner  
rlal@voitco.com  
909-545-8020  
Lic.#01854104

**Voit**  
REAL ESTATE SERVICES

