



FOR LEASE

1611/1613 Babcock Ave.
Newport Beach, CA

5,000 SF Industrial Unit

SITE HIGHLIGHTS:

- Business Park Environment
- West Newport Beach / Newport Mesa Location
- Access to the 55 Freeway / Newport Blvd.
- Retail & Restaurant Amenities Nearby
- Professional Property Management
- Zoning: IG General Industrial

UNIT FEATURES:

Fenced in YARD

Office Space: ±1,000 SF

- Window-Lined Storefront facing Babcock St.
- Reception + 4 Private Offices
- Heated/Air-Conditioned Office Areas
- Upgraded Flooring
- Recessed Lighting
- 2 Restrooms
- Built-in kitchenette w/ sink, counter, & cabinetry

Warehouse Space: ±4,000 SF

- Two 10' x 10' Ground-Level Doors
- ±12' Ceiling Height
- Space Heater
- Skylights Providing Natural Light
- 2 Restrooms

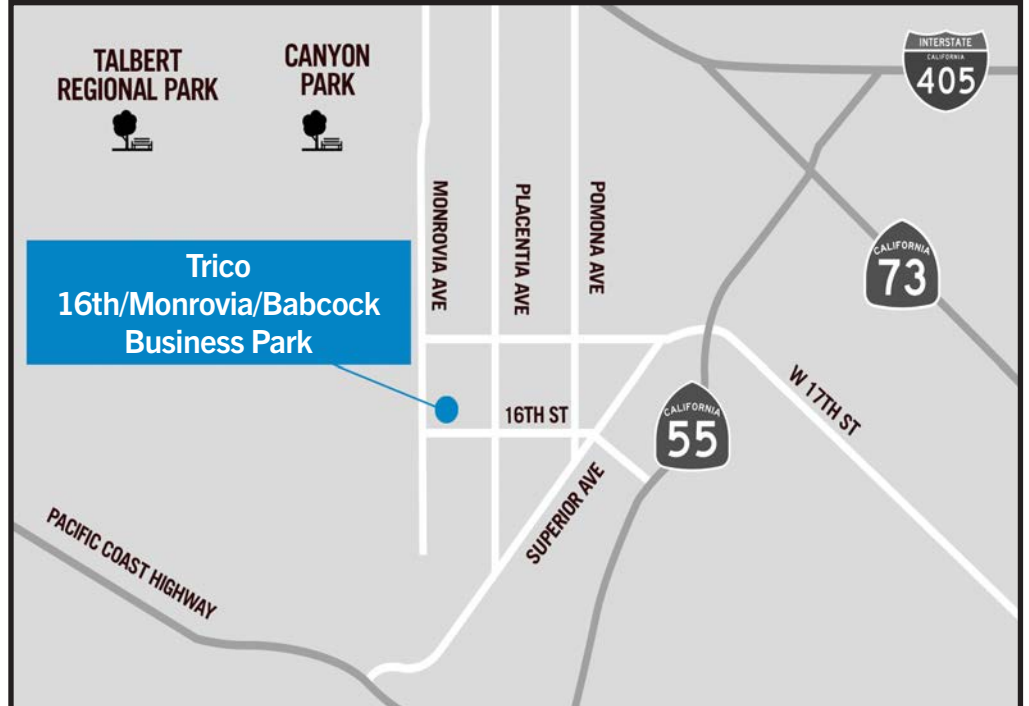

FOR FURTHER DETAILS:

PARKER ROBERTS

parker@tricoREALTY.com
License #01994597

This information has been furnished from sources which we deem reliable; however, we do not guarantee its accuracy and assume no liability. Do not rely on any of the information contained herein without verifying it yourself directly with the listing broker or owner.

Trico Realty, Inc.
License #00342120

3100-A Pullman Street
Costa Mesa, CA 92626

714-751-4420
TricoRealty.com



FOR LEASE

1611/1613 Babcock Ave.
Newport Beach, CA

5,000 SF Industrial Unit

Unit Features

Power: 400A | 120/240 (TBD)

Clearance Height: 12'

Ground Level Doors: Two 10'x10'

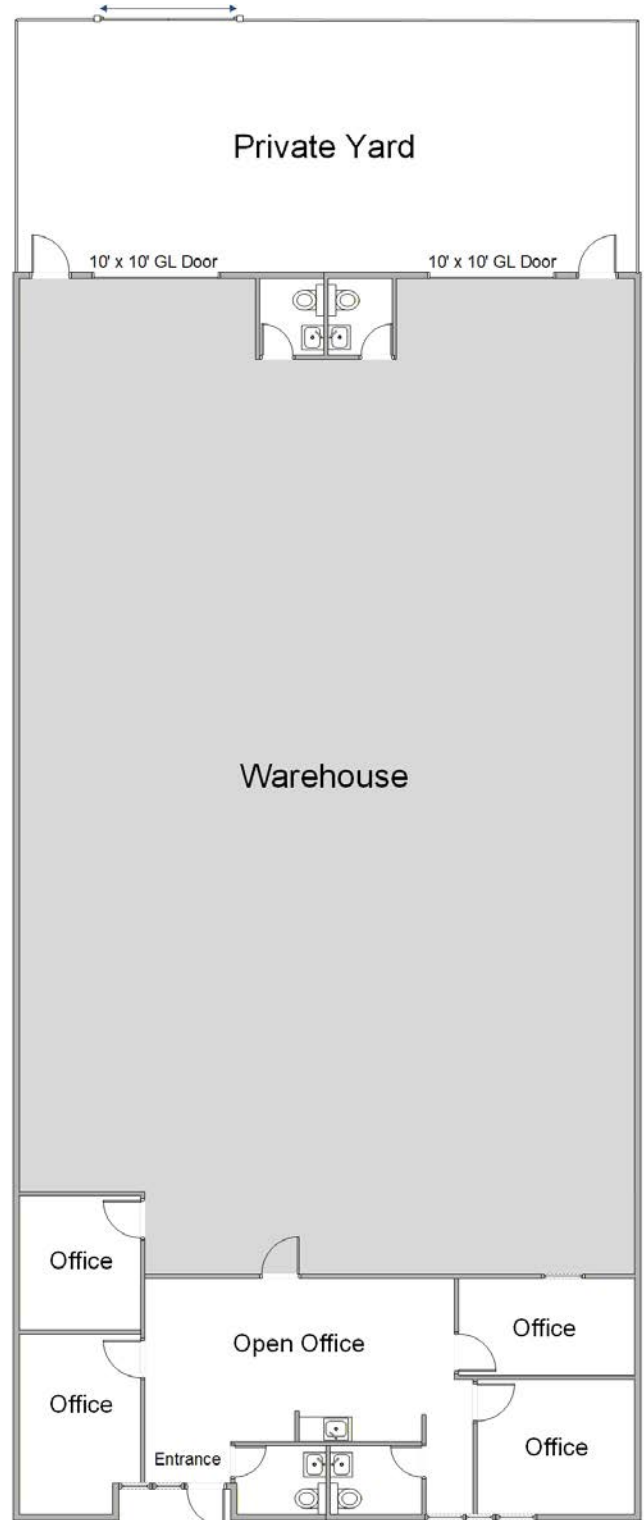
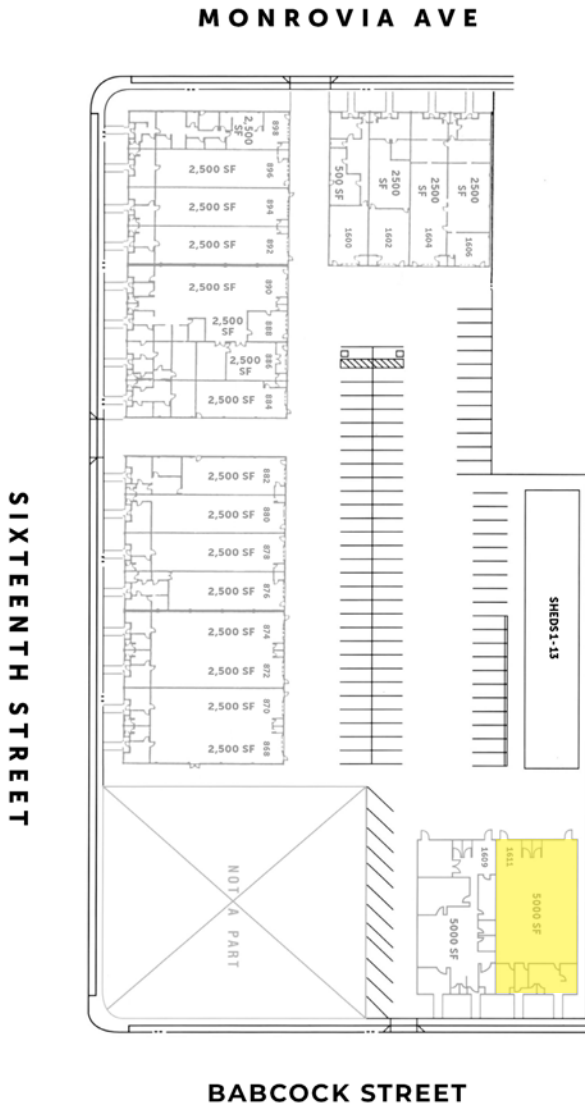

*Floorplans Not to Scale