



AVISON  
YOUNG



PENZANCE

450-485 SPRING PARK PLACE, HERNDON, VA



# A BOLD VISION YOU WON'T FIND ANYWHERE ELSE.

Penzance has created a unique offering targeting office and flex users in Herndon.

Marker 20 has rolled out bold plans on the Washington & Old Dominion Trail, including:

- On-site management, conference and fitness center (with lockers + showers)
- Activated tenant programming
- New outdoor recreation lounges
- Tree-lined pedestrian avenue
- Direct path access to the W&OD Trail
- Urban bike/walk/scooter trail access to area amenities
- 50+ retailers within a five-minute drive
- Short distance from Metro stations



# PERFECTLY POSITIONED BRIGHT, FLEXIBLE SPACES

It's rare to find space this flexible so close to Metro and urban retail centers. Marker 20 is a best-in-class portfolio with unparalleled transportation and convenience around every corner.

- Flexible layout sizes to accommodate any tenant
- Virtually column-free, with low core factor
- Visibility for corporate branding
- Secure individual suite entries
- Existing loading provides for unique design opportunities
- Existing data center infrastructure
- Multiple fiber providers in the park
- Ample parking at 3.6 per 1,000 sf



# BRAND NEW AMENITY SPACE

With a newly completed indoor/outdoor tenant lounge, state-of-the-art conference center and fitness center, Marker 20 sets itself apart from the competition.



# MINUTES TO DOWNTOWN

Enjoy a prime location adjacent to the Washington & Old Dominion Trail and within minutes to downtown Herndon + Reston Town Center.



**Strategically located** between popular biking destinations in **downtown Herndon** and **Reston Town Center**

Downtown Herndon  
Distance: 0.6 miles  
Bike: 2 minutes

Washington & Old Dominion Trail

Reston Town Center  
Distance: 1 mile  
Bike: 6 minutes

20  
MARKER

Herndon Metro  
Bike: 4 minutes

RTC Metro  
Bike: 6 minutes



# 455 SPRING PARK PLACE

- 1ST FLOOR // SUITE 300A // 6,278 SF
- 1ST FLOOR // SUITE 300B // 4,352 SF
- 1ST FLOOR // SUITE 350 // 6,459 SF

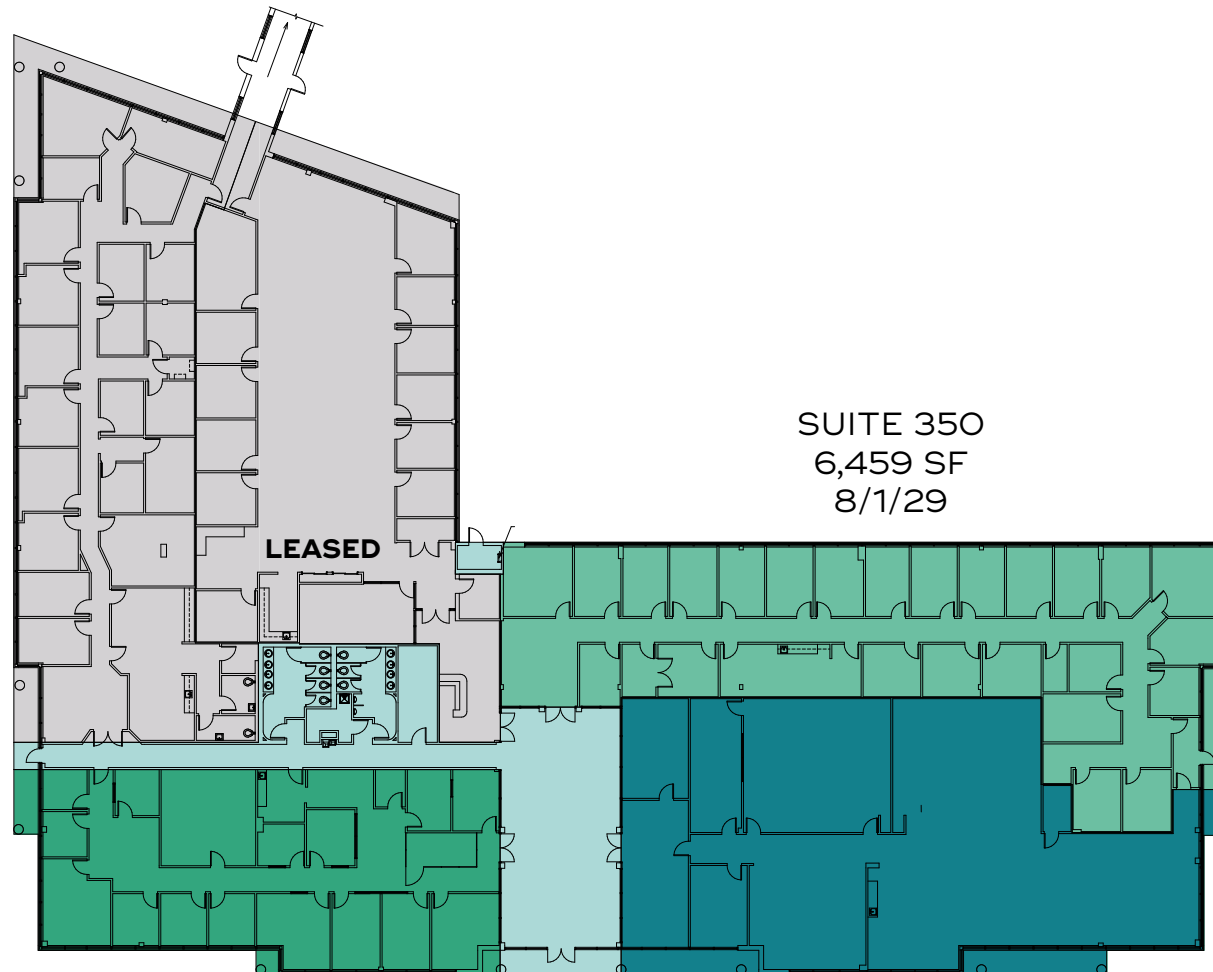

SUITE 350  
6,459 SF  
8/1/29

SUITE 300B  
4,352 SF

SUITE 300A  
6,278 SF

- LEASED
- COMMON AREA



20  
MARKER  
▼

450-485 SPRING PARK PLACE, HERNDON, VA



Mike Shuler, Principal  
703.760.9052  
mike.shuler@avisonyoung.com

Olivia Vietor, Vice President  
703.382.1982  
olivia.vietor@avisonyoung.com

[avisonyoung.com](http://avisonyoung.com)

703.288.2700 | © 2024. Avison Young. Information contained herein was obtained from sources deemed reliable and, while thought to be correct, have not been verified. Avison Young does not guarantee the accuracy or completeness of the information presented, nor assumes any responsibility or liability for any errors or omissions therein.