

SHOPPES OF WEST 192



5,670 SF 2ND GEN RESTAURANT

8057 W IRLO BRONSON MEMORIAL HWY, KISSIMMEE, FL 34747

PAYTON FOSTER
407-461-8080

ALEX BISBEE
407-864-6444

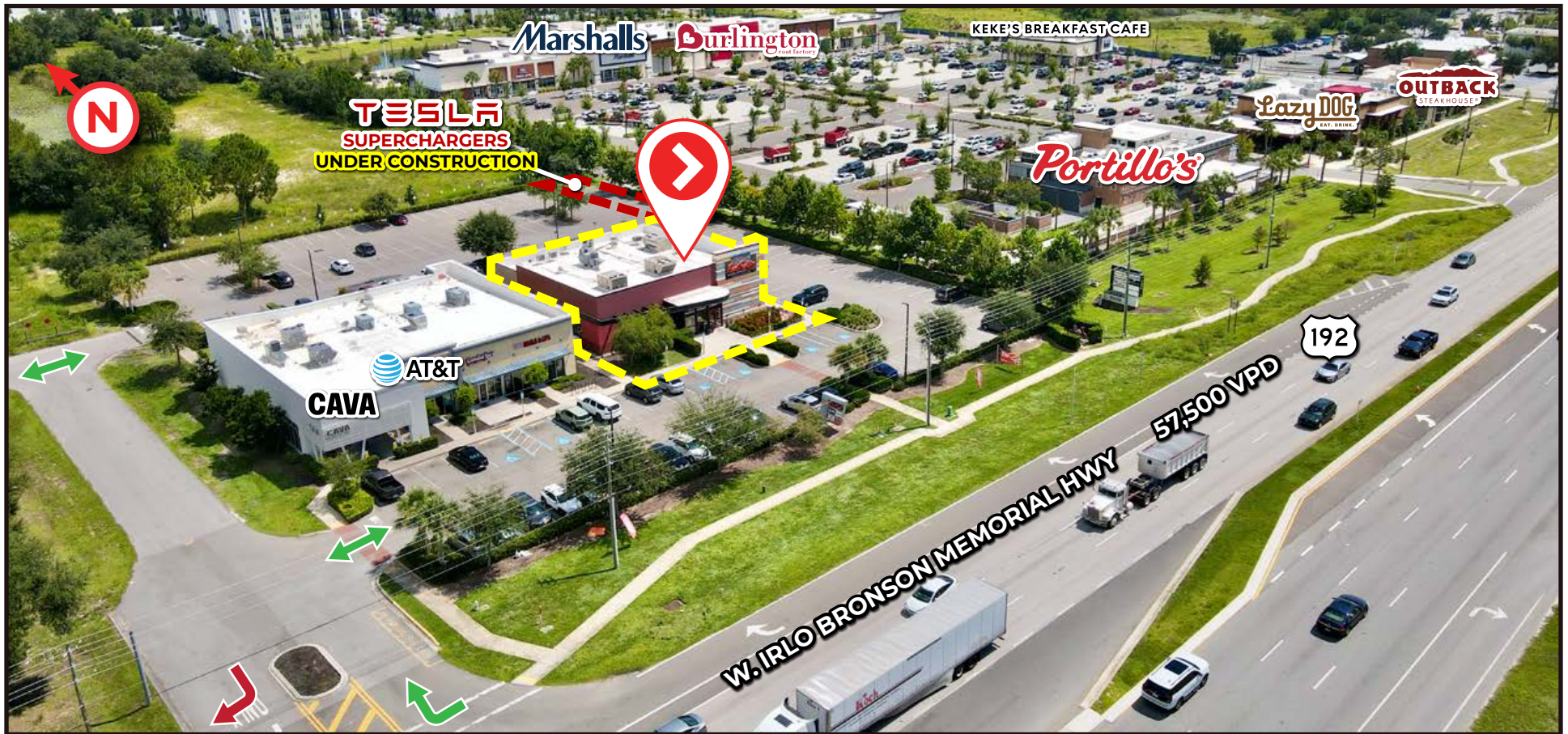

PROPERTY HIGHLIGHTS

- Current tenant is open and operating – please do not disturb.
- Freestanding 5,670 SF 2nd generation restaurant coming available for lease. 198 seats.
- Located near Orlando's top theme parks: Disney, Epcot, Animal Kingdom, Margaritaville, Magic Kingdom, and more.
- Prime location off of W. Irlo Bronson Hwy (192) and SR 429; one of the top retail trade areas in the Orlando MSA.
- Monument sign, ample parking, and cross access to lighted intersection.

2025 DEMOGRAPHICS



Population

1 Mile	1,533
3 Miles	25,447
5 Miles	86,711



Employees

1 Mile	1,894
3 Miles	8,449
5 Miles	23,156



Average Household Income

1 Mile	\$123,902
3 Miles	\$103,308
5 Miles	\$110,594



Households

1 Mile	520
3 Miles	9,355
5 Miles	33,185

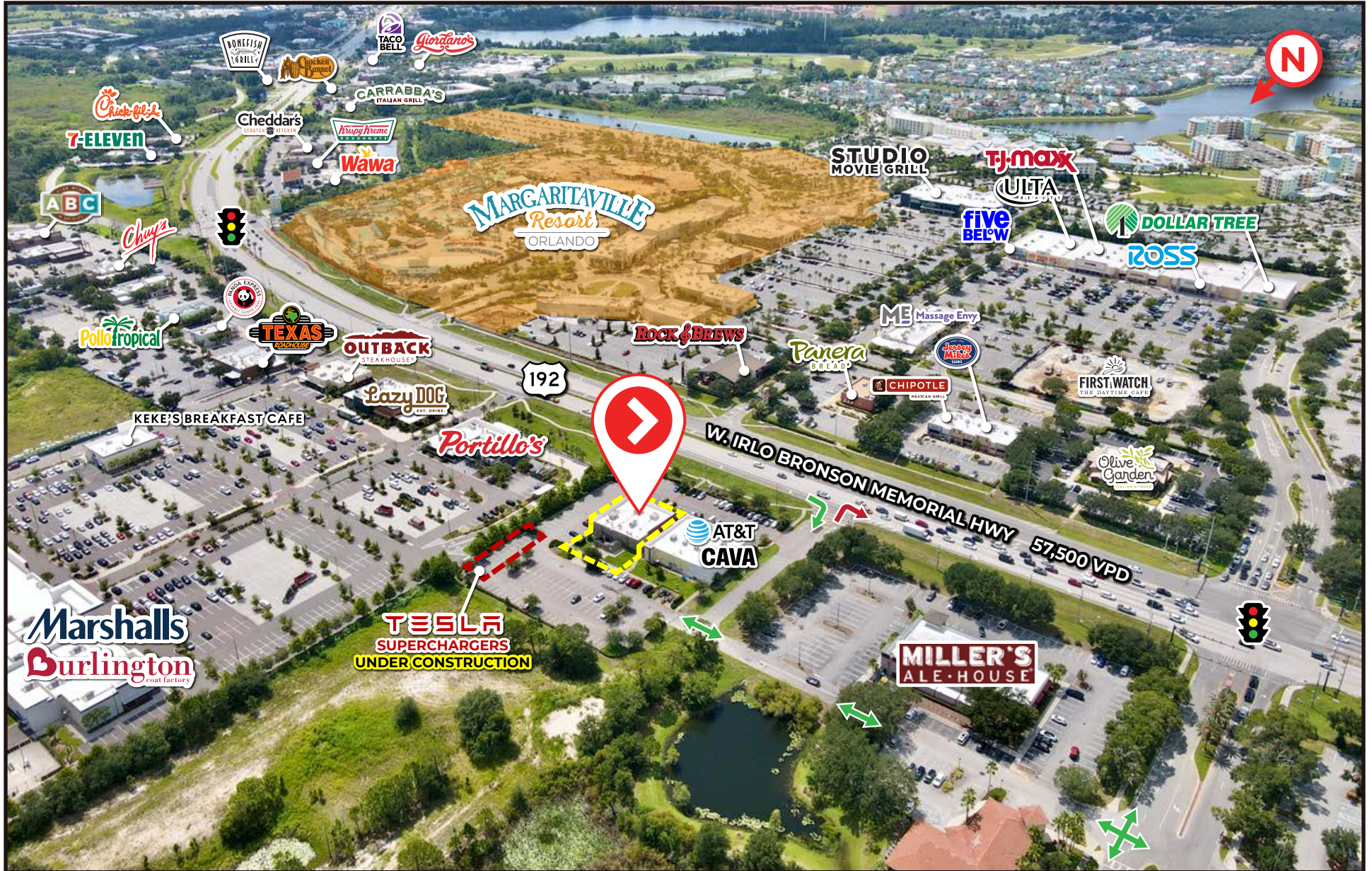





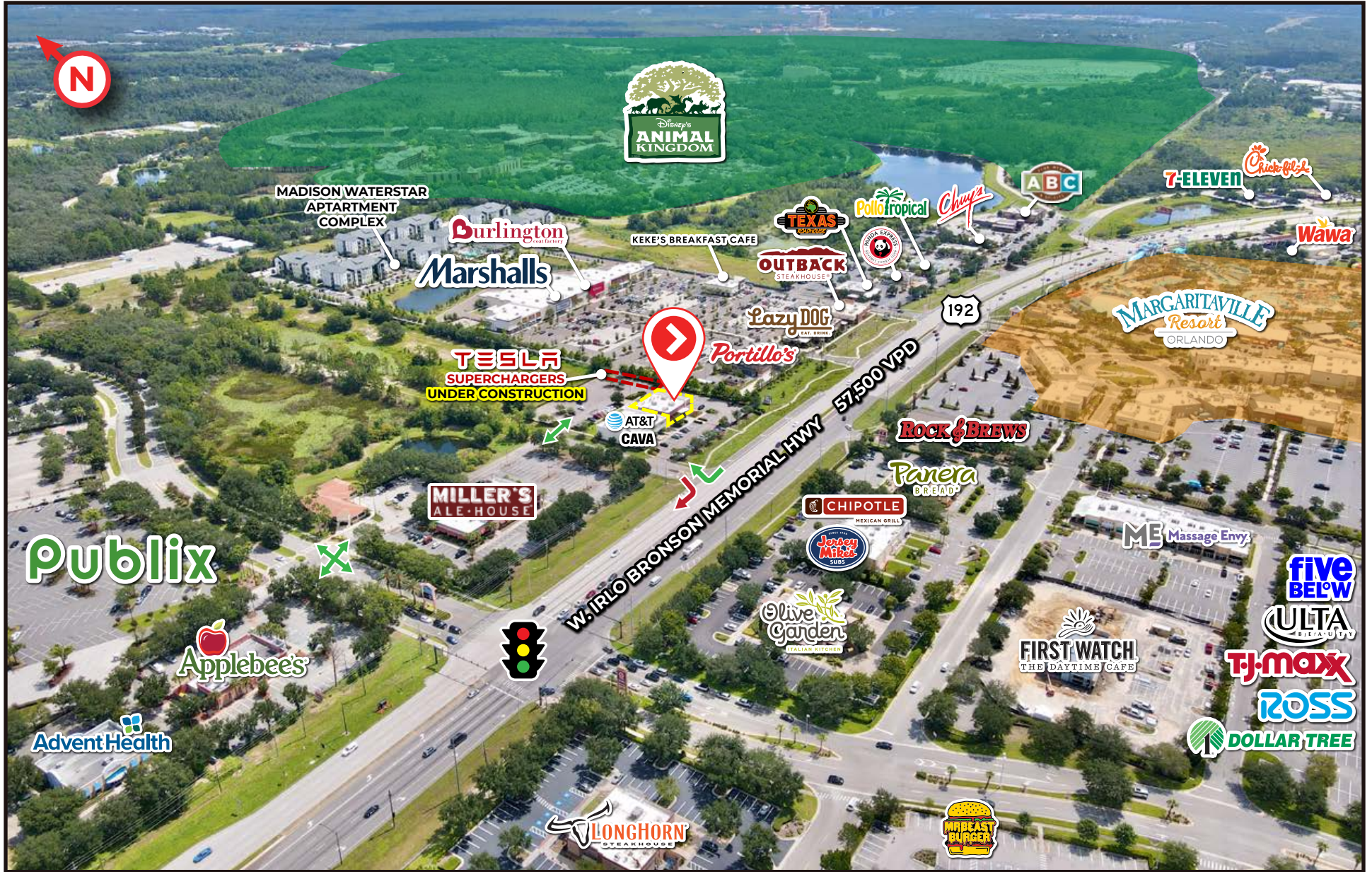

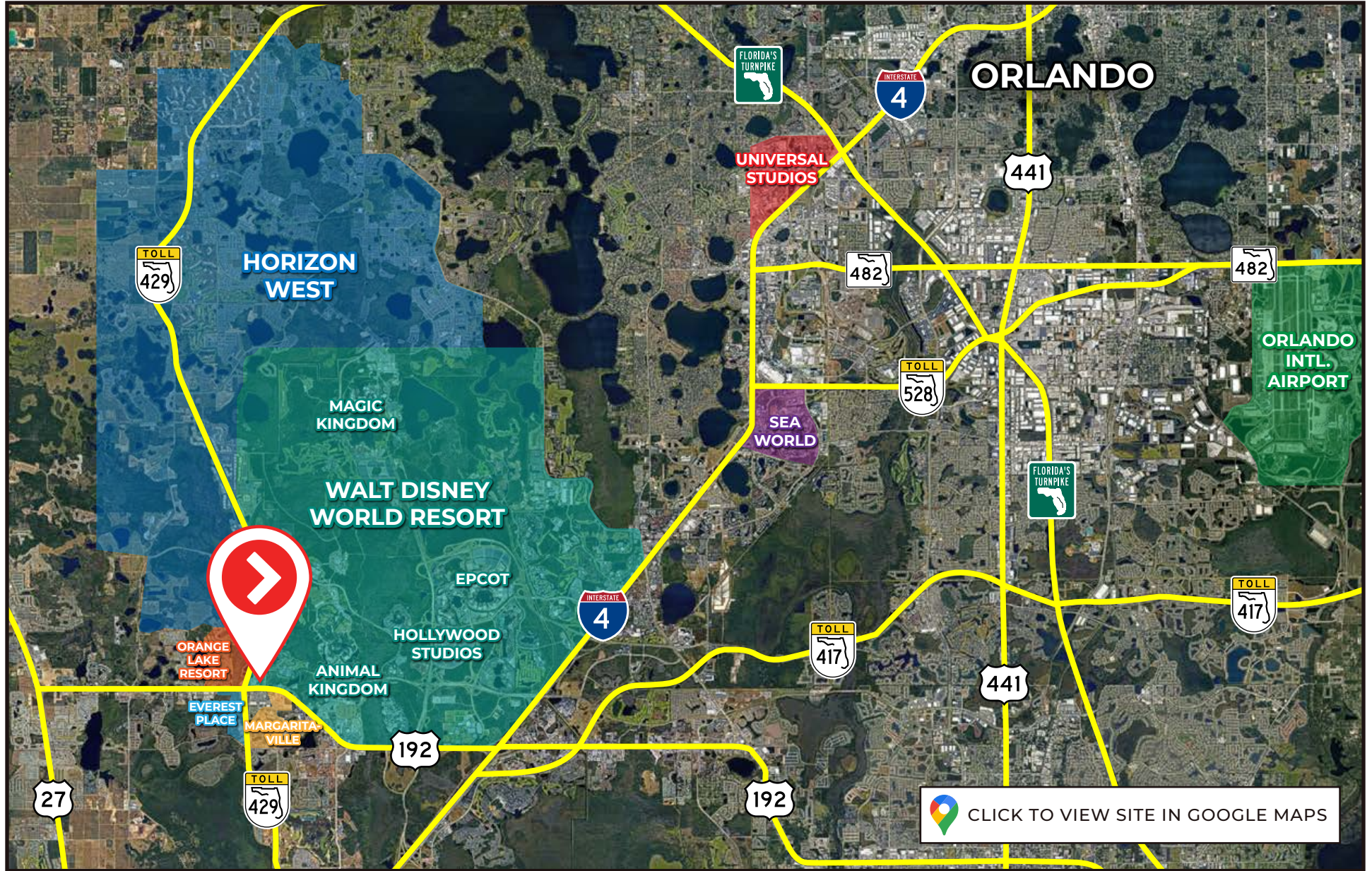

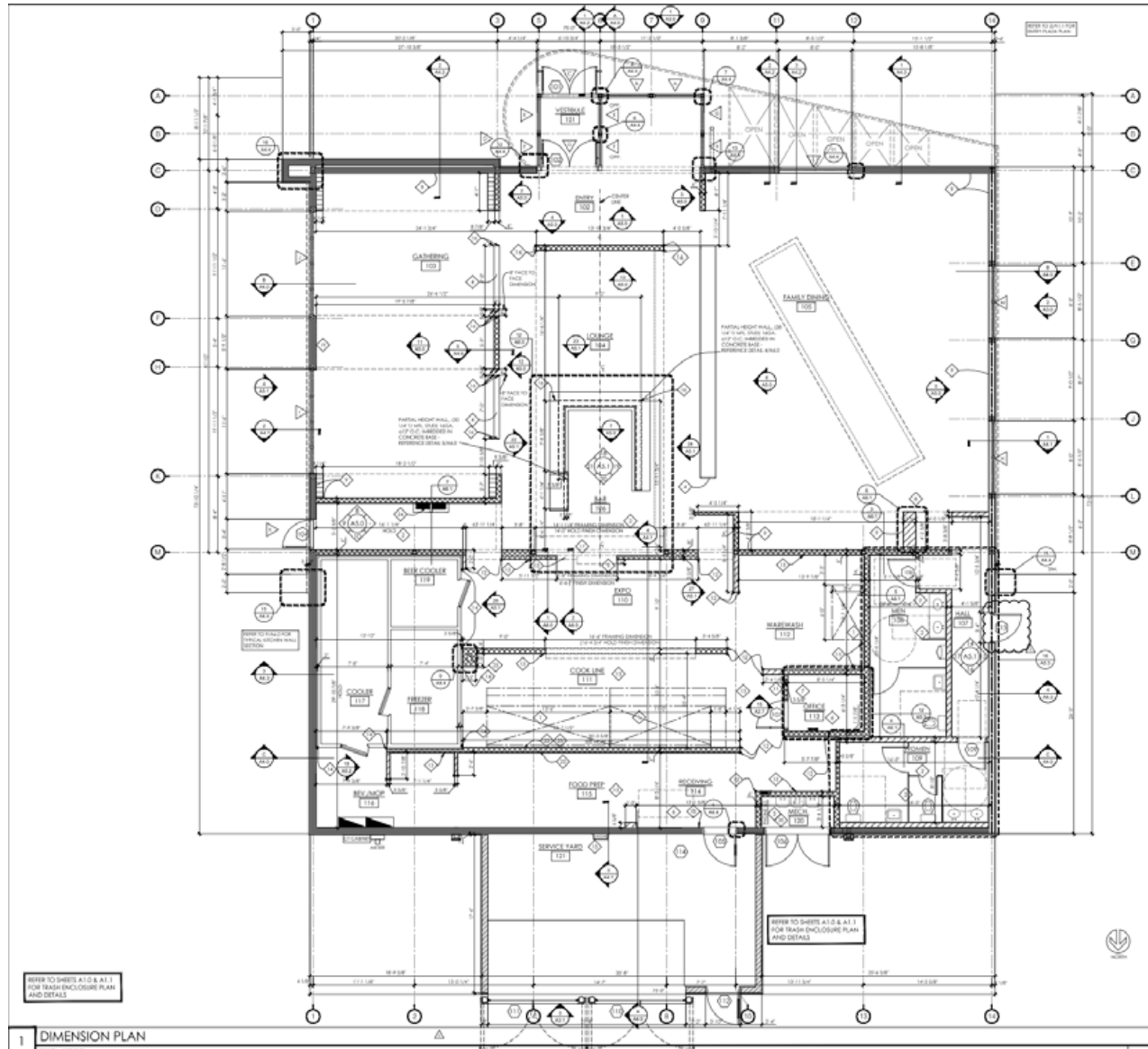

FOR MORE
INFORMATION
PLEASE CONTACT

PAYTON FOSTER

407-461-8080

PFOSTER@INSITEREI.COM

ALEX BISBEE

407-864-6444

ABISBEE@INSITEREI.COM

