



## Philadelphia Avenue of the Arts

PRODUCTS

OFFICES | ACCESS | VIRTUAL

**230 South Broad Street,  
Floors 17 and 18,  
Philadelphia, PA 19102**

Located on famed South Broad Street, this workspace puts you in the center of Philadelphia's most dynamic neighborhood. Just steps from Avenue of the Arts and the city's best restaurants, our space features best-in-class amenities with panoramic views of downtown.

**20K**  
Rentable Sqft

**4**  
Conference Rooms

**59**  
Offices



### INCLUDED SERVICES

- Dedicated On-Site Staff
- Daily Breakfast & Snacks
- Craft Coffee & Tea
- Mail & Packaging
- Community Events
- Weekly Happy Hours

- Wellness Room
- Unlimited Color Printing
- Fast, Secure Wi-Fi
- Office Supplies
- Professional-Grade Cleaning
- 24/7 Access

### BUILDING DETAILS

- Dining Options
- Retail Options

- Bike Storage
- Dry Cleaning
- Event Space
- Concierge Services
- 24/7 Security
- Pet Friendly

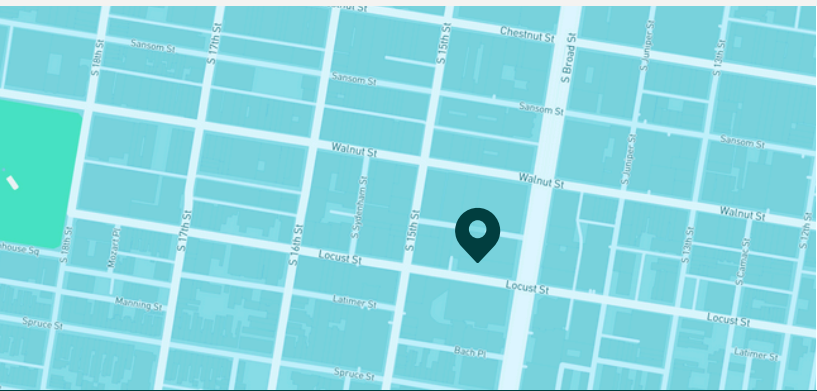

### TRANSIT

- SEPTA to Broad Street
- Broad St & Locust St
- Indego bike station 2 blocks
- Easy access to I-95, I-676, and I-76
- Parking (See back for details) Nearby

**LEGEND**

- Access Office
- Small Office (1-2)
- Medium Office (3-4)
- Large Office (5-8)
- XLarge Office (9+)
- Executive Office

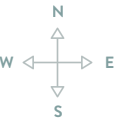

**MEETING SPACES**

Phone Booths	6
Conference Rooms	4

**PARKING INFO**

Paid parking garages are available within a 1-5 minute walk, including options within our building between Locust and Broad Streets, on 15th Street. Additionally, within one block, you'll find Latimer Garage, Parkway at 15th & Spruce, EZ Park at 1309 Locust, and Parkway at 219 S 13th Street.

18TH FLOOR

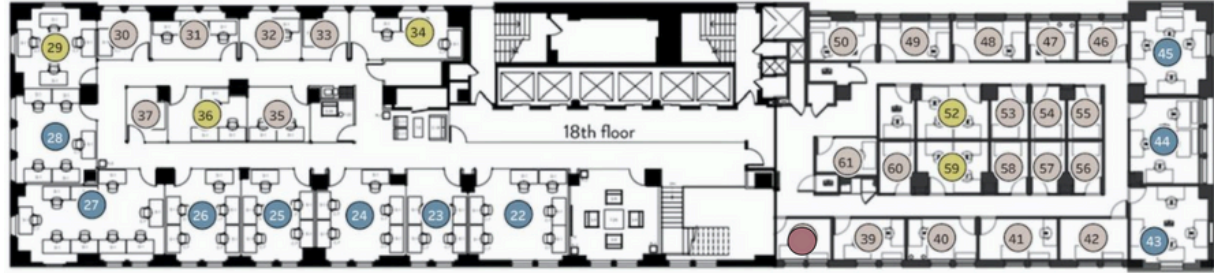

17TH FLOOR

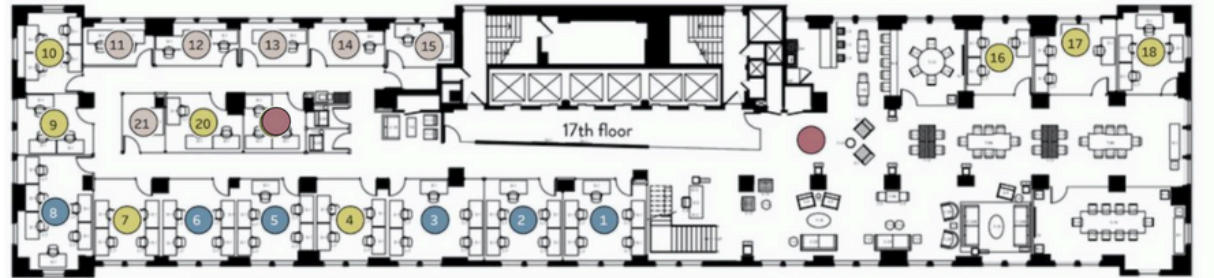

**#1 IN SATISFACTION**

Industrious is the highest rated workplace for customer satisfaction in the industry – offering premium coworking, private offices, and conference facilities with flexible terms and all-inclusive pricing.



Cafe (example only)



Private office (example only)



Conference room (example only)