

# EUCLID INDUSTRIAL PARK

307 - UNIT H  
NORTH EUCLID WAY  
ANAHEIM, CA



**±9,400 SF INDUSTRIAL UNIT  
AVAILABLE IMMEDIATELY**

**\$1.20 PSF GROSS FIRST YEAR RATE  
4% PROCURING BROKER FEE**

**FOR ADDITIONAL INFORMATION:**

**SEBASTIAN LOZANO**  
Senior Associate  
714.935.2303  
Lic. #02143474  
slozano@voitco.com

**MIKE BOUMA, SIOR**  
Senior Vice President  
714.935.2340  
Lic. #01070753  
mbouma@voitco.com

**PAUL CAPUTO, MBA**  
Senior Vice President  
714.935.2332  
Lic. #01196935  
pcaputo@voitco.com

**Voit**  
REAL ESTATE SERVICES

**BOUMA CAPUTO**

# EUCLID INDUSTRIAL PARK

231-307 NORTH EUCLID WAY  
ANAHEIM, CALIFORNIA



## FLOOR PLAN

307 EUCLID WAY, SUITE H   
±9,400 SF / \$1.20 PSF GROSS

- » ±9,400 SF Freestanding Building
- » ±300 SF of Office
- » Two (2) Restrooms
- » Four (4) Ground Level Loading Door
- » 16' of Warehouse Clearance
- » 400 Amps Power (to be verified)
- » Shared Fenced Yard
- » Possible 2nd Private Yard for Additional Fee
- » Excellent Freeway Access to 5 Freeway
- » \$1.55 PSF 2nd Year Rate
- » Additional \$0.07 CAM Charge

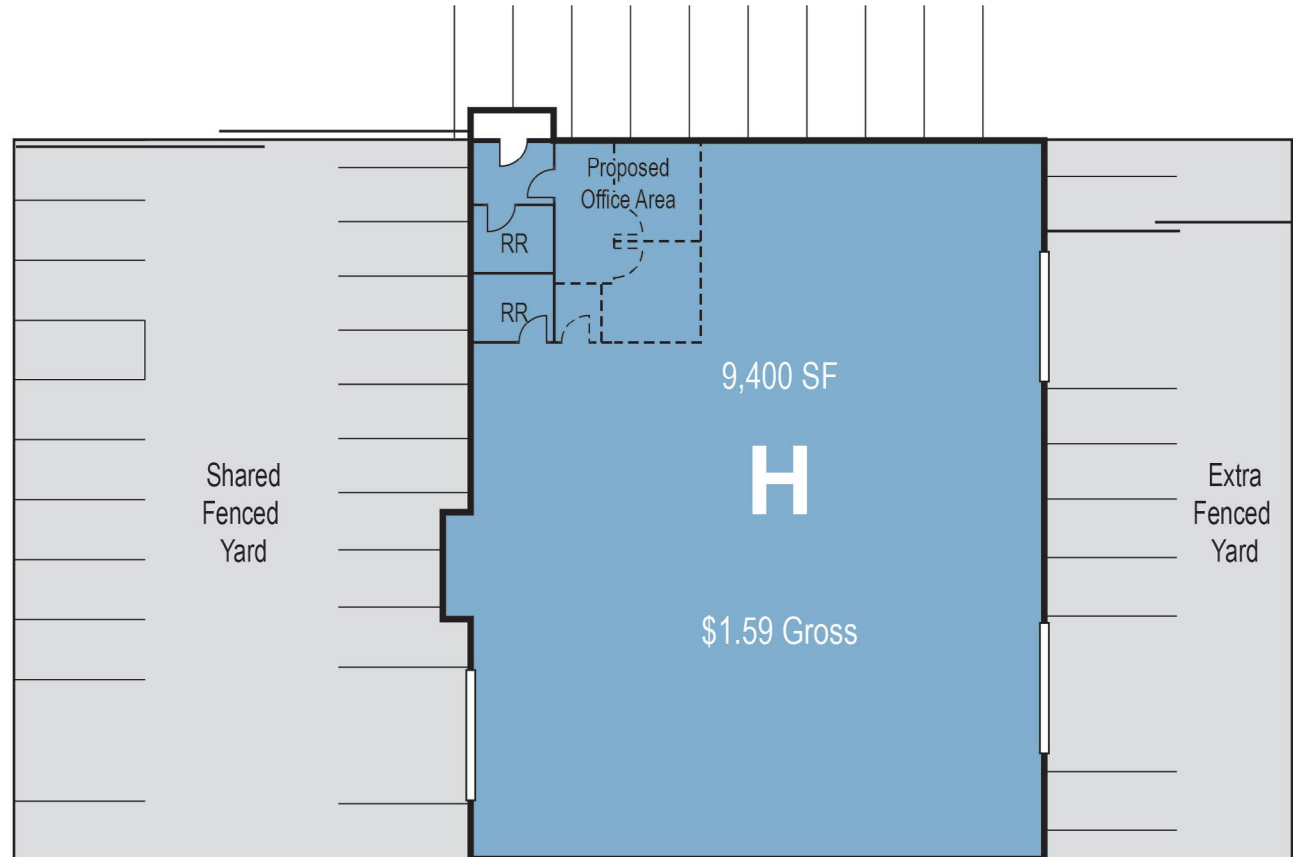

\* Floor plan and site plan may not be to scale.

**SEBASTIAN LOZANO** 714.935.2303 Lic. #02143474 slozano@voitco.com  
**MIKE BOUMA, SIOR** 714.935.2340 Lic. #01070753 mbouma@voitco.com  
**PAUL CAPUTO, MBA** 714.935.2332 Lic. #01196935 pcaputo@voitco.com

**Voit**  
REAL ESTATE SERVICES

2400 East Katella Avenue, Suite 750  
Anaheim, CA 92806  
www.voitco.com

The information contained herein is believed to be accurate but is not warranted as to its accuracy and may change or be updated without notice. Seller or landlord makes no representation as to the environmental condition of the property and recommends purchaser's or tenant's independent investigation. Licensed as Real Estate Salespersons by the DRE. ©2025 Voit Real Estate Services, Inc. All Rights Reserved. Lic. #01991785