

PROFESSIONAL OFFICE SPACE AVAILABLE FOR LEASE

770

770 E. Shaw Avenue  
Fresno, California

*New Tenant Rent Incentive*

*Call Broker for Details*

*For information, please contact:*

**Scott Christensen** | Vice President - Office Division | t 559-447-6230 | schristensen@pearsonrealty.com | CA RE Lic. #01415793

**NEWMARK**  
PEARSON COMMERCIAL

*Independently Owned and Operated*  
Corporate License #00020875  
[newmarkpearson.com](http://newmarkpearson.com)

**FRESNO OFFICE**  
7480 N. Palm Ave. #101  
Fresno, CA 93711  
t 559-432-6200

**VISALIA OFFICE**  
3447 S. Demaree St.  
Visalia, CA 93277  
t 559-732-7300

The distributor of this communication is performing acts for which a real estate license is required. The information contained herein has been obtained from sources deemed reliable but has not been verified and no guarantee, warranty or representation, either express or implied, is made with respect to such information. Terms of sale or lease and availability are subject to change or withdrawal without notice.

---

## PROFESSIONAL OFFICE SPACE

### PROPERTY DESCRIPTION

Professionally managed & maintained three-story office complex with quiet & peaceful open air atrium/courtyard area. All amenities for employees to enjoy daily including shopping, restaurants, banking & daily services all within walking distance. Easy access to Highway 41 & FAX bus service on Shaw Avenue. Abundant on-site common (*some covered*) parking. On-site security team.

---

### PROPERTY DETAILS

<b>Lease Rate:</b>	Full Service Lease. <i>Call broker for lease rates and further details.</i>
<b>Tenant Improvements:</b>	Negotiable
<b>Lease Term:</b>	3 year minimum preferred
<b>Parking Description:</b>	321 surface stalls, plus 8 surface handicap stalls
<b>Zoning:</b>	Commercial, General Office

---

### HIGHLIGHTS

- Complete Renovation, Millions Spent on Award Winning Improvements
  - Finest East Shaw Property (*High Image Building*)
  - Strategically Located Directly Across from the High End Super Regional Center: Fashion Fair Mall, Near Freeway 41, Major Banks & Dining
  - High Visibility (*64,000 Average Daily Vehicle Traffic Count, Over 23.3 Million Annually*)
  - ADA Compliant
  - Suites can accommodate various size requirements
- 

### CONCIERGE SERVICES

- On-site, proprietary, exclusive, highly visible, full-time, extensively trained security team available 24/7 via 1-800 number, providing for a "zero crime" model to assist tenants
  - Concierge staff provide in-house construction, management, maintenance and security. All working exclusively for owner and dedicated to better serve tenants
  - Lounge, conference and catering facilities available
- 

**NEWMARK**  
PEARSON COMMERCIAL

**Scott Christensen**  
Vice President - Office Division  
t 559-447-6230  
christensen@pearsonrealty.com  
CA RE Lic. #01415793

*Independently Owned and Operated* | Corporate License #00020875 | [newmarkpearson.com](http://newmarkpearson.com)

**FRESNO OFFICE:** 7480 N. Palm Ave. #101, Fresno, CA 93711, t 559-432-6200 | **VISALIA OFFICE:** 3447 S. Demaree St., Visalia, CA 93277, t 559-732-7300

The distributor of this communication is performing acts for which a real estate license is required. The information contained herein has been obtained from sources deemed reliable but has not been verified and no guarantee, warranty or representation, either express or implied, is made with respect to such information. Terms of sale or lease and availability are subject to change or withdrawal without notice.

## PROFESSIONAL OFFICE SPACE

### Availability

#### FIRST FLOOR

Suite 110-116:	8,016± RSF
Suite 130:	2,351± RSF
Suite 131:	3,171± RSF
Suite 132:	2,257± RSF

#### SECOND FLOOR

Suite 218:	2,199± RSF
Suite 240:	1,979± RSF

#### THIRD FLOOR

Suite 304:	3,439± RSF
Suite 310:	2,683± RSF
Suite 315:	5,411± RSF
Suite 320*:	7,872± RSF
Suite 324*:	1,009± RSF
Suite 325*:	1,607± RSF
Suite 326*:	2,381± RSF
Suite 330:	8,081± RSF

\*Could be combined up to 12,869± SF



**NEWMARK**  
PEARSON COMMERCIAL

Scott Christensen  
Vice President - Office Division  
t 559-447-6230  
christensen@pearsonrealty.com  
CA RE Lic. #01415793

Independently Owned and Operated | Corporate License #00020875 | [newmarkpearson.com](http://newmarkpearson.com)

FRESNO OFFICE: 7480 N. Palm Ave. #101, Fresno, CA 93711, t 559-432-6200 | VISALIA OFFICE: 3447 S. Demaree St., Visalia, CA 93277, t 559-732-7300

The distributor of this communication is performing acts for which a real estate license is required. The information contained herein has been obtained from sources deemed reliable but has not been verified and no guarantee, warranty or representation, either express or implied, is made with respect to such information. Terms of sale or lease and availability are subject to change or withdrawal without notice.

# PROFESSIONAL OFFICE CENTER

Floor Plan | 1<sup>st</sup> Floor *(Not to Scale)*

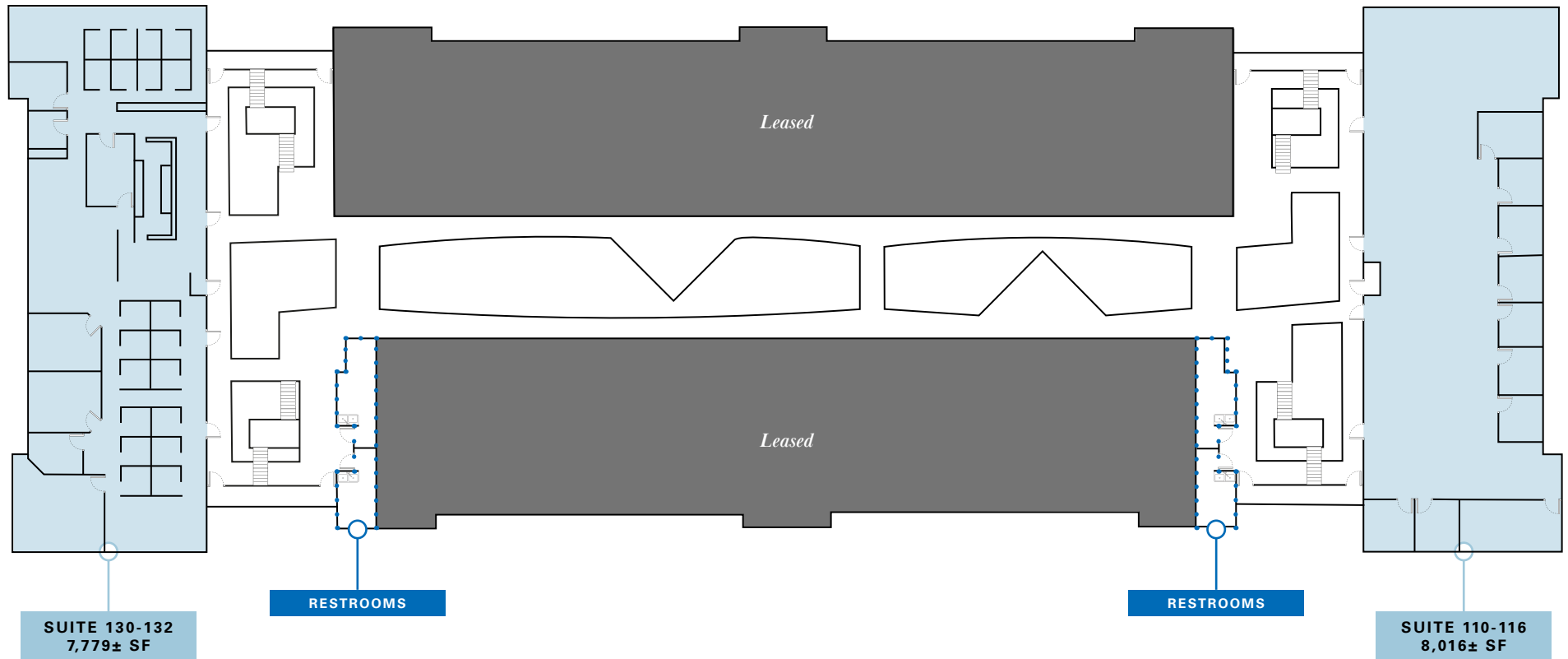

**NEWMARK**  
PEARSON COMMERCIAL

**Scott Christensen**  
Vice President - Office Division  
t 559-447-6230  
christensen@pearsonrealty.com  
CA RE Lic. #01415793

*Independently Owned and Operated* | Corporate License #00020875 | [newmarkpearson.com](http://newmarkpearson.com)

**FRESNO OFFICE:** 7480 N. Palm Ave. #101, Fresno, CA 93711, t 559-432-6200 | **VISALIA OFFICE:** 3447 S. Demaree St., Visalia, CA 93277, t 559-732-7300

The distributor of this communication is performing acts for which a real estate license is required. The information contained herein has been obtained from sources deemed reliable but has not been verified and no guarantee, warranty or representation, either express or implied, is made with respect to such information. Terms of sale or lease and availability are subject to change or withdrawal without notice.

**PROFESSIONAL OFFICE CENTER**

Floor Plan | 2<sup>nd</sup> Floor *(Not to Scale)*

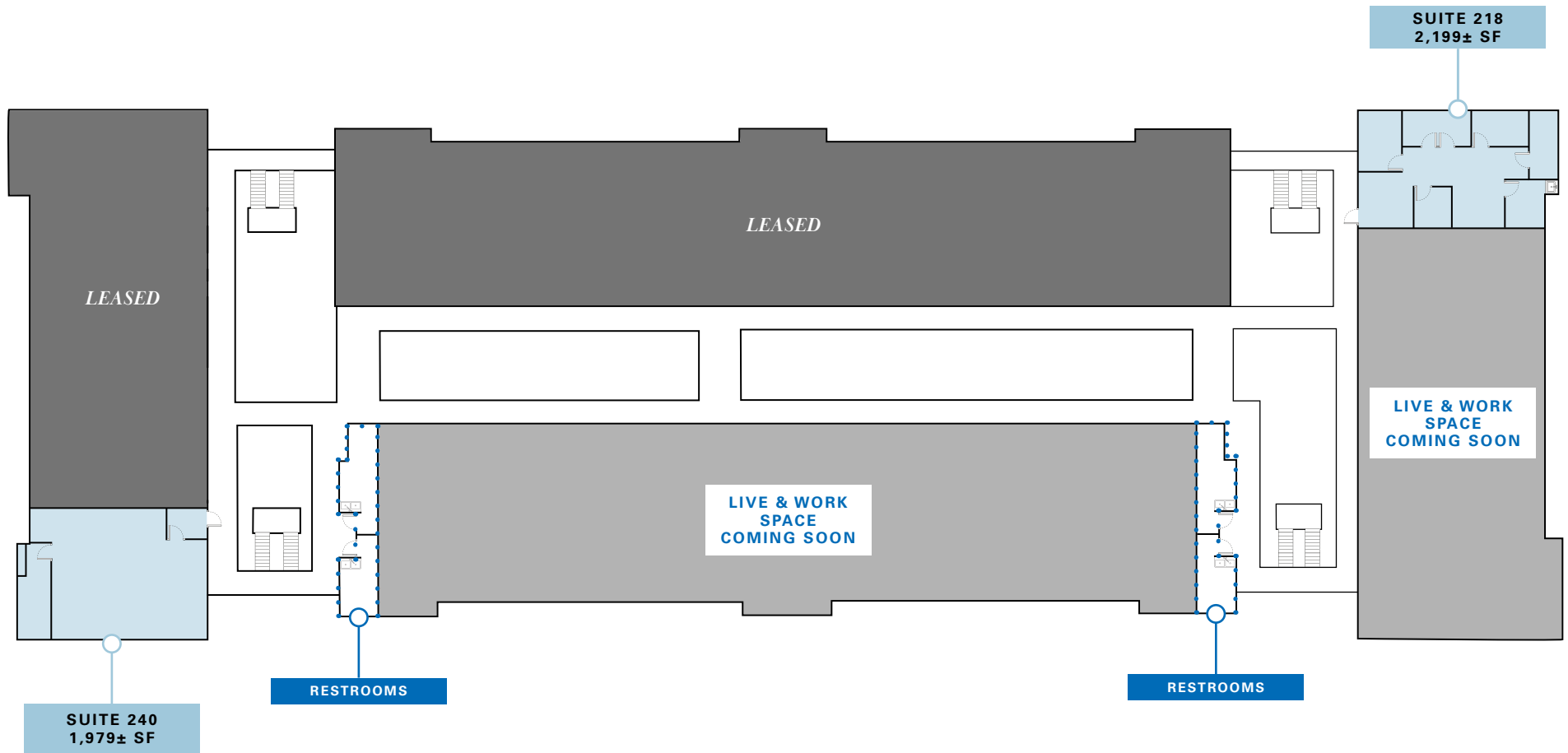

# PROFESSIONAL OFFICE CENTER

Floor Plan | 3<sup>rd</sup> Floor (Not to Scale)

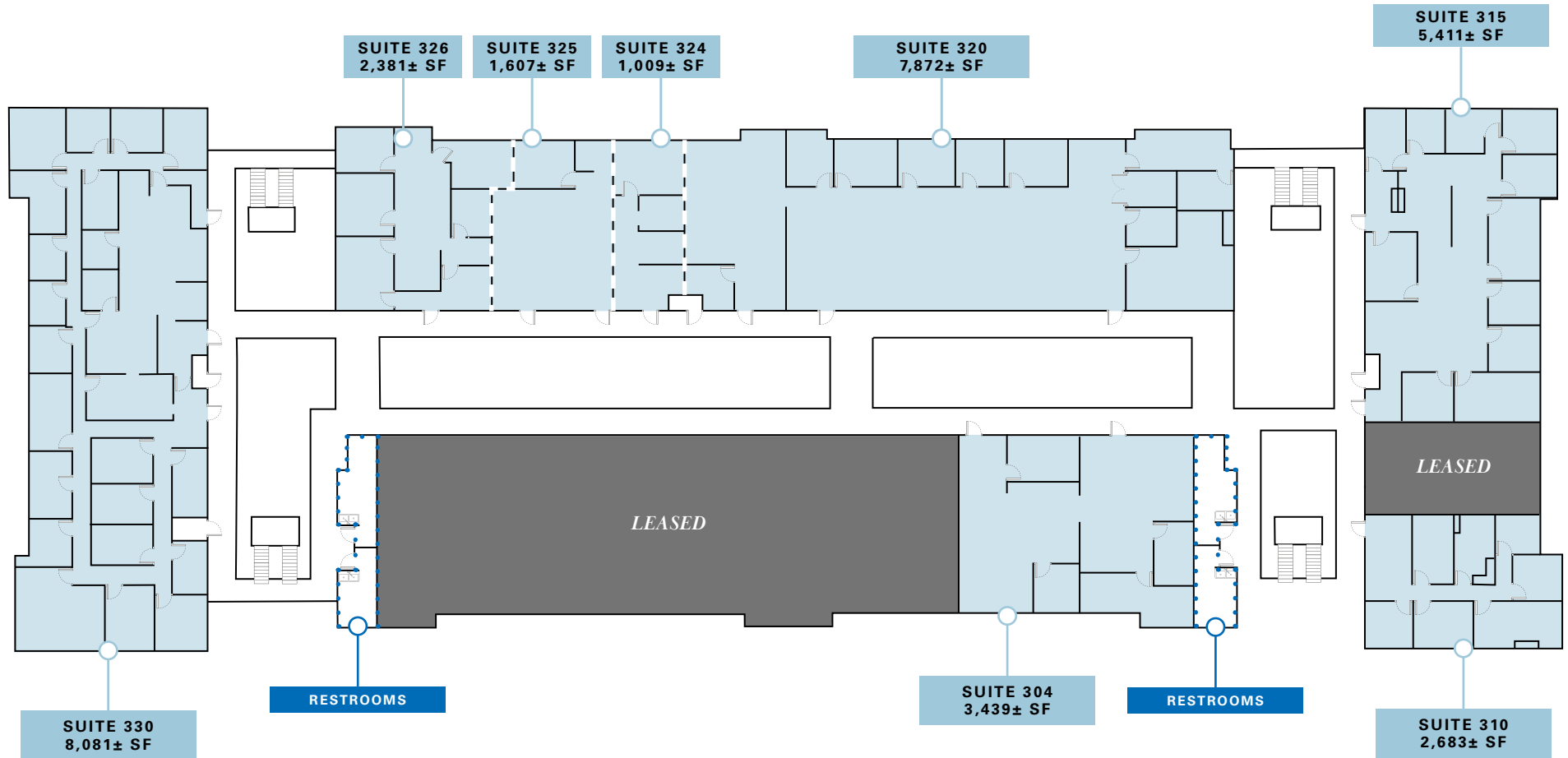

**NEWMARK**  
PEARSON COMMERCIAL

**Scott Christensen**  
Vice President - Office Division  
t 559-447-6230  
schristensen@pearsonrealty.com  
CA RE Lic. #01415793

Independently Owned and Operated | Corporate License #00020875 | [newmarkpearson.com](http://newmarkpearson.com)

**FRESNO OFFICE:** 7480 N. Palm Ave. #101, Fresno, CA 93711, t 559-432-6200 | **VISALIA OFFICE:** 3447 S. Demaree St., Visalia, CA 93277, t 559-732-7300

The distributor of this communication is performing acts for which a real estate license is required. The information contained herein has been obtained from sources deemed reliable but has not been verified and no guarantee, warranty or representation, either express or implied, is made with respect to such information. Terms of sale or lease and availability are subject to change or withdrawal without notice.

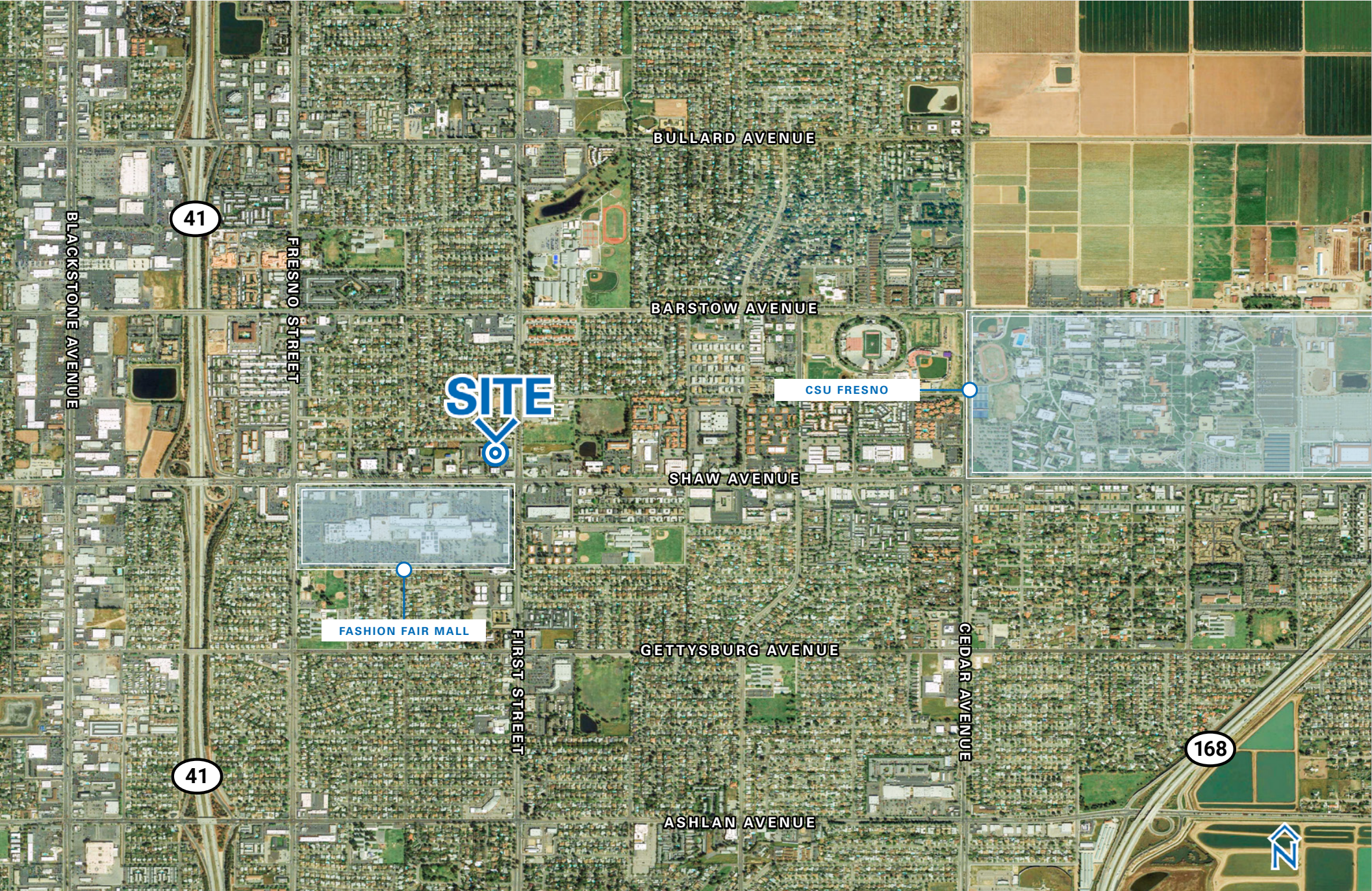

**NEWMARK**  
PEARSON COMMERCIAL

*Independently Owned and Operated*  
Corporate License #00020875  
[newmarkpearson.com](http://newmarkpearson.com)

**FRESNO OFFICE**  
7480 N. Palm Ave. #101  
Fresno, CA 93711  
t 559-432-6200

**VISALIA OFFICE**  
3447 S. Demaree St.  
Visalia, CA 93277  
t 559-732-7300

The distributor of this communication is performing acts for which a real estate license is required. The information contained herein has been obtained from sources deemed reliable but has not been verified and no guarantee, warranty or representation, either express or implied, is made with respect to such information. Terms of sale or lease and availability are subject to change or withdrawal without notice.





*For information, please contact:*

**Scott Christensen**

*Vice President - Office Division*

t 559-447-6230

[schristensen@pearsonrealty.com](mailto:schristensen@pearsonrealty.com)

CA RE Lic. #01415793

**NEWMARK**  
PEARSON COMMERCIAL

*Independently Owned and Operated*  
Corporate License #00020875  
[newmarkpearson.com](http://newmarkpearson.com)

**FRESNO OFFICE**  
7480 N. Palm Ave. #101  
Fresno, CA 93711  
t 559-432-6200

**VISALIA OFFICE**  
3447 S. Demaree St.  
Visalia, CA 93277  
t 559-732-7300

The distributor of this communication is performing acts for which a real estate license is required. The information contained herein has been obtained from sources deemed reliable but has not been verified and no guarantee, warranty or representation, either express or implied, is made with respect to such information. Terms of sale or lease and availability are subject to change or withdrawal without notice.