



# 101 HUDSON ST.

JERSEY CITY, NJ

## SUBLEASE

17TH FLOOR - TWO SUITES  
2,551 - 5,373 SF

### MINA SHEHATA

Direct: +1 201 460 3364  
mina.shehata@cushwake.com

### BENJAMIN BOUGANIM

Direct: +1 212 841 7543  
Mobile: +1 305 610 2490  
benjamin.bouganim@cushwake.com

### ED WARTELS

Direct: +1 212 841 7541  
Mobile: +1 917 626 4923  
ed.wartels@cushwake.com

### JUSTIN R. HALPERN

Direct: +1 212 841 7543  
Mobile: +1 646 808 7319  
justin.halpern@cushwake.com

©2025 Cushman & Wakefield. All rights reserved. The information contained in this communication is strictly confidential. This information has been obtained from sources believed to be reliable but has not been verified. NO WARRANTY OR REPRESENTATION, EXPRESS OR IMPLIED, IS MADE AS TO THE CONDITION OF THE PROPERTY (OR PROPERTIES) REFERENCED HEREIN OR AS TO THE ACCURACY OR COMPLETENESS OF THE INFORMATION CONTAINED HEREIN, AND SAME IS SUBMITTED SUBJECT TO ERRORS, OMISSIONS, CHANGE OF PRICE, RENTAL OR OTHER CONDITIONS, WITHDRAWAL WITHOUT NOTICE, AND TO ANY SPECIAL LISTING CONDITIONS IMPOSED BY THE PROPERTY OWNER(S). ANY PROJECTIONS, OPINIONS OR ESTIMATES ARE SUBJECT TO UNCERTAINTY AND DO NOT SIGNIFY CURRENT OR FUTURE PROPERTY PERFORMANCE.





# BUILDING AMENITIES

- The suites could be subleased together or separate and are adjacent to the 101 Club Tenant Amenity center which offers an outdoor roof terrace with stunning NYC views, conference and training rooms, town hall space, and additional collaboration and hot desking.
- Both units are located on the 17th floor where the 101 Club Tenant Amenity center is providing access to an outdoor terrace, conference and training rooms, town hall space, tenant lounge and hot desks.
- On-Site Covered Parking Decks
- Adjacent to Exchange Place Path Station & Exchange Place Light Rail



# FLOORPLAN

17TH FLOOR - TWO SUITES - 2,551 - 5,373 SF

LXD - 3/31/26

2,551 SF

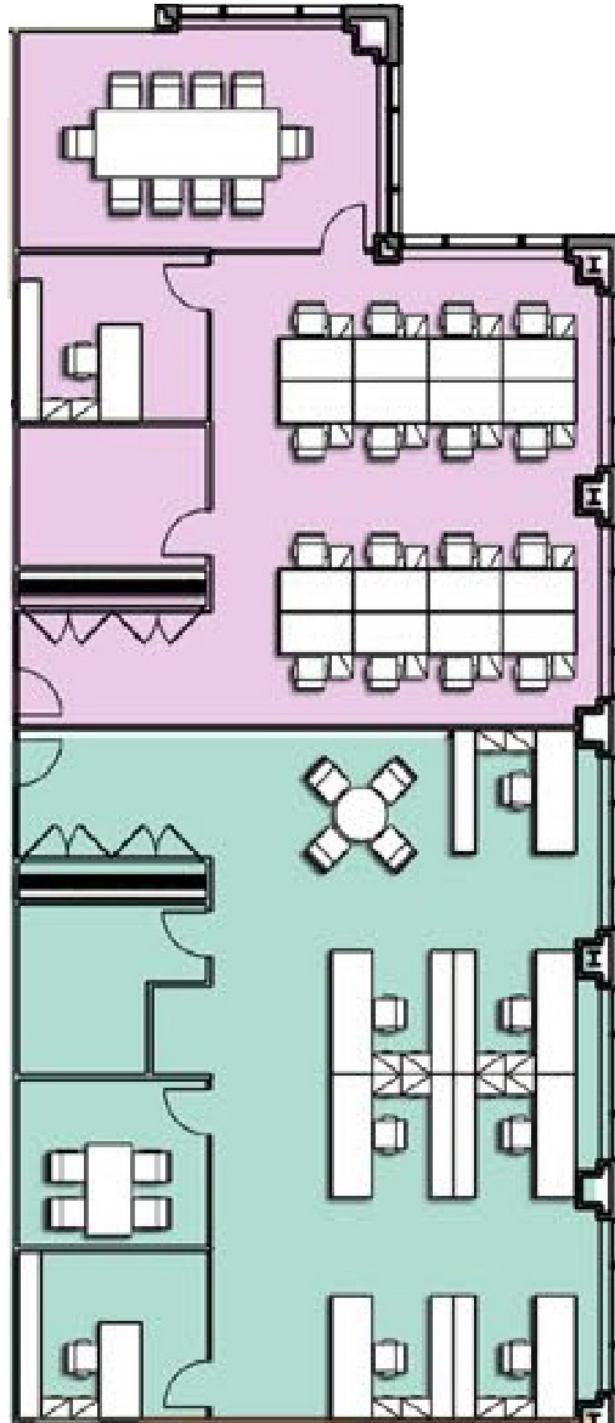

2,882 SF