

2ND GENERATION
RESTAURANT SPACE

1534
Montana Ave



1534 MONTANA AVENUE



ADDRESS

1534 Montana Avenue

SITE STATUS

Currently Margo's

APPROXIMATE SIZE

Ground Floor 2,050 SF
 Mezzanine 94 SF
 Large parklet patio

COMMENTS

31 feet frontage on Montana Avenue
 Full Type 47 liquor license
 On-site surface parking
 Sits across from Bardonna and next to Bread Head

AVAILABILITY

Immediate

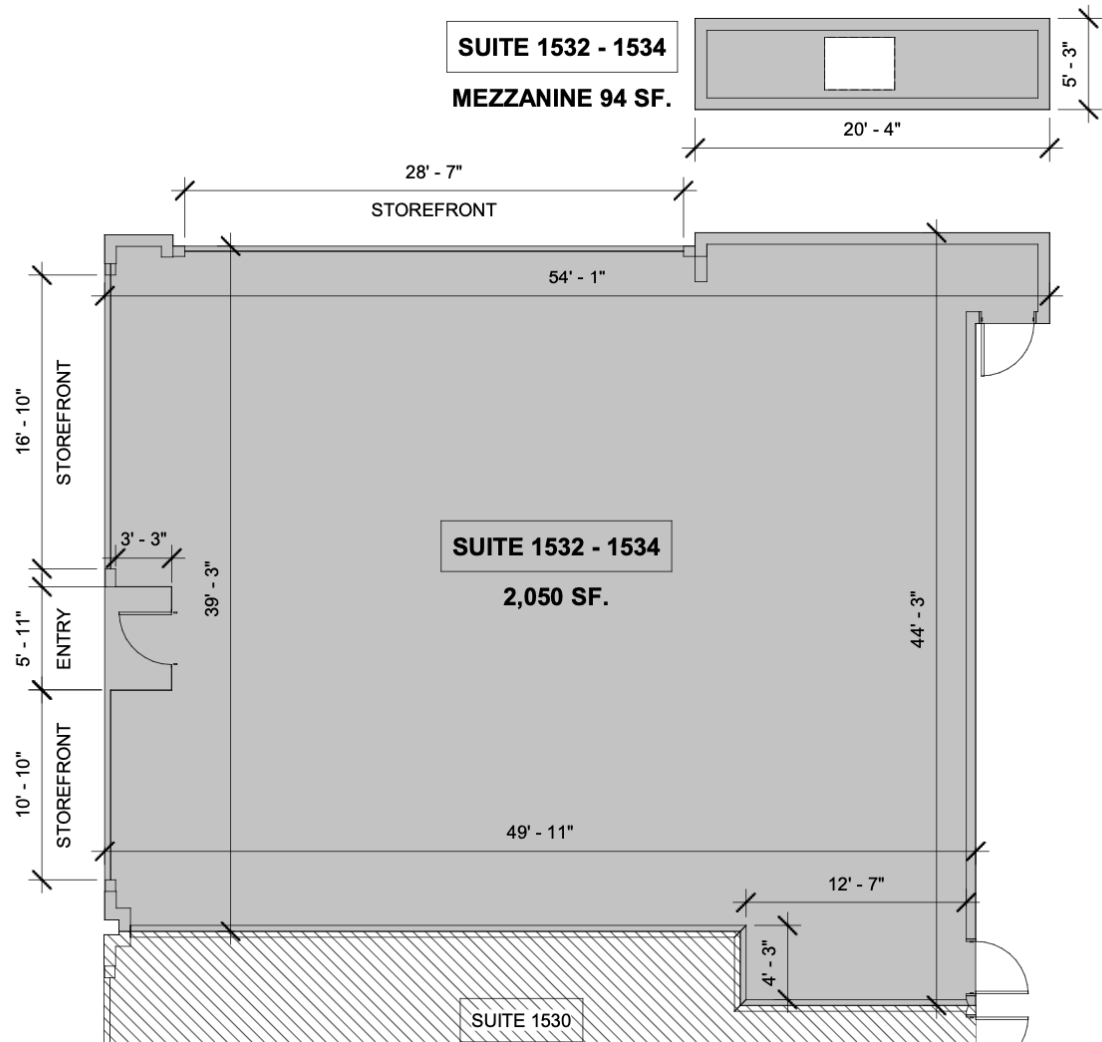

1534 MONATANA AVENUE

1534 Montana Avenue Santa Monica



▲ INTERIOR



EXTERIOR, EXCLUSIVE PATIO ▶



IN THE NEIGHBORHOOD

Montana Avenue is a walkable street that stretches from Ocean Avenue in Santa Monica to Brentwood. The buzzy browsy street invites you to spend hours strolling the blocks for your daily needs, coffee runs, and meals. The median household income is \$111,610 and the average daytime population is 37,676.



FORMA RESTAURANT

FATHER'S OFFICE



PRIMA CANTINA



THE COURTYARD KITCHEN



LA LA LAND



BREAD HEAD



R+D KITCHEN



BREAKFAST BY SALT'S CURE



H&H BAGELS



LOCANDA PORTOFINO



SOGNO TOSCANO

MONTANA AVENUE TRADE AREA



CONTACT EXCLUSIVE AGENTS

Greer Colton

greer@thirtythreegroup.com

405.630.7076

Liz Rockmore

liz@thirtythreegroup.com

203.952.1178

Rachel Rosenberg

rachel@thirtythreegroup.com

323.459.1482

Sydney Waters

sydney@thirtythreegroup.com

815.575.6304

THIRTY
THREE
GROUP

©2023 Thirty Three Group | All information is from sources believed reliable, not independently verified, and thus subject to errors, omissions, and modifications such as price, listing, square footage, rates and commissions. All information, estimates and projections subject to change, market assumptions, unknown facts and conditions, and future potentialities. Thirty Three Group makes no express or implied representations or warranties, as facts and results may vary materially from all information, estimates and projections.