



# 943 RESERVE DR

*±10,653 SF office/medical building for Lease or Sale  
\$2.15/SF Full Service or \$3,185,000 (\$299/SF)  
Premier Roseville Location with Plug & Play Bonus*

ROSEVILLE, CA 95678

*Exclusively listed by*

**JON WALKER**  
916.205.3554  
jon.walker@kidder.com  
LIC N° 01204666

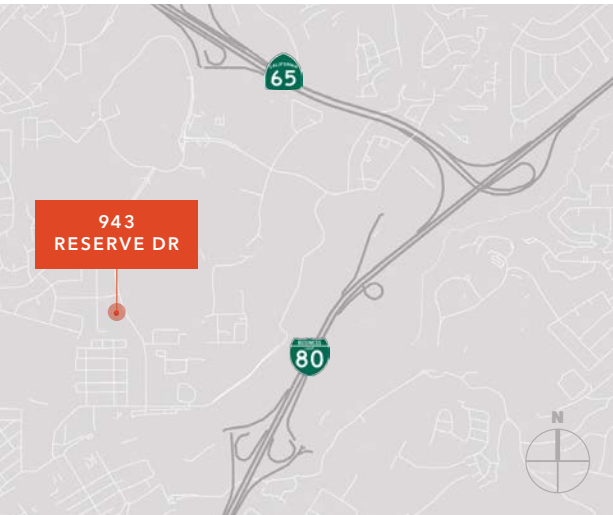

### PROPERTY HIGHLIGHTS

Year Built: 2004

Location: Vintage Oaks Office Park

±10,653 SF (divisible to ±3,000 SF)

The interior improvements include: 12 offices, 2 conference rooms, 38 workstations, 2 break room areas, Mens and Womens restrooms, IT room, an open work/storage area and an outside patio for employees.

Power consists of Two 400 Amp Panels (208/120V) 3-Phase

Roof consists of ±8,300 SF of pitched cement tile and ±4,500 SF of Flat BUR (built-up-roof) TPO (Thermoplastic Polyolefin Membrane) surrounded by ±1,300 SF of Parapet Wall

HVAC consists of 6 Carrier 4-Ton package units and 1 Mistubishi mini-split 1.5-Ton in the Server Room

Water Heater is a 50 Gallon Electric Tank

IT Rack includes all wiring plus fiber cable

Sonitrol Alarm Monitoring

A Blue Box smart relay panel provides a cost-effective lighting control system

A prime location behind the Fountains Shopping Center with parking on all 3 sides. Medical uses allowed per BP zoning. Easy Access to I-80 and Hwy 65. Building is maintained in First Class condition

# FLOOR PLAN

## ±10,653 SF





*Demographics  
within a  
5 mile radius*

*242K*

POPULATION

*39%*

BACHELORS OR HIGHER

*89K*

HOUSEHOLDS

*\$128K*

MEDIAN HH INCOME

*\$624K*

MEDIAN HOME VALUE

*41.1*

MEDIN AGE



[KIDDER.COM](http://KIDDER.COM)

This information supplied herein is from sources we deem reliable. It is provided without any representation, warranty, or guarantee, expressed or implied as to its accuracy. Prospective Buyer or Tenant should conduct an independent investigation and verification of all matters deemed to be material, including, but not limited to, statements of income and expenses. Consult your attorney, accountant, or other professional advisor. All Kidder Mathews designs are the sole property of Kidder Mathews. Branded materials and layouts are not authorized for use by any other firm or person.



THE FOUNTAINS AT ROSEVILLE

J.CREW FACTORY	MIKUMI Japanese restaurant & sushi bar	pet food express
DAVE & BUSTERS	Peets COFFEE	SEPHORA
Yard House	west elm	WHOLE FOODS MARKET

943  
RESERVE DR