

FOR SUBLEASE

±8,147 SF

**300 SPECTRUM CENTER DRIVE
SUITE 1120, IRVINE, CA 92618**

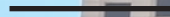

R. SCOTT COLTON
Senior Vice President
License #01923432
949.790.3127
scolton@leeirvine.com

CASEY LYNTON
Associate
License #02217751
949.790.3146
clynton@leeirvine.com



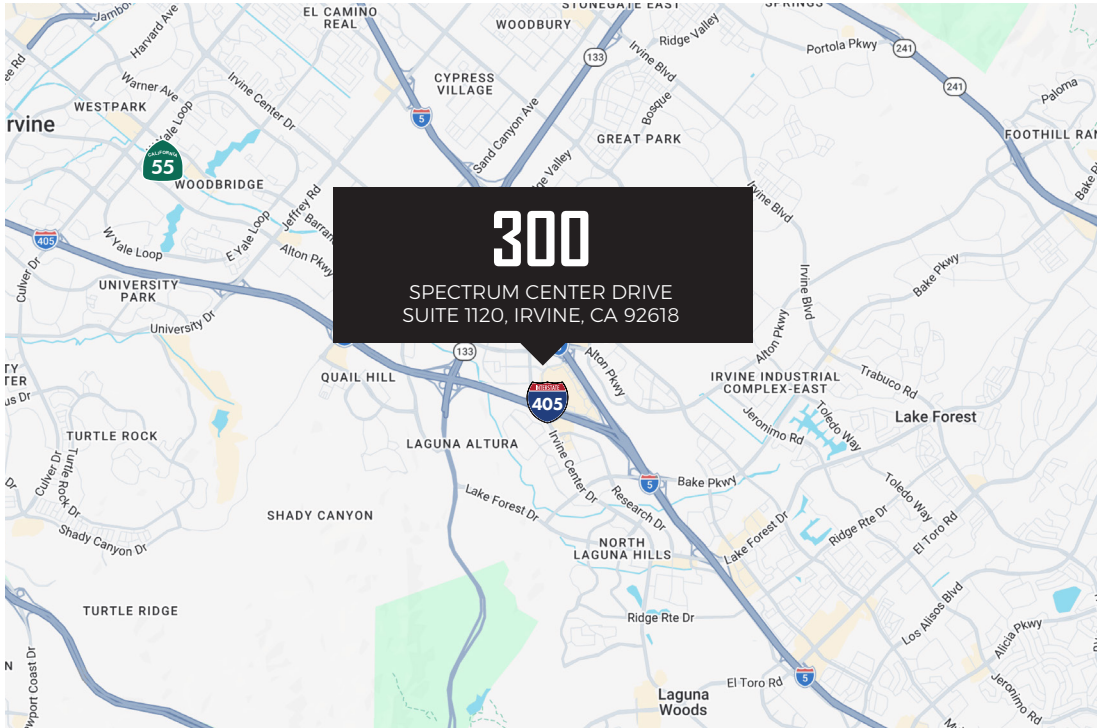

300
SPECTRUM CENTER DRIVE
SUITE 1120, IRVINE, CA 92618

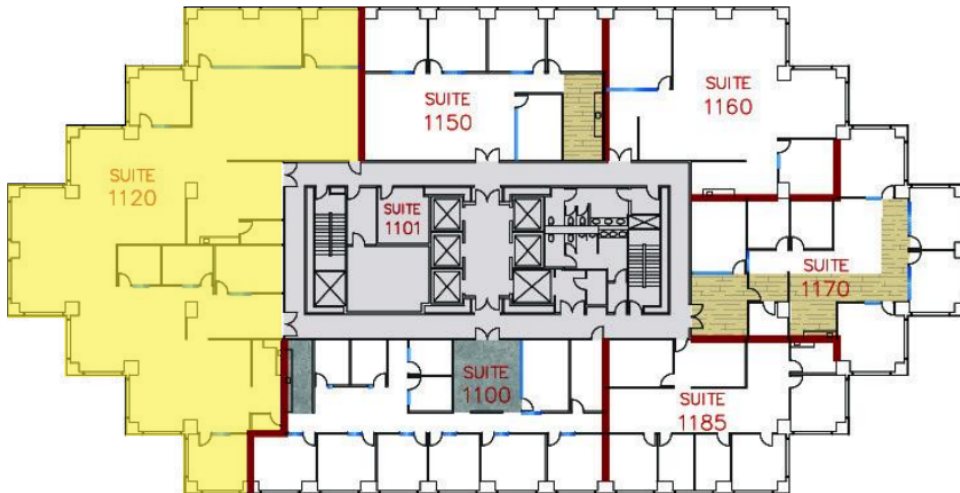

PROPERTY OVERVIEW

±8,147 SF Office Suite

Fully Furnished Plug & Play!!

High-End Improvements

Conference Center

Covered Parking

Onsite Café

Gym & Workout Facility

Close Proximity to the 73 Freeway

Year Built: 1989

Sublease Through 6/30/2029

R. SCOTT COLTON

Senior Vice President
License #01923432
949.790.3127
scolton@leeirvine.com

CASEY LYNTON

Associate
License #02217751
949.790.3146
clynton@leeirvine.com