

CHERRY STREET
BUSINESS PARK

41531

CHERRY STREET
MURRIETA, CA

FOR LEASE
±4,180 SF FREESTANDING
INDUSTRIAL UNIT



FEATURES:

- TWO (2) 10' X 12' GROUND LEVEL ROLL UP DOOR
- 200 AMP, 120/208 V / 3 PHASE (VERIFY)
- 16' WAREHOUSE CLEAR HEIGHT
- SPRINKLERED
- GREAT LOCATION OFF THE I-15 FREEWAY
- INTERIOR FEATURES:
 - RECEPTION AREA
 - ONE (1) PRIVATE OFFICE
 - RESTROOM
- ZONED: CITY OF MURRIETA- BUSINESS PARK (BP)

LEASE RATE:

\$1.30 PSF / MG PLUS \$0.26 PSF
MONTHLY CAM FEE

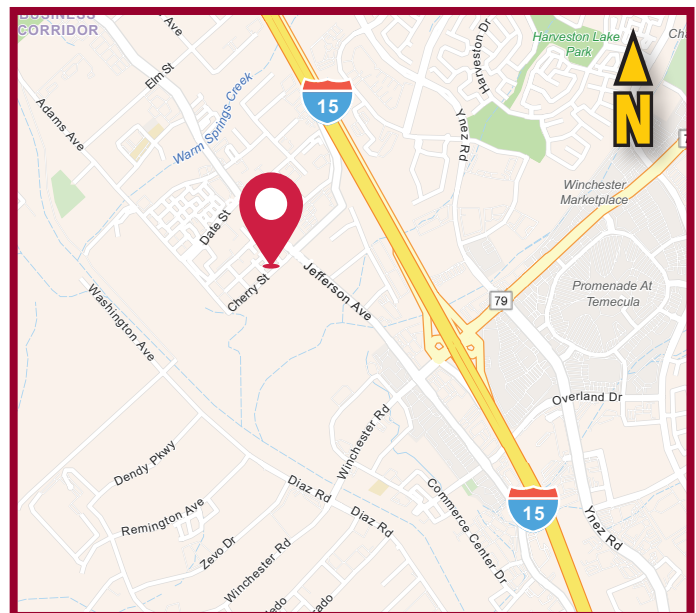

GORDON MIZE

951.445.4504
gmize@leetemecula.com
DRE#01275376

CONNOR STRODE

951.445.4529
cstrode@leetemecula.com
DRE#: 02170137

BEN WELLER

951.445.4561
bweller@leetemecula.com
DRE #02254521

CHERRY STREET
BUSINESS PARK

41531

CHERRY STREET
MURRIETA, CA

FOR LEASE
±4,180 SF FREESTANDING
INDUSTRIAL UNIT



GORDON MIZE

951.445.4504
gmize@leetemecula.com
DRE#01275376

CONNOR STRODE

951.445.4529
cstrode@leetemecula.com
DRE#: 02170137

BEN WELLER

951.445.4561
bweller@leetemecula.com
DRE #02254521

CHERRY STREET
BUSINESS PARK

41531

CHERRY STREET
MURRIETA, CA

FOR LEASE
±4,180 SF FREESTANDING
INDUSTRIAL UNIT

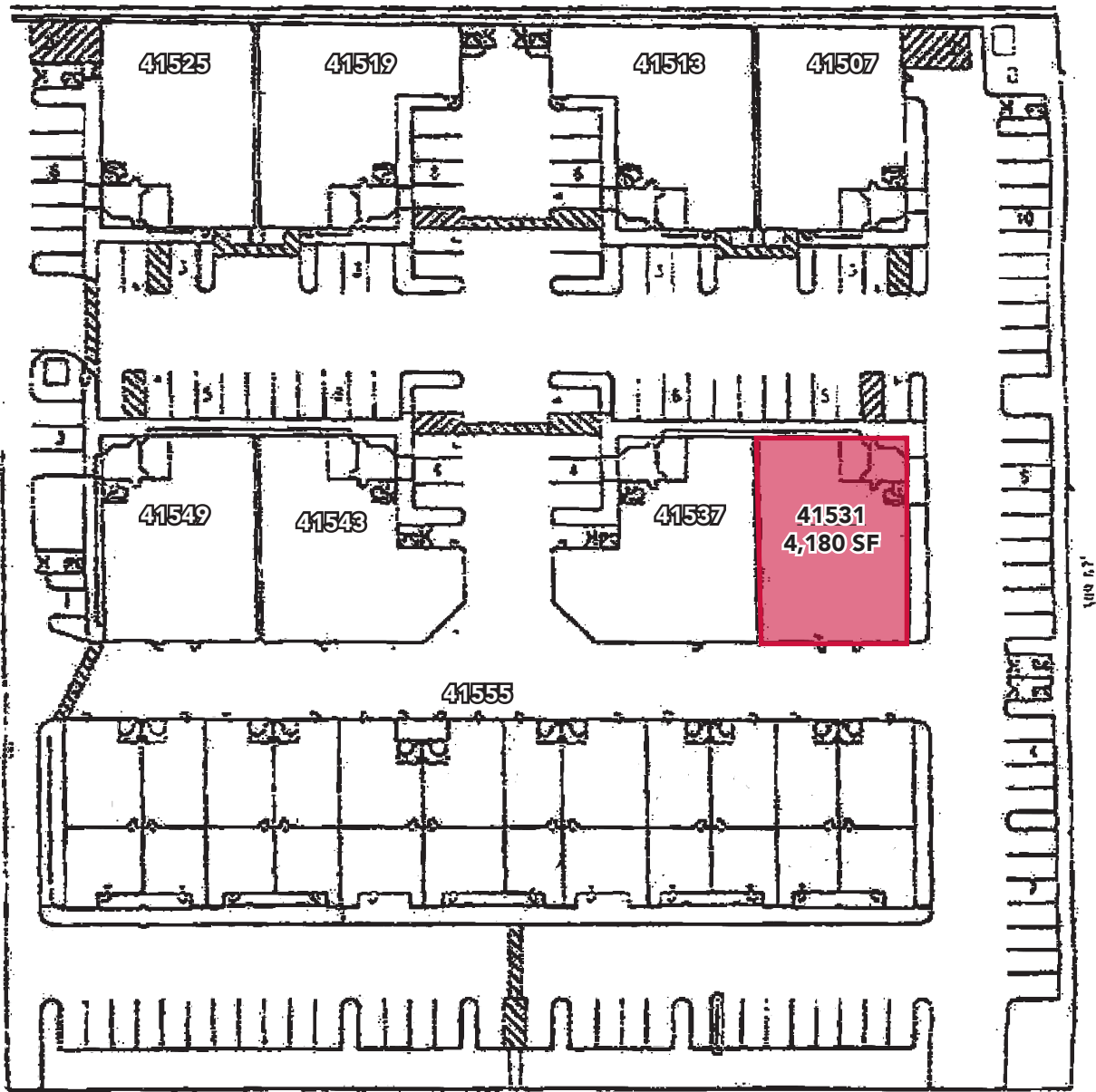

CHERRY STREET

GORDON MIZE

951.445.4504
gmize@leetemecula.com
DRE#01275376

CONNOR STRODE

951.445.4529
cstrode@leetemecula.com
DRE#: 02170137

BEN WELLER

951.445.4561
bweller@leetemecula.com
DRE #02254521



No warranty or representation has been made to the accuracy of the foregoing information. Terms of sale or lease and availability are subject to change or withdrawal without notice. Lee & Associates Commercial Real Estate Services, Inc. - Riverside. 25240 Hancock Avenue, Suite 100 - Murrieta, CA 92562 Corporate ID# 01048055

CHERRY STREET
BUSINESS PARK

41531

CHERRY STREET
MURRIETA, CA

FOR LEASE
±4,180 SF FREESTANDING
INDUSTRIAL UNIT



GORDON MIZE

951.445.4504
gmize@leetemecula.com
DRE#01275376

CONNOR STRODE

951.445.4529
cstrode@leetemecula.com
DRE#: 02170137

BEN WELLER

951.445.4561
bweller@leetemecula.com
DRE #02254521



No warranty or representation has been made to the accuracy of the foregoing information. Terms of sale or lease and availability are subject to change or withdrawal without notice. Lee & Associates Commercial Real Estate Services, Inc. - Riverside. 25240 Hancock Avenue, Suite 100 - Murrieta, CA 92562 Corporate ID# 01048055