



# ETON BUSINESS PARK

21121-21125 OSBORNE ST.  
CANOGA PARK, CA

**SPACE AVAILABLE | 10,022 SF**

**\$15,935 MG**  
PER MONTH (\$1.59 PSF)

**6 MONTHS HALF RENT**  
(SUBJECT TO TENANT'S  
CREDIT AND MINIMUM  
3-YEAR LEASE TERM)



**NEWMARK**

**Jeff Abraham, SIOR**  
Executive Managing Director  
t 818-921-8528  
jeff.abraham@nmrk.com  
CA RE License #01830909

**Javier Galvan**  
Associate Director  
t 818-921-8532  
javier.galvan@nmrk.com  
CA RE License #02116539

Corporate License #01355491

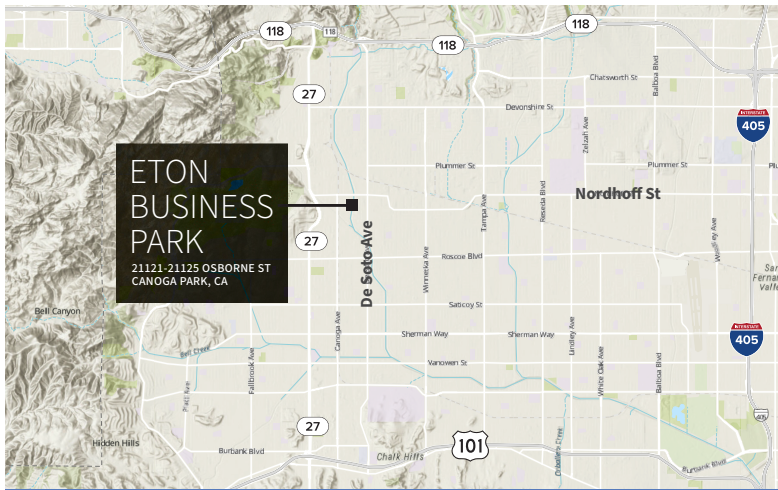

**ETON BUSINESS PARK**  
 21121-21125 OSBORNE ST  
 CANOGA PARK, CA

**REGIONAL MAP**

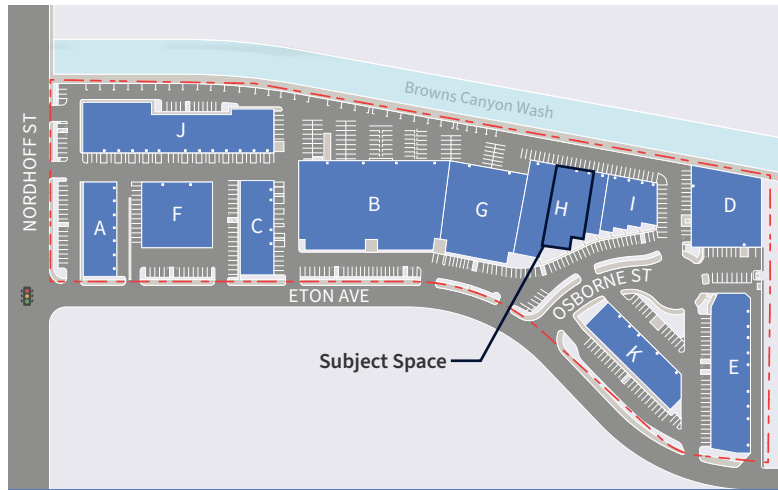

**SITE PLAN**

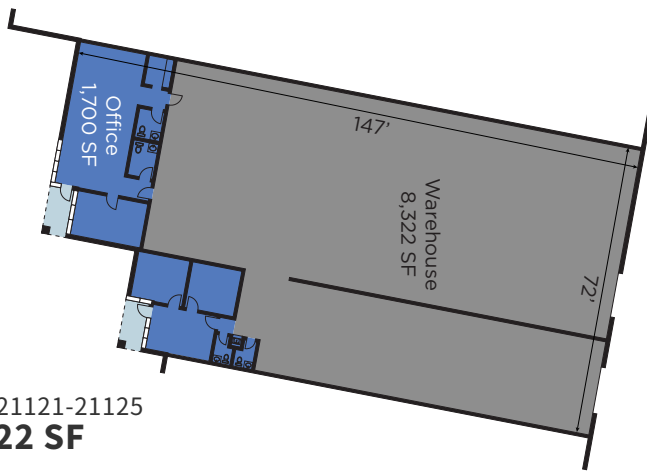

SUITE 21121-21125  
**10,022 SF**

**FLOOR PLAN**



**INTERIOR PHOTO**

## SUITE ATTRIBUTES



2 rear ground level loading doors



15-foot minimum warehouse clearance



Clear span warehouse



1,700 SF functional office space



200 Amps  
 120/240 Volts



3.5 miles from 118 Freeway and 5.2 miles from 101 Freeway



2.00:1,000 SF parking (20 spaces)



20 minutes from 405 Freeway, providing access to Greater Los Angeles



3 miles from Westfield Topanga



**Jeff Abraham, SIOR**  
 Executive Managing Director  
 t 818-921-8528  
 jeff.abraham@nrmk.com  
 CA RE License #01830909

**Javier Galvan**  
 Associate Director  
 t 818-921-8532  
 javier.galvan@nrmk.com  
 CA RE License #02116539

Corporate License #01355491