



Lakepointe Business Park - 8

8948 Western Way
Jacksonville, Florida 32256

Property Highlights

- IBP zoning for industrial and commercial users
- Southside location with quick I-95 access
- 20' clear height with 22' max height
- Wet sprinkler system throughout
- 8 dock-high, 12 grade-level, and 1 ramp door
- Cross-dock configuration for efficient loading
- 2026 Est. CAM: \$3.34/SF

Property Overview

A master-planned, 375,000 SF multi-tenant development located on 38-acres in the prestigious Baymeadows area. This project offers enormous flexibility with ability to accommodate users from 1,100 to 78,000 SF within nine buildings. These flex buildings offer excellent office space with grade-level roll-up doors. Both dock-high and grade-level loading are available to suit specific needs.

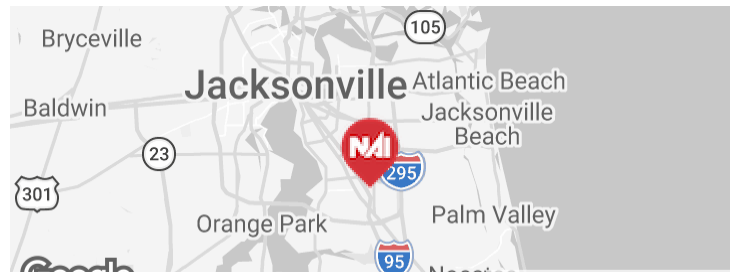

Spaces	Lease Rate	Space Size
Suite 10	Negotiable	15,000 - 34,000 SF

For More Information



Jason J. Purdy

Vice President, Industrial Specialist
O: 904 404 4462 | C: 850 287 2697
jp@naihallmark.com



Camden Padgett

Associate Vice President
O: 904 404 4460
cp@naihallmark.com

For Lease
15,000 - 34,000 SF
Industrial Space

SUITE 10	
WAREHOUSE:	32,928 SF
OFFICE:	1,072 SF
TOTAL:	34,000 SF

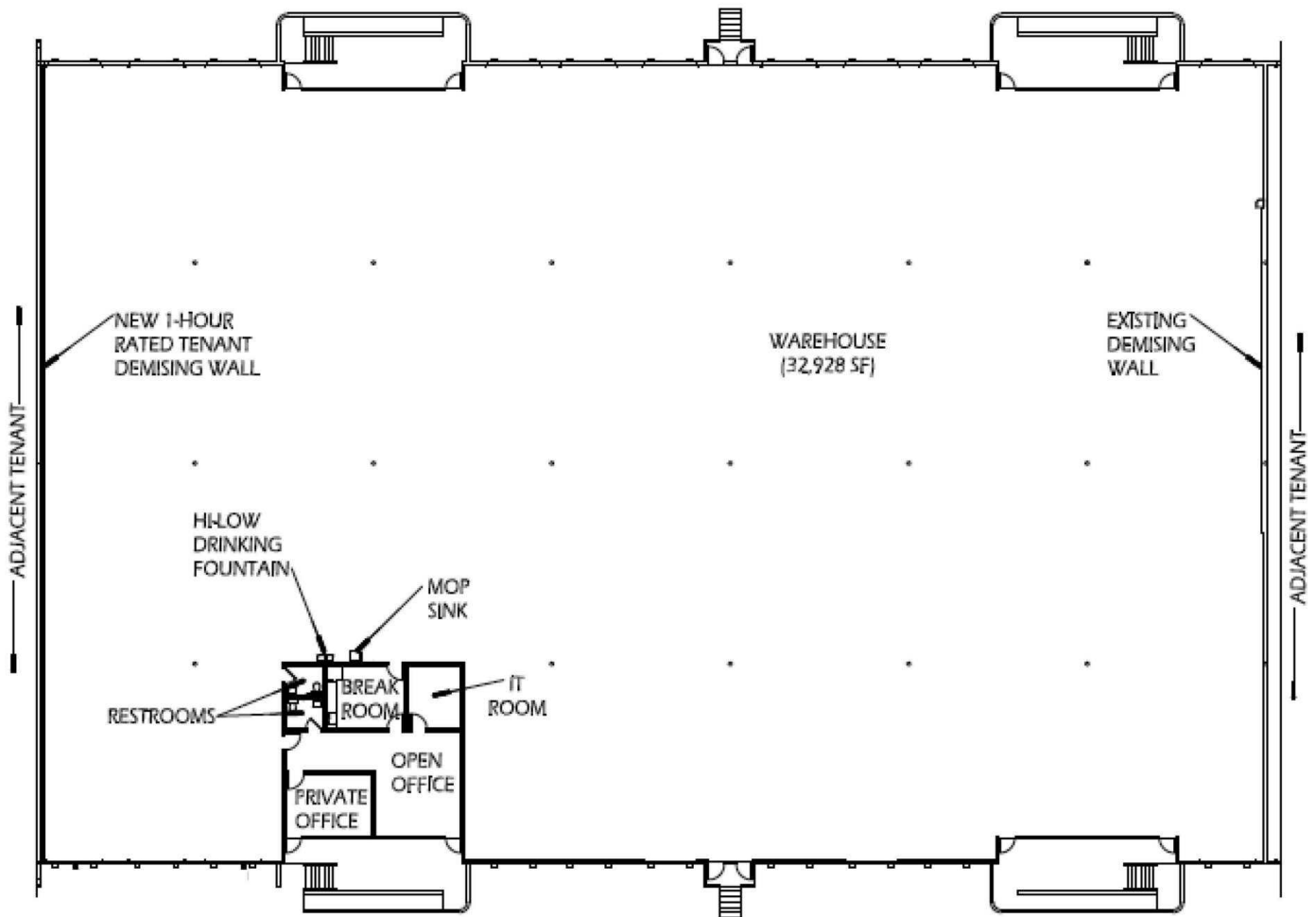

For Lease
15,000 - 34,000 SF
Industrial Space



For Lease
15,000 - 34,000 SF
Industrial Space

