

CONCEPTUAL SITE PLAN

PROPOSED 232,500 S.F. BUILDING

**PARCEL #4A-2
160 GREAT VALLEY BOULEVARD
HANOVER CROSSINGS BUSINESS PARK
HANOVER TOWNSHIP
WILKES-BARRE, PA 18706**

TRAILER STORAGE	62
VEHICULAR PARKING	199
FUTURE VEHICULAR PARKING	50
DOCK DOORS	30
DRIVE-IN DOORS	2
ACREAGE	26.06

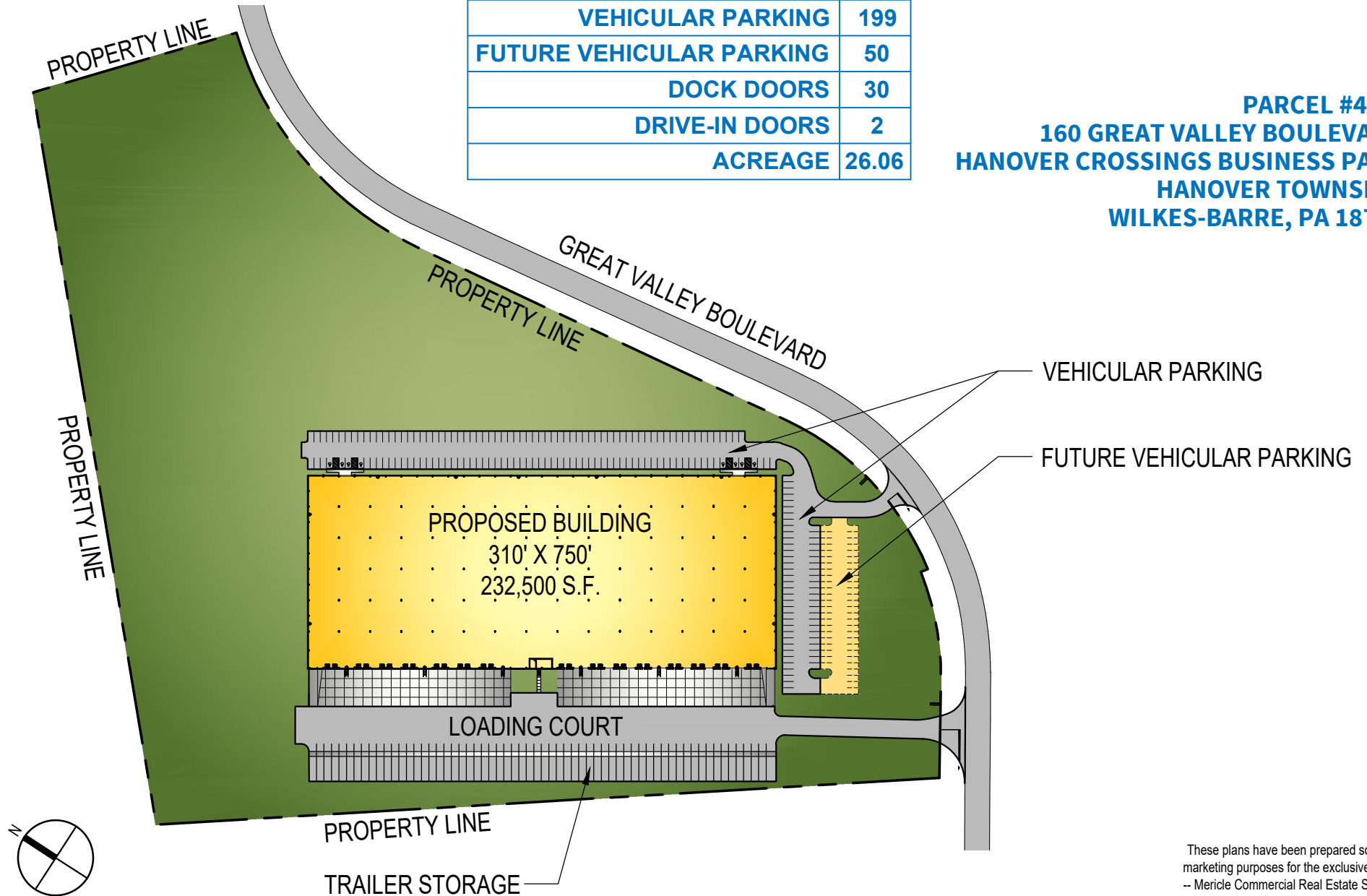

These plans have been prepared solely for marketing purposes for the exclusive use of -- Mericle Commercial Real Estate Services

Q:\Shared\Properties\HXC\160 Great Valley (4A-2) (J2628)\Base Bldg. (J2628)\2628\mdc\DWG-SPEC\mktg\J2628 - 160 GREAT VALLEY BOULEVARD (052824).dwg LD

570.823.1100



mericle.com



East Mountain Corporate Center
100 Baltimore Drive, Wilkes-Barre, PA 18702

WE BUILD BUILDINGS.
WE BUILD CAREERS.
WE BUILD COMMUNITIES.