

DOWNTOWN LOS ANGELES | CENTRAL BUSINESS DISTRICT
Retail/Office/Bank Space For Lease



800 Wilshire Blvd., Los Angeles, CA 90017

AVAILABLE

JUSTIN WEISS · 310.887.3450 · justin.weiss@kwprealestate.com · DRE #01920886
LEE SHAPIRO · 310.887.6226 · lee.shapiro@kwprealestate.com · DRE #00961769



DOWNTOWN LOS ANGELES | CENTRAL BUSINESS DISTRICT

Retail/Office/Bank Space For Lease



800 Wilshire Blvd., Los Angeles, CA 90017

AVAILABLE

- Size:** ±2,185 SF
- Rent:** \$3.50 PSF/Mo., NNN
- NNN:** ±\$1.25 PSF/Mo.
- Parking:** On-site valet parking for visitors

PROPERTY HIGHLIGHTS

- Newly built-out former bank space
- One block from mega project Wilshire Grand Tower and Intercontinental Hotel, the tallest building in Los Angeles
- Situated in the heart of the Central Business District but also within a 2-minute walk of the 5,000 residential units in the adjacent City West Neighborhood
- Convenient on-site valet parking
- Easy accessibility to the 110 Freeway
- High daily foot and vehicular traffic counts
- Within one block of the 7th Street Metro Station, LA's most active Metro hub
- Close proximity to numerous restaurants, bars and lounges in the Central Business District like Drago Centro, Bottega Louie, Delphi Hotel and 85 Degrees Bakery
- **Do not disturb existing tenant**

** Prospective tenants are hereby advised that all uses are subject to City approval*

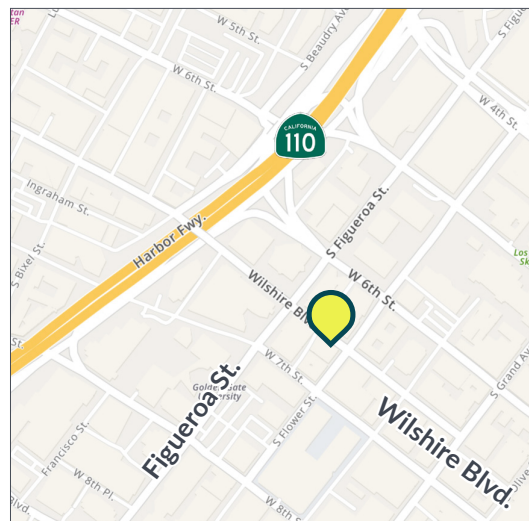

TRADE AREA



Retail/Office/Bank Space For Lease

800 Wilshire Blvd., Los Angeles, CA 90017

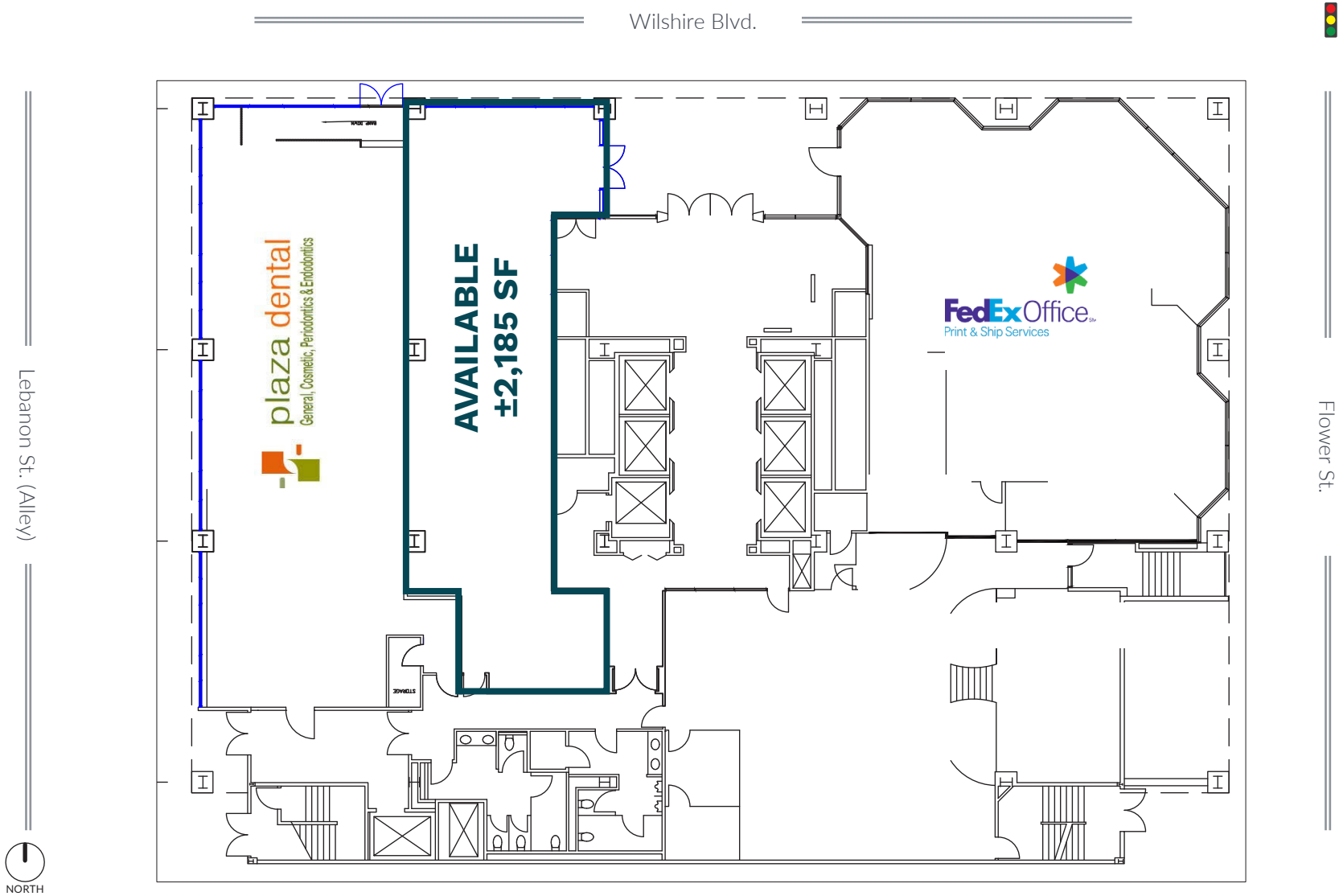

DOWNTOWN LOS ANGELES | CENTRAL BUSINESS DISTRICT

Retail/Office/Bank Space For Lease

800 Wilshire Blvd., Los Angeles, CA 90017



DOWNTOWN LOS ANGELES | CENTRAL BUSINESS DISTRICT
Retail/Office/Bank Space For Lease

800 Wilshire Blvd., Los Angeles, CA 90017



Retail/Office/Bank Space For Lease

800 Wilshire Blvd., Los Angeles, CA 90017

FIGAT7TH
 Bath & Body Works
 Gold's Gym
 H&M
 MAC
 Morton's
 Nordstrom Rack
 Target
 Victoria's Secret
 Zara

THE BLOC
 Alamo Drafthouse
 District Bar | Kitchen
 JOEY DTLA
 LA Fitness
 Macy's
 Sheraton Grand
 Uniqlo

LA LIVE
 Conga Room
 Fleming's
 Grammy Museum
 Katsuya
 Lucky Strike
 Rock'N Fish
 Rosa Mexicano
 Tom's Urban
 Wolfgang Puck
 Yard House



DOWNTOWN LOS ANGELES | CENTRAL BUSINESS DISTRICT

Retail/Office/Bank Space For Lease



800 Wilshire Blvd., Los Angeles, CA 90017

DTLA DEMOGRAPHICS

Live 80,000+ RESIDENTS

\$93,000

AVERAGE HHI

61%

25-54 YEARS OLD

67%

LOVE DTLA

90%

RESIDENTIAL OCCUPANCY

26%

RESIDENTIAL INVENTORY GROWTH SINCE 2010

41%

POPULATION GROWTH 2010-2022



67% POST
SECONDARY EDUCATION



46% WALK, BIKE,
OR TAKE TRANSIT TO
WORK

Work 288,000+ JOBS

\$95,000

AVERAGE HHI

61%

30-54 YEARS OLD

79%

EXPECT TO BE IN THE OFFICE AT LEAST HALF THE TIME

19%

JOB GROWTH IN "KNOWLEDGE INDUSTRIES"

19%

OF CITYWIDE JOBS



57% POST
SECONDARY EDUCATION



57% COMMUTE
LESS THAN 7 MILES
FROM THEIR HOME



Visit 17 MILLION VISITORS IN 2023

\$4.5 Billion

SPENT YEARLY

58%

HAVE VISITED GRAND CENTRAL MARKET

58%

HAVE VISITED ARTS DISTRICT

55%

HAVE VISITED LITTLE TOKYO

745

RETAIL BUSINESSES
PER SQUARE MILE



171 FOOD/BEVERAGE
BUSINESSES PER
SQUARE MILE



93 WALK SCORE



Source: DCBID Demographic Survey 2024



R E A L E S T A T E

JUSTIN WEISS

310-887-3450

Justin.Weiss@kwprealestate.com

DRE #01920886

LEE SHAPIRO

310-887-6226

Lee.Shapiro@kwprealestate.com

DRE #00961769

KWP Real Estate | 151 S. El Camino Drive, Beverly Hills, CA 90212 | 310-887-6400 | kwprealestate.com

KWP Real Estate (Responsible Broker Identity, DRE #00659610) makes no warranty or representation as to the accuracy of the information contained herein. Terms of sale or lease and availability of the property are subject to change or withdrawal without notice.