

CANTON CROSSING

1501 S Clinton Street
Baltimore, Maryland 21224



NEWMARK 301 Mission Blvd, Suite 1201, Baltimore, Maryland 21230 | nmrk.com

The information contained herein has been obtained from sources deemed reliable but has not been verified and no guarantee, warranty or representation, either express or implied, is made with respect to such information. Terms of sale or lease and availability are subject to change or withdrawal without notice.

 **COPT DEFENSE**
PROPERTIES

CANTON CROSSING

1501 S Clinton Street
Baltimore, Maryland 21224

PROPERTY HIGHLIGHTS

- Located off I-95 in the thriving community of Canton
- Breathtaking views of the Inner Harbor and Baltimore's stunning skyline
- Surrounded by an abundance of amenities including restaurants, retail, banking, and entertainment
- Owned and managed by Corporate Office Properties Trust



AVAILABILITY	2nd Floor	5,256 SF
	3rd Floor	22,077 SF
	4th Floor	22,052 SF
	11th Floor	15,112 SF

OCCUPANCY Immediate

PARKING Free 2.0/1,000 SF

For information, please contact:

Dan Callihan

Executive Managing Director

t 410-625-4213

dan.callihan@nrmk.com

James Cumber

Managing Director

t 410-625-4203

james.cumber@nrmk.com

NEWMARK

301 Mission Blvd, Suite 1201, Baltimore, Maryland 21230 | nrmk.com

 **COPT DEFENSE**
PROPERTIES

The information contained herein has been obtained from sources deemed reliable but has not been verified and no guarantee, warranty or representation, either express or implied, is made with respect to such information. Terms of sale or lease and availability are subject to change or withdrawal without notice.

CANTON CROSSING

1501 S Clinton Street
Baltimore, Maryland 21224

2nd Floor

Suite 220 - 5,256 SF

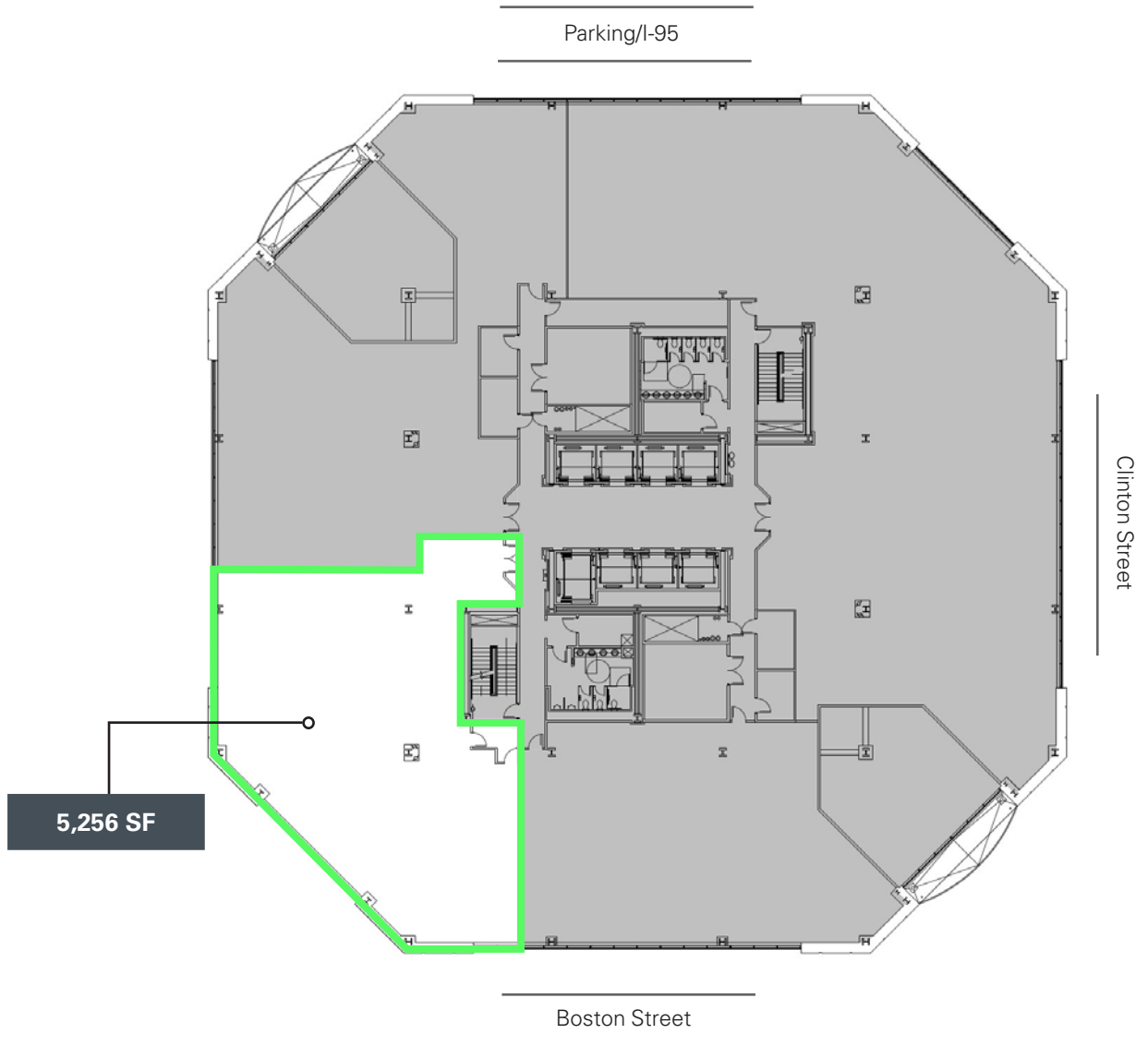

CANTON CROSSING

1501 S Clinton Street
Baltimore, Maryland 21224

3rd Floor

3rd Floor - Up to 22,077 SF



CANTON CROSSING

1501 S Clinton Street
Baltimore, Maryland 21224

4th Floor

4th Floor- Up to 22,052 SF



CANTON CROSSING

1501 S Clinton Street
Baltimore, Maryland 21224

11th Floor

Suite 1100- 15,112 SF



CANTON CROSSING

1501 S Clinton Street
Baltimore, Maryland 21224

For information, please contact:

Dan Callihan

Executive Managing Director

t 410-625-4213

dan.callihan@nmrk.com

James Cumber

Managing Director

t 410-625-4203

james.cumber@nmrk.com

NEWMARK



Newmark • 301 Mission Blvd, Suite 1201, Baltimore, Maryland 21230 | nmrk.com

The information contained herein has been obtained from sources deemed reliable but has not been verified and no guarantee, warranty or representation, either express or implied, is made with respect to such information. Terms of sale or lease and availability are subject to change or withdrawal without notice.