

FOR LEASE

±1,500 SF INDUSTRIAL UNIT

9710 Washburn Rd, Downey, CA 90241



PROPERTY HIGHLIGHTS

- Professional Business Park Environment
- Fully Refurbished Interior / Exterior
- ±250 SF Office
- Low CAM Fee - ±\$0.10 / SF / Month
- 200 Amps / 240 Volts / 3 Phase
- Ready for Immediate Occupancy
- Zoning: DOM2*
- One (1) GL Door - 10'x12'

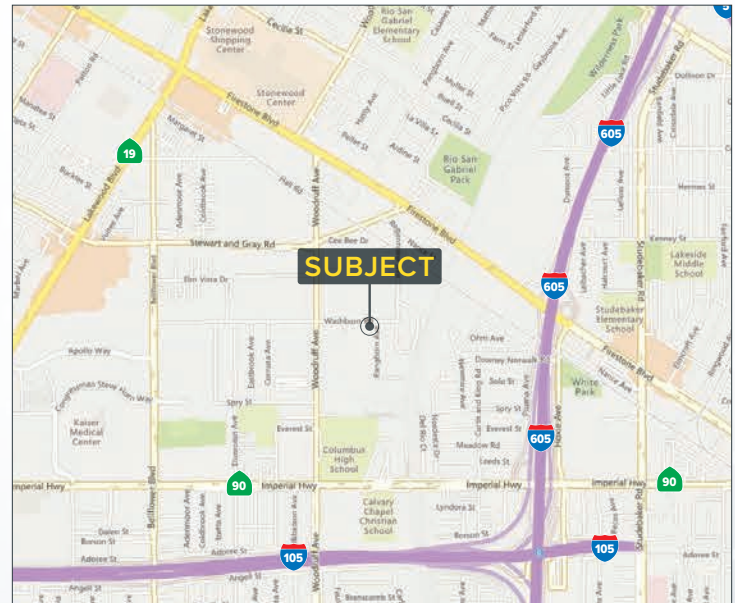

FOR MORE INFORMATION, PLEASE CONTACT

Gloria Jimenez

Associate | LIC NO 02229086

gjimenez@lee-associates.com
323.629.3464

Andy Gage

Vice President & Principal | LIC NO 02015991

agage@lee-associates.com
310.265.3773

LOCAL EXPERTISE. INTERNATIONAL REACH. WORLD CLASS.

The information contained herein is obtained from sources believed to be reliable. However, we have not verified it and make no guarantees, warranties or representations as to the completeness or accuracy thereof. The presentation of this property is used for example and is submitted subject to errors, omissions, change of price or conditions, and is subject to prior sale, lease or withdrawal without notice.

FOR LEASE

±1,500 SF INDUSTRIAL UNIT

9710 Washburn Rd, Downey, CA 90241

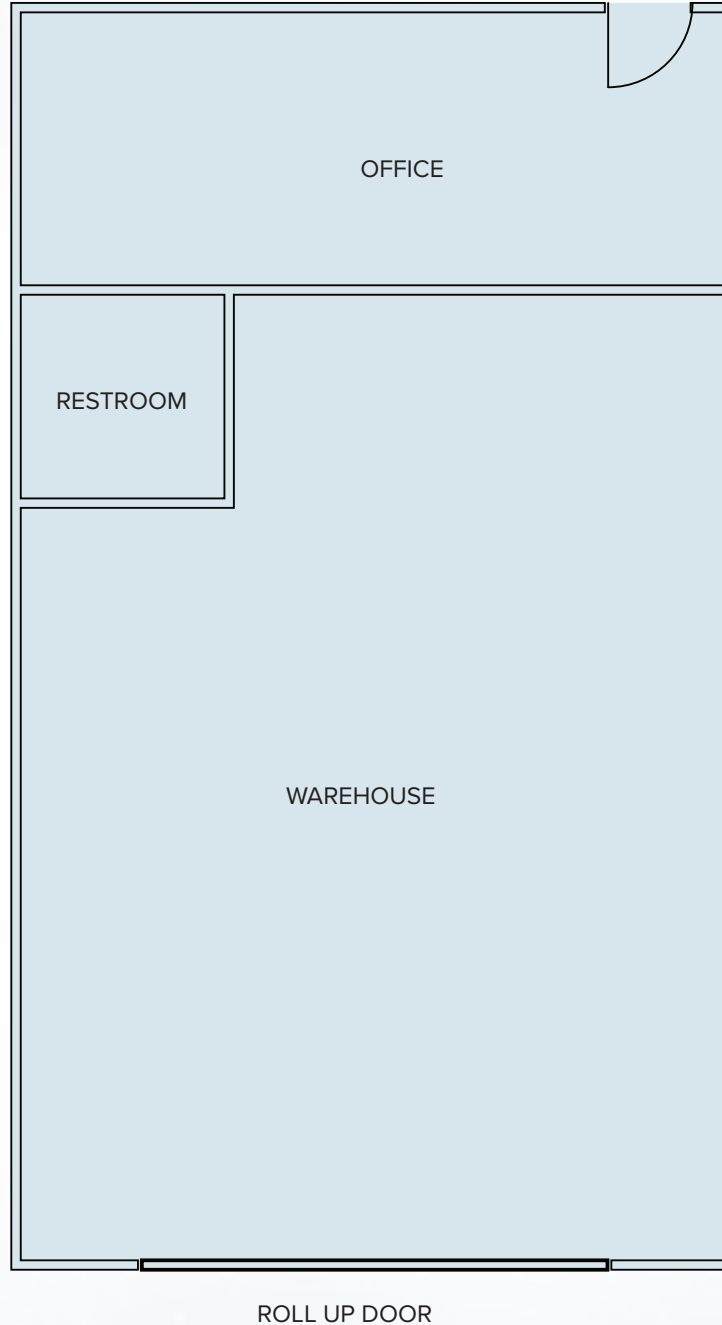

NOTE: Drawing not to scale. All measurements and sizes are approximate.

FOR MORE INFORMATION, PLEASE CONTACT

Gloria Jimenez

Associate | LIC NO 02229086

gjimenez@lee-associates.com

323.629.3464

Andy Gage

Vice President & Principal | LIC NO 02015991

agage@lee-associates.com

310.265.3773

LOCAL EXPERTISE. INTERNATIONAL REACH. WORLD CLASS.

The information contained herein is obtained from sources believed to be reliable. However, we have not verified it and make no guarantees, warranties or representations as to the completeness or accuracy thereof. The presentation of this property is used for example and is submitted subject to errors, omissions, change of price or conditions, and is subject to prior sale, lease or withdrawal without notice.