

# SAN MATEO SCIENCE CENTER

Class A Lab Space in the Heart of the Peninsula



MARINERS ISLAND BLVD

# 951 / Floor 5

Single Tenant Floor Plan

± 20,000 Square Feet

75% Office / 25% R&D



- Reception/All Hands: 1
- Boardroom: 1
- Small Conference Rooms: 1
- Office: 1
- Office/Huddle: 3
- Phone Rooms: 2
- Open Break Area: 1
- Pantry: 1
- Support Areas: 2
- Collaboration: 2
- Benching Stations: 89
- Tech/AI/R&D: 1

± 4,700 SF TECH/AI/R&D

± 15,300 SF OFFICE

**Bill Benton**  
 Vice Chairman  
 415 274 4421  
 bill.benton@nmrk.com  
 Lic. #01247617

**Eric Bluestein**  
 Executive Managing Director  
 650 688 8547  
 eric.bluestein@nmrk.com  
 Lic. #01720416

**John Kraft**  
 Managing Director  
 650 358 5277  
 john.kraft@nmrk.com  
 Lic. #01787698

**Neill Sherron**  
 Partner, Portfolio Leasing  
 919 414 0320  
 nsherron@lfp.com



MARINERS ISLAND BLVD

# 951 / Floor 5

Single Tenant Floor Plan

± 20,000 Square Feet

60% Office / 40% R&D



- Reception/All Hands: 1
- Boardroom: 1
- Small Conference Rooms: 1
- Offices: 3
- Office/Huddle: 1
- Phone Rooms: 2
- Open Break Area: 1
- Pantry: 1
- Support Area: 1
- Collaboration: 2
- Benching Stations: 57
- Tech/AI/R&D: 1

± 6,450 SF TECH/AI/R&D

± 13,550 SF OFFICE

**Bill Benton**  
Vice Chairman  
415 274 4421  
bill.benton@nmrk.com  
Lic. #01247617

**Eric Bluestein**  
Executive Managing Director  
650 688 8547  
eric.bluestein@nmrk.com  
Lic. #01720416

**John Kraft**  
Managing Director  
650 358 5277  
john.kraft@nmrk.com  
Lic. #01787698

**Neill Sherron**  
Partner, Portfolio Leasing  
919 414 0320  
nsherron@lfrp.com



MARINERS ISLAND BLVD

# 951 / Floor 5

Single Tenant Floor Plan

± 20,000 Square Feet

100% Office

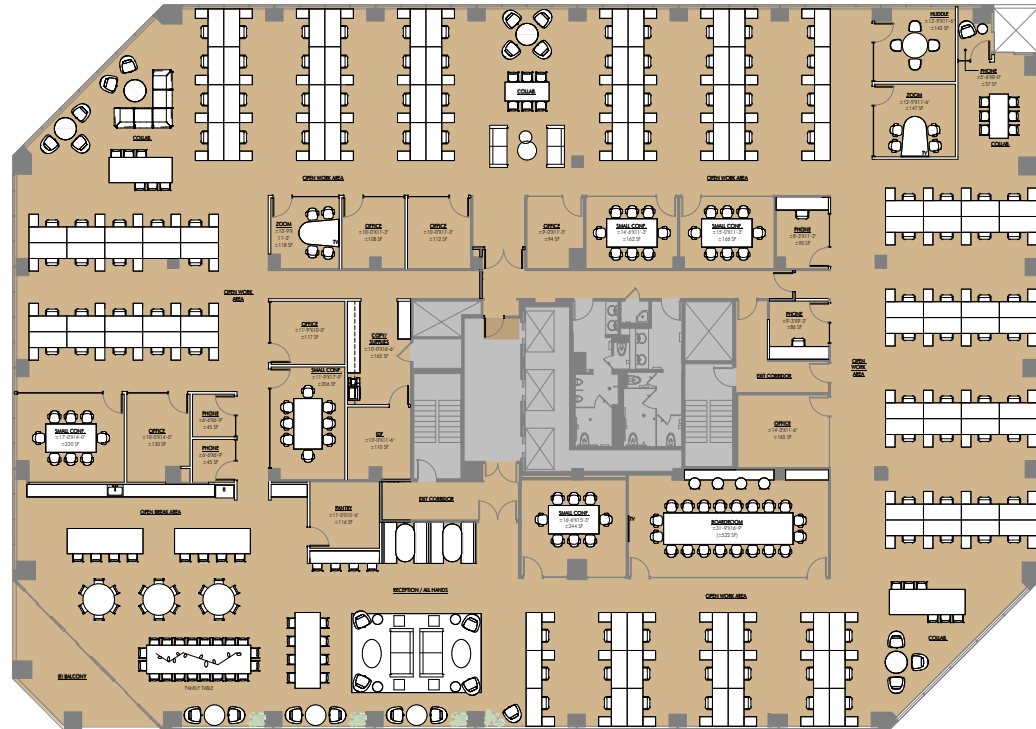

Reception / All Hands: 1

Boardroom: 1

Small Conference Rooms: 5

Offices: 6

Huddle Room: 1

Zoom Rooms: 2

Phone Rooms: 5

Open Break Area: 1

Pantry: 1

Collaboration: 4

Copy/Supplies: 1

IDF: 1

Benching Stations: 116

±20,000 SF OFFICE

**Bill Benton**

Vice Chairman  
415 274 4421  
bill.benton@nrmk.com  
Lic. #01247617

**Eric Bluestein**

Executive Managing Director  
650 688 8547  
eric.bluestein@nrmk.com  
Lic. #01720416

**John Kraft**

Managing Director  
650 358 5277  
john.kraft@nrmk.com  
Lic. #01787698

**Neill Sherron**

Partner, Portfolio Leasing  
919 414 0320  
nsherron@lfrp.com





# NEWMARK

**JOHN KRAFT**

Managing Director  
650 358 5277  
john.kraft@nmrk.com  
Lic. #01787698

**ERIC BLUESTEIN**

Executive Managing Director  
650 688 8547  
eric.bluestein@nmrk.com  
Lic. #01720416

**BILL BENTON**

Vice Chairman  
415 274 4421  
bill.benton@nmrk.com  
Lic. #01247617

**COLIN KLOEZEMAN**

Associate  
650 688 8532  
colin.kloezeman@nmrk.com  
Lic. #02210827

**NEILL SHERRON**

Partner, Portfolio Leasing  
919 414 0320  
nsherron@lfrep.com

Procuring broker shall only be entitled to a commission, calculated in accordance with the rates approved by our principal only if such procuring broker executes a brokerage agreement acceptable to us and our principal and the conditions as set forth in the brokerage agreement are fully and unconditionally satisfied. Although all information furnished regarding property for sale, rental, or financing is from sources deemed reliable, such information has not been verified and no express representation is made nor is any to be implied as to the accuracy thereof and it is submitted subject to errors, omissions, change of price, rental or other conditions, prior sale, lease or financing, or withdrawal without notice and to any special conditions imposed by our principal.