

1 PLUMBING PLAN
P.201 3/16"= 1'-0"

KEYNOTES

- ① CONTRACTOR SHALL MODIFY AND RELOCATE SPRINKLER HEADS IN THE AREAS OF WORK AS NECESSARY FOR THE NEW SPACE CONFIGURATIONS. REFER TO FIRE PROTECTION NOTES ON DRAWING P.001.
- ② CONNECT SANITARY TO EXISTING RISER IN CORE AREA AT RESTROOMS OR WET STACK. CONTRACTOR SHALL COORDINATE ROUTING IN CEILING BELOW SO AS TO BOTH MAINTAIN PROPER SLOPE AND NOT DISRUPT EXISTING DRYWALL CEILINGS. COORDINATE WITH BUILDING OWNER.
- ③ CONNECT NEW WATER LINE TO EXISTING COLD WATER PIPING ABOVE CEILING WITHIN CORE AREA AT TOILET ROOM OR WET STACK, OR TO EXISTING 1" LINE FOR EXISTING PANTRY. COORDINATE LOCATIONS IN FIELD. PROVIDE WITH SHUT-OFF VALVE.
- ④ CONNECT NEW VENT PIPING ABOVE CEILING TO EXISTING VENT PIPING IN CORE OR ADJACENT PANTRY COORDINATE LOCATIONS IN FIELD.
- ⑤ PROVIDE WATER HEATER ABOVE RESTROOM CEILING ON PLATFORM/SHELF SUPPORT WITH WALLS OF THE RESTROOM. PROVIDE 1" DRAIN FROM WATER HEATER DRAIN PAN TO SPILL INTO MOP BASIN. REFER TO DETAIL ON DRAWINGS.
- ⑥ PROVIDE WATER LINE WITH BACKFLOW PREVENTOR (WATTS SERIES NUMBER LF7C ASSE 1024) TO REFRIGERATOR. MOUNT IN RECESSED WATER VALVE BOX (GUY GREY) ON WALL. LOCATE PREVENTOR IN ACCESSIBLE LOCATION ABOVE CEILING. COORDINATE LOCATION OF WATER BOX IN FIELD.
- ⑦ COORDINATE LOCATION OF FLOOR DRAIN WITH ARCHITECT.

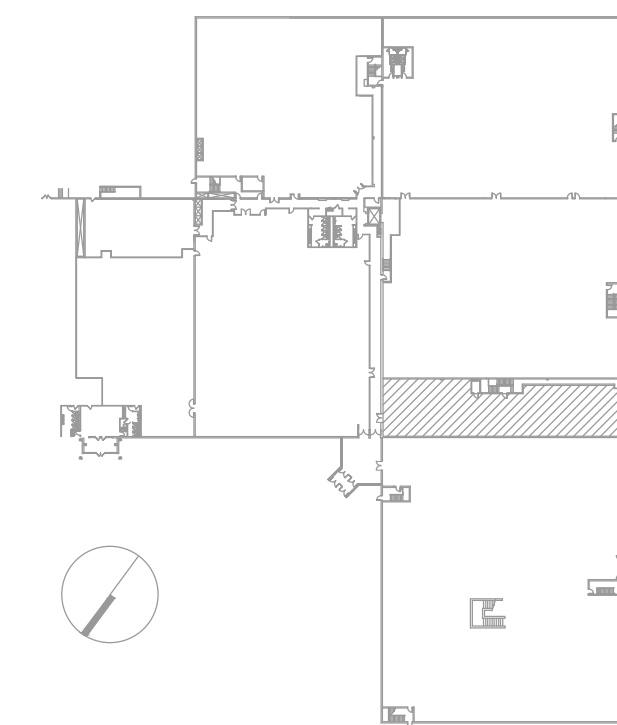

KEY PLAN:

ALL DESIGN, PLANS, SPECIFICATIONS, AND/OR DETAILS SHOWN ON THIS SHEET ARE THE PROPERTY OF KOGUT ARCHITECTS LLC. COPYRIGHT, COMMON LAW COPYRIGHT AND ALL OTHER APPLICABLE PROPERTY RIGHTS ARE HEREBY RESERVED FOR KOGUT ARCHITECTS LLC. NO PART OF THIS SHEET IS TO BE REPRODUCED, CHANGED, COPIED OR USED IN ANY FORM WITHOUT WRITTEN PERMISSION FROM KOGUT ARCHITECTS LLC.

Kogut Architects • LLC
8600 Foundry Street - Suite 302 - Savage, Maryland 20763
Ph: 301.490.9066

CONSULTANTS
aspire engineering
9401 LEE HIGHWAY
SUITE 410
FAIRFAX, VIRGINIA 22031
703.539.8711
INFO@ASPIREENG.COM

INTERIOR RENOVATIONS FOR CHRIST EMBASSY
11800 TECH ROAD, SUITE 0240
SILVER SPRING, MARYLAND 20904

DRAWN BY: VC/JS		DATE: 07 / 02 / 2018	REVISION NO.	DATE
			PERMIT SET	07 / 02 / 2018

PLUMBING PLAN

I CERTIFY THAT THESE DRAWINGS WERE PREPARED OR APPROVED BY ME AND THAT I AM A DULY LICENSED ENGINEER UNDER THE LAWS OF THE STATE OF MARYLAND
LICENSE NO. _____ EXPIRATION DATE: 3/15/2019

P.201

JOB NUMBER:
18-07