

QEII Wash Bay & Warehouse Building

9,841 SF with Available Yard Space

3925 - 8th Street
Nisku, Alberta

Excellent Opportunity for Users Requiring Excess Yard



Wash Bay /
Warehouse
Building
9,841 SF

8 Street

QEII Wash Bay / Warehouse Building

3925 - 8th Street | Nisku, Alberta



The Opportunity

Overall Property Highlights

This wash bay / warehouse building features three grade level doors with the opportunity for drive-thru access, 27' clear ceiling height, and LED lighting.

The yard is prepared with the ability to withstand high traffic and heavy loads.

Legal Address	Plan 8420145; Block 1; Lot 1
Zoning	IND - Industrial
Building Size	9,841 sq. ft.
Sub-Building 4 Size	4,016 sq. ft. (Excluded from GLA)
Servicing	Fully serviced
Yard Space	Available
Op Costs	TBD
Lease Rate	Starting at \$15.00 / sq. ft.

Wash Bay / Warehouse Building

Property Highlights

- + Was formerly utilized as a wash area with warehouse storage
- + Shared site access with the main building

Building Details

Year Built	1998
Loading Doors	(1) 19' x 24' Grade (1) 18' x 18' Grade (1) 20' x 26' Grade - potential for drive-thru
Construction	Pre-engineered steel
Ceiling Height	27' Clear
Power	600 amp, 600 volt <i>*To be confirmed</i>
Heating	Forced air gas fired units & in-floor heating
Lighting	LED
Sprinklers	Yes
Sumps	Yes

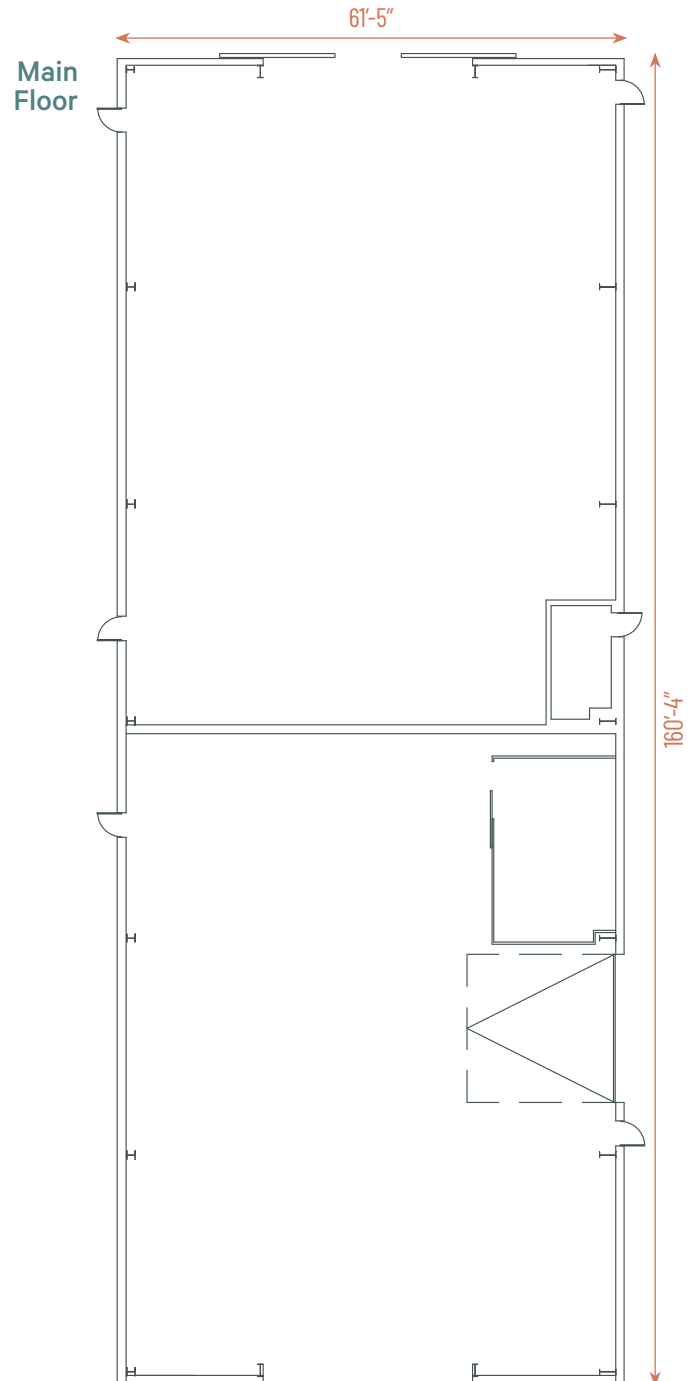

QEII Wash Bay / Warehouse Building

3925 - 8th Street | Nisku, Alberta

Contact Us

Kevin Hughes

Senior Vice President
+1 780 917 4634
kevin.hughes@cbre.com

*Lead Broker

Gregg Maimann

Senior Vice President
+1 780 917 4632
gregg.maimann@cbre.com

*Lead Broker

Trevor Schmidt

Vice President
+1 780 917 4641
trevor.schmidt@cbre.com

Jordan Adams

Vice President
+1 780 917 4645
jordan.adams@cbre.com

*Lead Broker

Braylon Klemchuk

Vice President
+1 780 229 4687
braylon.klemchuk@cbre.com

*Lead Broker

Jay Olmstead

Sales Representative
+1 780 554 1191
jay.olmstead@cbre.com

John Allan McKay

Associate
+1 780 915 5020
johnallan.mckay@cbre.com

Lucas Neumeyer

Associate
+1 780 850 2267
lucas.neumeyer@cbre.com



*(Sub) Tenant / Purchaser is responsible to confirm the electrical service to the premises / building and ensure it is sufficient for their intended use.

This disclaimer shall apply to CBRE Limited, Real Estate Brokerage, and to all other divisions of the Corporation; to include all employees and independent contractors ("CBRE"). The information set out herein, including, without limitation, any projections, images, opinions, assumptions and estimates obtained from third parties (the "Information") has not been verified by CBRE, and CBRE does not represent, warrant or guarantee the accuracy, correctness and completeness of the Information. CBRE does not accept or assume any responsibility or liability, direct or consequential, for the Information or the recipient's reliance upon the Information. The recipient of the Information should take such steps as the recipient may deem necessary to verify the Information prior to placing any reliance upon the Information. The Information may change and any property described in the Information may be withdrawn from the market at any time without notice or obligation to the recipient from CBRE. CBRE and the CBRE logo are the service marks of CBRE Limited and/or its affiliated or related companies in other countries. All other marks displayed on this document are the property of their respective owners. All Rights Reserved.

www.cbre.ca



41 Business Park
Existing Building 1:
366,932 SF
Future Building 2:
302,156 SF
Q2 2026

SITE

Southport Crossing

Border Business Park

QEII Business Park

Monarch Business Park

30 Ave

20 Ave

Nisku

Edmonton International Airport

Airport Rd

Nearby Employee Services

① South Edmonton Common

② Variety of Hotel Options