

59-17

JUNCTION BOULEVARD,
Rego Park, NY 11373

LEFRAK CITY
FORMER STARBUCKS
LOCATION

±2,500 SF
Retail Space Available

CONTACT

MITZI FLEXER
+1 212 593 7124
mflexer@bradfordallen.com

GARETT VARRICCHIO
+1 212 841 5056
garett.varricchio@cushwake.com

MICHAEL LEARY
+1 718 575 4669
mleary@lefrakcommercial.com



SPACE OVERVIEW

CONDITION:	Delivered fully demolished
OVERALL IMPRESSION:	Space shows extremely well and is move-in ready for build-out
COLUMNS:	Minimal
CEILING HEIGHTS	<ul style="list-style-type: none"> • Lowest point: 8'11" • Midpoint: 11'10" • Highest point: 15'9"
FRONTAGE	Approximately 22 feet

BUILDING SYSTEMS

- HVAC: Distributed throughout the space
- Venting: Not vented
- Plumbing: Drain and water lines in place
- Sprinklers: Fully installed

RESTROOMS

- Two ADA-compliant restrooms

PARKING

- On-site, indoor paid parking garage immediately adjacent to the building

BUILDING & TENANCY

The space is located at the base of the LeFrak City Plaza, home to several major institutional tenants, including:

- New York City Police Department
- NYC Department of Environmental Protection
- NYC Health + Hospitals
- Con Edison

DEMOGRAPHICS (2025)

	0.5 Mile	1 Mile	3 Miles
Population	54,871	146,031	735,229
Median HH Income	\$74,142	\$76,586	\$78,072
Average HH Income	\$99,582	\$102,727	\$107,350

2025 AVERAGES	
Daily Visitors	650
Weekly Visitors	4,500
Monthly Visitors	19,700

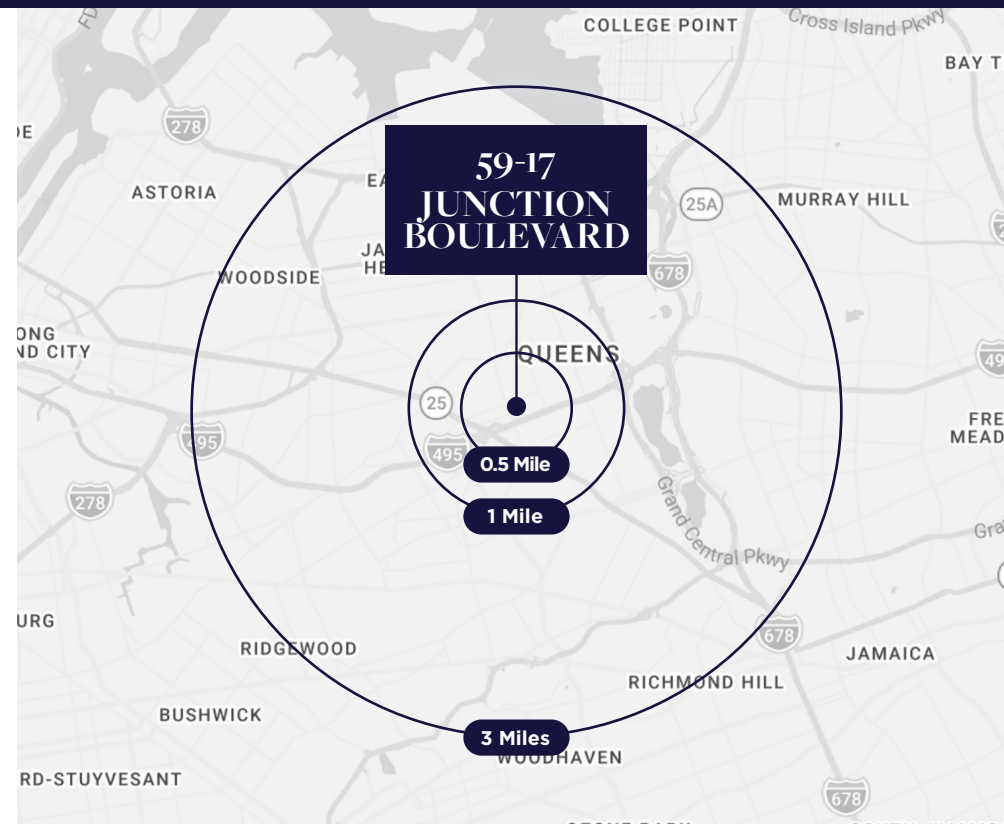

FLOOR PLAN

1ST FLOOR

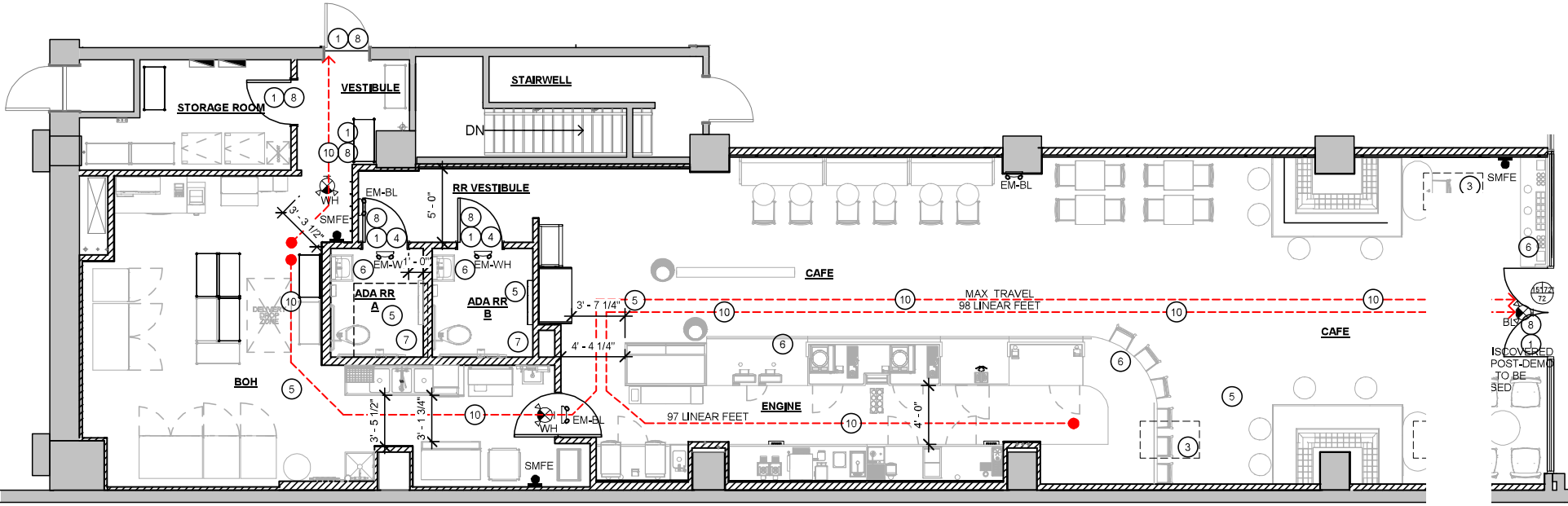



CONTACT

Mitzi Flexer
 +1 212 593 7124
 mflexer@bradfordallen.com

Garett Varricchio
 +1 212 841 5056
 garett.varricchio@cushwake.com

Michael Leary
 +1 718 575 4669
 mleary@lefrakcommercial.com

